

LONDON BOROUGH OF HILLINGDON
SECTION 23 OF THE ROAD TRAFFIC REGULATION ACT 1984

Hillingdon Council gives notice that it proposes to **install a zebra crossing and parallel tiger crossing on Field Heath Road, Hillingdon approximately 143 metres east of the junction with The Meads**. A copy of the notice of proposals together with full details, a plan and the Council's statement of reasons for the proposals can be sent upon request or viewed online at <https://www.hillingdon.gov.uk/improvement-schemes> until 3rd January 2024. Further information can be obtained by email parkingmanagementschemes@hillington.gov.uk . If you wish to comment on these proposals please write or email by 3rd January 2024, providing your home address to Transport & Projects, 3N/04 Civic Centre, Uxbridge, Middlesex UB8 1UW quoting reference 3N/04/13/12/23.

Dated this the 13th day of December 2023.

PERRY SCOTT,
Corporate Director of Place

STATEMENT OF REASONS

The proposed installation of zebra crossing and tiger crossings are intended to improve & promote road safety as well as allow a new cycle route to be brought forward. All proposals have been agreed in principle by the Cabinet Member for Property, Highway and Transport to proceed to formal consultation.

Sign Schedule (Sheet 1)						
Sign Ref No.	Traffic Sign	TSRGD Ref	Quantity	Sign Details	Post(s) & Foundation	Comments
EX01		528	1	Existing Sign	N/A	Sign to be retained, see comment
EX02-1		Street name plate	1	Existing Sign	N/A	Relocate existing sign ref. no. EX02-1, EX02-2, EX02-3 with post to the back of footway as shown
EX02-2		Directional sign	1	Existing Sign	N/A	Relocate existing sign ref. no. EX02-1, EX02-2, EX02-3 with post to the back of footway as shown
EX02-3		Directional sign	1	Existing Sign	As above	Relocate existing sign ref. no. EX02-1, EX02-2, EX02-3 with post to the back of footway as shown

NS01		956	1	New Sign	Ensign Bollard or similar	Sign to be mounted back to be back on bollard at location as indicated.
NS02		951	1	New Sign	Ensign Bollard or similar	Sign to be mounted back to back on bollard at location as indicated.
NS03		956	1	New Sign	Mounted on existing post	Sign to be mounted back to back onto existing sign post as indicated.
NS04		951	1	New Sign	Mounted on existing post	Sign to be mounted back to back onto existing sign post as indicated.
NS05		Street name plate	1	New Sign	Post: 76mm Ø post x 2 Foundation: W600mm, L600mm, D600mm	Contractor to provide new replacement sign and mount onto 2 x new post. See comments

KEY

- Existing footway
- New shared path:
Excavate to a maximum depth of 180mm
New Construction:
100mm Type 1 Sub-base
50mm AC32 Dense Base 40/60
20mm AC6 Dense Base 100/150
- Corduroy paving
- Tactile Paving
- Dropped Kerb locations
- Existing sign and post
- Proposed sign and post
- Belisha Beacon S14.2.27 (Dia 4007)
- Existing kerb-inlet Gully

PARALLEL CROSSING TO BE INSTALLED IN ACCORDANCE WITH THE TRAFFIC REGULATIONS AND GENERAL DIRECTIONS (TSRGD) 2016 S14.2.53 (Dia 1001.5)



- NOTES**
- All signs and road marking locations shown are approximate and must be agreed with the site supervisor prior to installation.
 - All signs and markings are to be in accordance with the Traffic Regulations and General directions (TSRGD) 2016
 - Existing continuous double yellow line to be removed within the extents of the parallel crossing shown.
 - All dimensions are meters unless otherwise stated.
 - Do not scale from this drawing

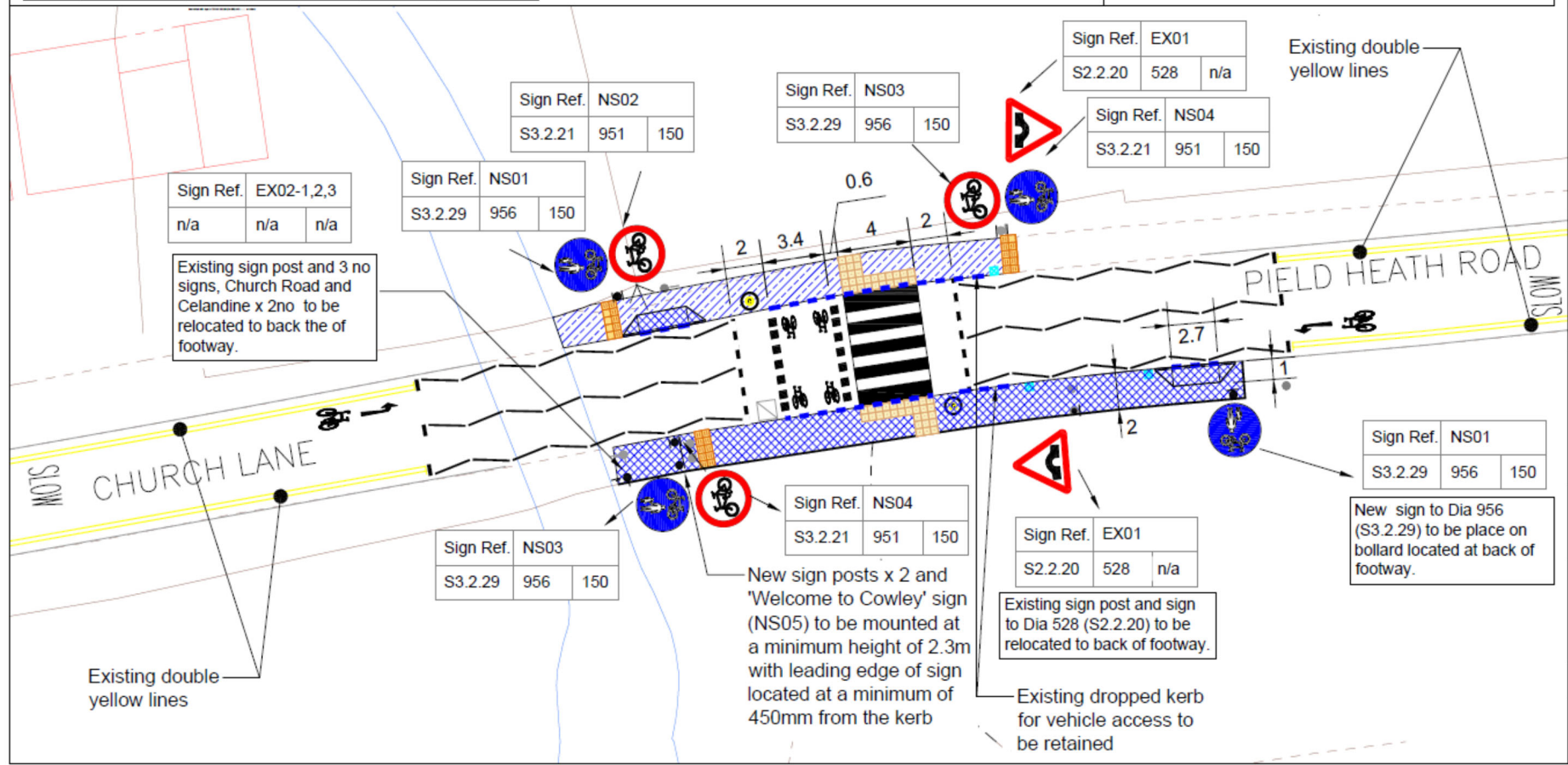

Revision			
<p>This map is based upon Ordnance Survey Survey material with the permission of Ordnance Survey on behalf of the Controller of Her Majesty's Stationary Office. © Crown copyright. Unauthorised reproduction infringes Crown copyright and may lead to prosecution or civil proceedings. London Borough of Hillingdon 100019283 2009</p>			
<p>HILLINGDON LONDON</p> <p>IMPROVEMENT PROJECTS ENVIRONMENT AND CONSUMER PROTECTION GROUP 114C CENTRE 4th/5th, HIGH STREET, UXBRIDGE, URB 11W TM No. 01895 250111 Fax No 01895 250676</p>			
Project			
Field Heath Road			
Description			
Parallel Crossing			
Detailed Design			
Scale	Designed	Drawn	Date
NTS	SC	SC	11/10/2023
Project No.	Drawing No.	Rev.	
E/A3/88621	001	REV	