

LONDON BOROUGH OF HILLINGDON

THE HILLINGDON (ON STREET PARKING PLACES) (NORTHWOOD HILLS PARKING MANAGEMENT SCHEME) NWH & JS(B) ZONES ORDER 2022 (AMENDMENT) ORDER 2024
THE HILLINGDON (ON STREET PARKING PLACES) (WEST DRAYTON) (RESIDENTS) WD ZONES ORDER 2022 (AMENDMENT) ORDER 2024

THE HILLINGDON (ON STREET PARKING PLACES) (COWLEY PARKING MANAGEMENT SCHEME) C ZONES (NO. 2) ORDER 2022 (AMENDMENT) ORDER 2024

THE HILLINGDON (ON-STREET PARKING PLACES) (WEST RUISLIP) (RESIDENTS ZONES WR1 & WR2) ORDER 2021 (AMENDMENT) ORDER 2024

THE HILLINGDON (WAITING & LOADING RESTRICTIONS) ORDER 2023 (AMENDMENT) ORDER 2024

THE HILLINGDON (ON STREET PARKING PLACES) (SOUTH RUISLIP PARKING MANAGEMENT SCHEME) SR ZONES ORDER 2022 (AMENDMENT) ORDER 2024

THE HILLINGDON (ON STREET PARKING PLACES) (NORTHWOOD PARKING MANAGEMENT SCHEME) N ZONES ORDER 2023 (AMENDMENT) ORDER 2024

Hillingdon Council gives notice that it proposes to make these Orders to:

1. Remove the following sections of permit holder parking places to facilitate the installation of new vehicle crossings:

- i) Remove a section of the Zone NWH parking place outside No. 60 Briarwood Drive, Northwood Hills and replace with 'Monday to Friday 1pm to 2pm' waiting restrictions.
- ii) Remove the entire Zone C1 parking place outside No. 57 Dellfield Crescent, Cowley and replace with 'Monday to Friday 9am to 5pm' waiting restrictions.
- iii) Remove a section of Zone WD5 parking place outside No. 12 Old Farm Road, West Drayton and replace with 'Monday to Friday 9am to 5pm' waiting restrictions.
- iv) Remove a section of Zone WR1 parking place outside No. 62 Ickenham Close, Ruislip and replace with 'at any time' waiting restrictions.
- v) Remove a section of Zone SR parking place outside No. 43 South Park Way, Ruislip and replace with 'Monday to Friday 9am to 5pm' waiting restrictions.
- vi) Remove a section of Zone SR parking place outside No. 19 Canfield Drive, Ruislip and replace with 'Monday to Friday 9am to 5pm' waiting restrictions.
- vii) Remove a section of Zone N parking place outside No. 16 Murray Road, Northwood and replace with 'Monday to Friday 1pm to 2pm' waiting restrictions.

2. Replace the existing 'Monday to Friday 9.30am to 10.30am and 3.30pm to 4.30pm' waiting restrictions outside Nos. 45 to 47 Haslam Close, Ruislip with 'at any time' waiting restrictions.

Copies of the notice of proposals, proposed Orders together with full details, plans and the Council's statement of reasons for the proposal can be sent upon request or viewed online at <https://www.hillingdon.gov.uk/improvement-schemes> until 14th February 2024. Further information can be obtained by email parkingmanagementschemes@hillingdon.gov.uk. If you wish to comment on, or object to the proposals please write or email by 14th February 2024, stating grounds for objection and your home address to Transport & Projects, Place Directorate, Civic Centre, Uxbridge, Middlesex UB8 1UW quoting reference 3N/04/24/01/24.

Dated this the 24th day of January 2024.

DAVID KNOWLES,
Head of Transport & Town Centre Projects

STATEMENT OF REASONS

To facilitate the installation of new or extended vehicle crossings, it proposed to remove sections of permit holder parking places at various locations and replace them with waiting restrictions.

To facilitate the installation of an extended vehicle crossing outside Nos. 45 to 47 Haslam Close, Ruislip it proposed to replace the existing limited time waiting restrictions with 'at any time' waiting restrictions to negate the need for any upright signage.

Proposed removal of part of the Zone NWH parking place outside No. 60 Briarwood Drive, Northwood Hills

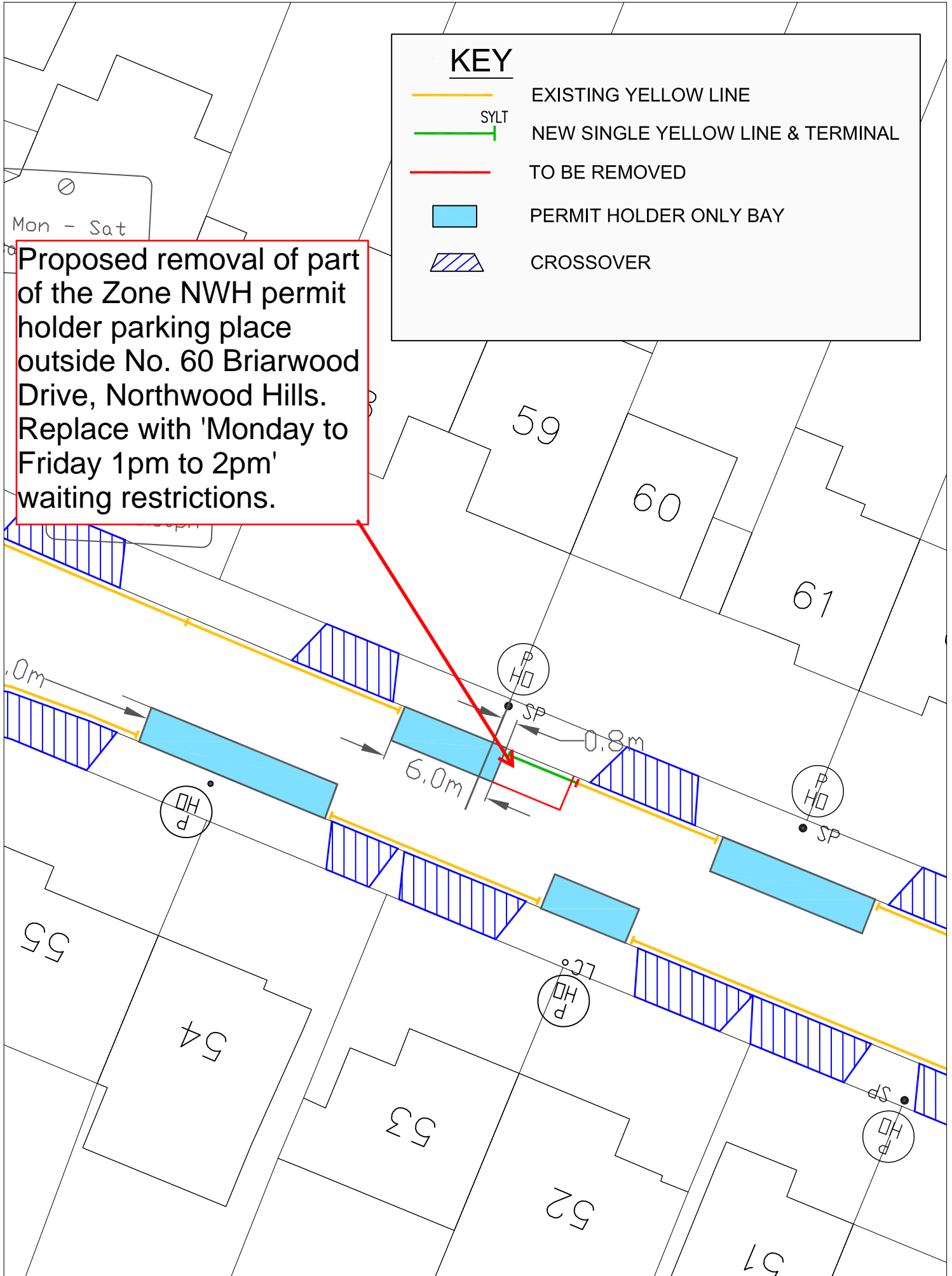

No. 57 Dellfield Crescent, Cowley - Amendments to accommodate a new vehicle crossing

Proposed removal of the Zone C1 permit holder parking place outside No. 57 Dellfield Crescent, Cowley. Replace with 'Monday to Friday 9am to 5pm' waiting restrictions.

KEY

- EXISTING YELLOW LINE
- NEW SINGLE YELLOW LINE & TERMINAL
- TO BE REMOVED
- PERMIT HOLDER ONLY BAY
- CROSSOVER

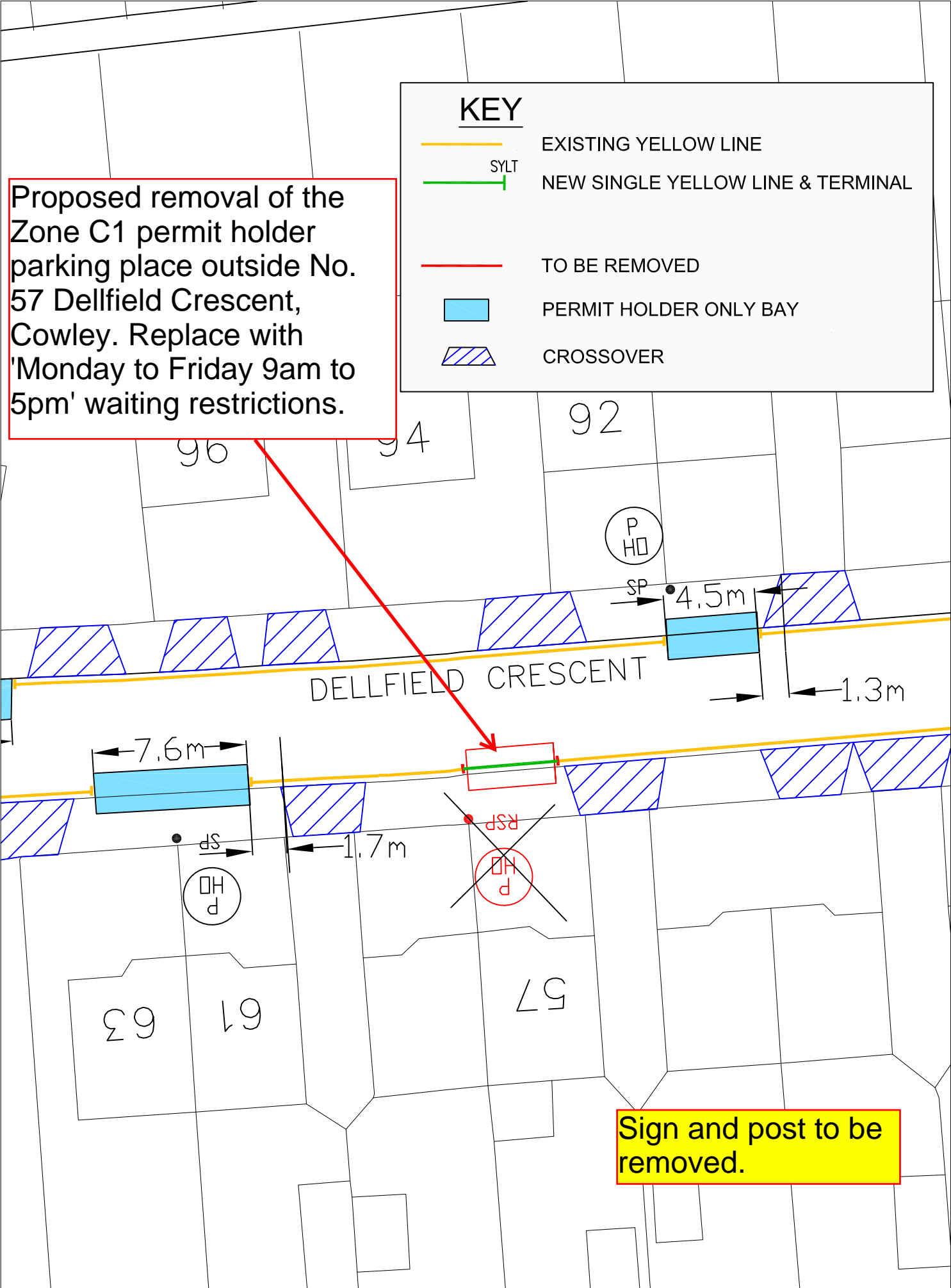

Sign and post to be removed.

12 Old Farm Road, West Drayton

Proposed amendments for a new vehicle crossing

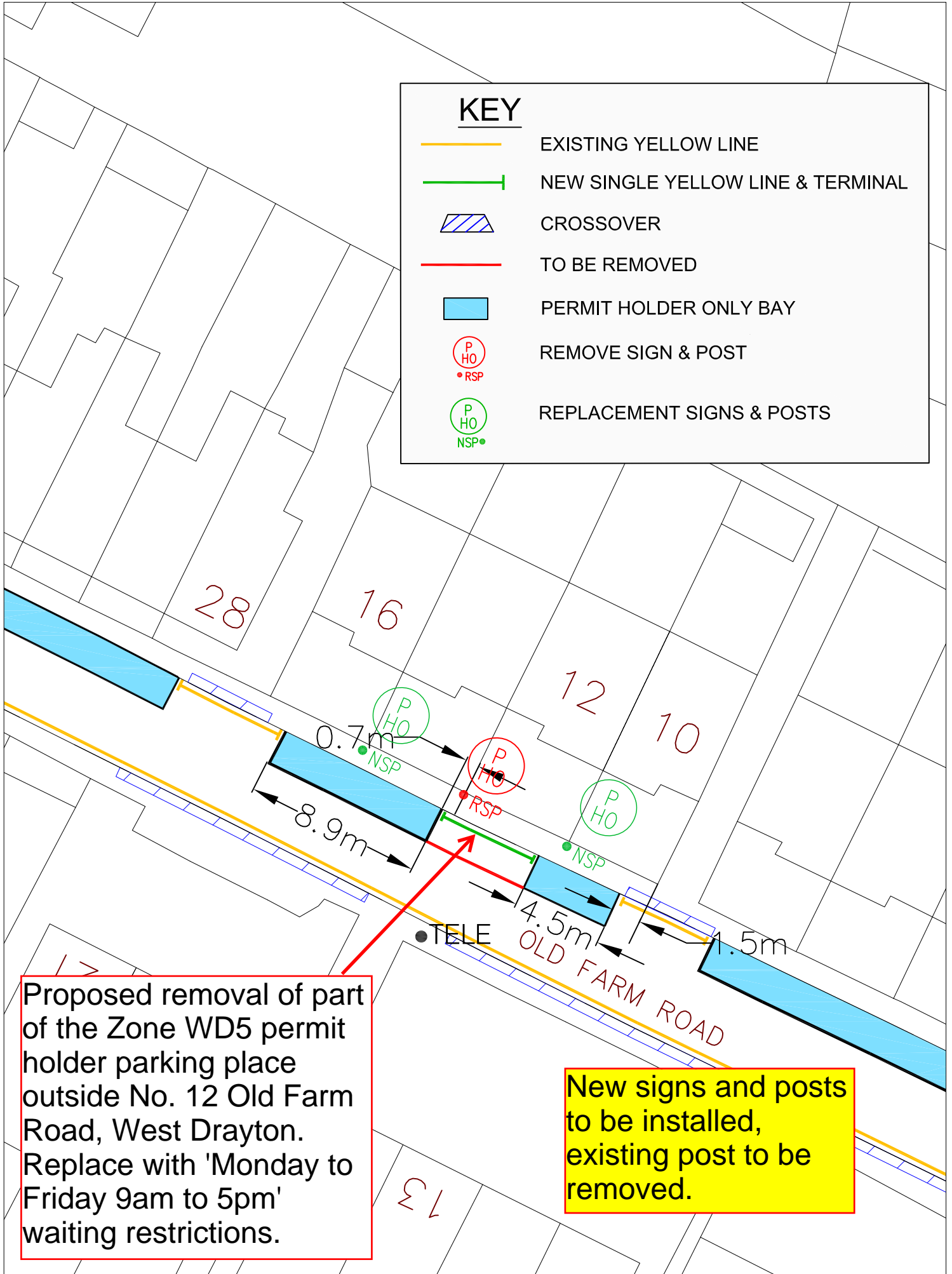

Ickenham Close, Ruislip

Proposed amendments outside No. 62

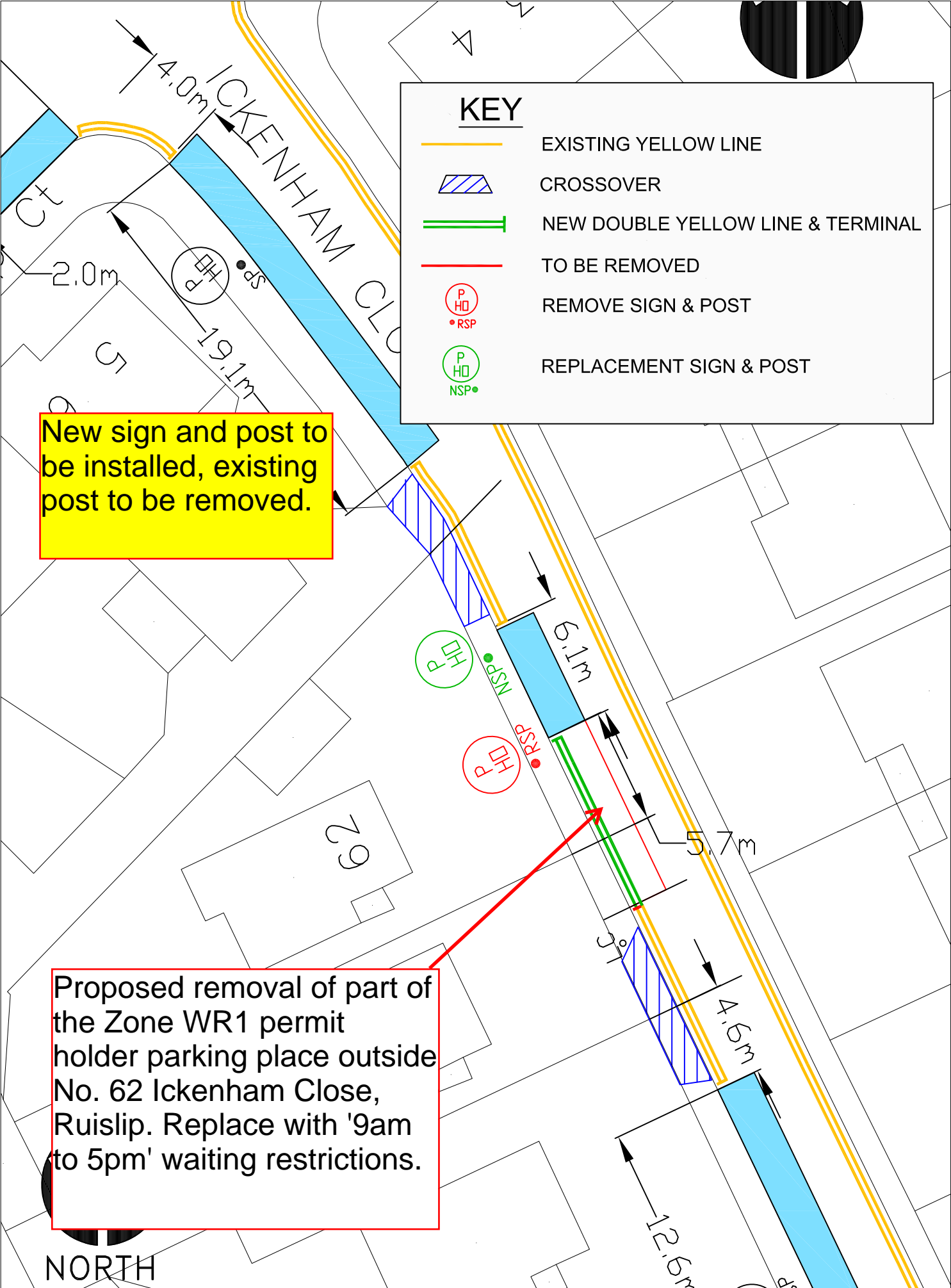

43 South Park Way, Ruislip - Proposed amendments to accommodate a new vehicle crossover

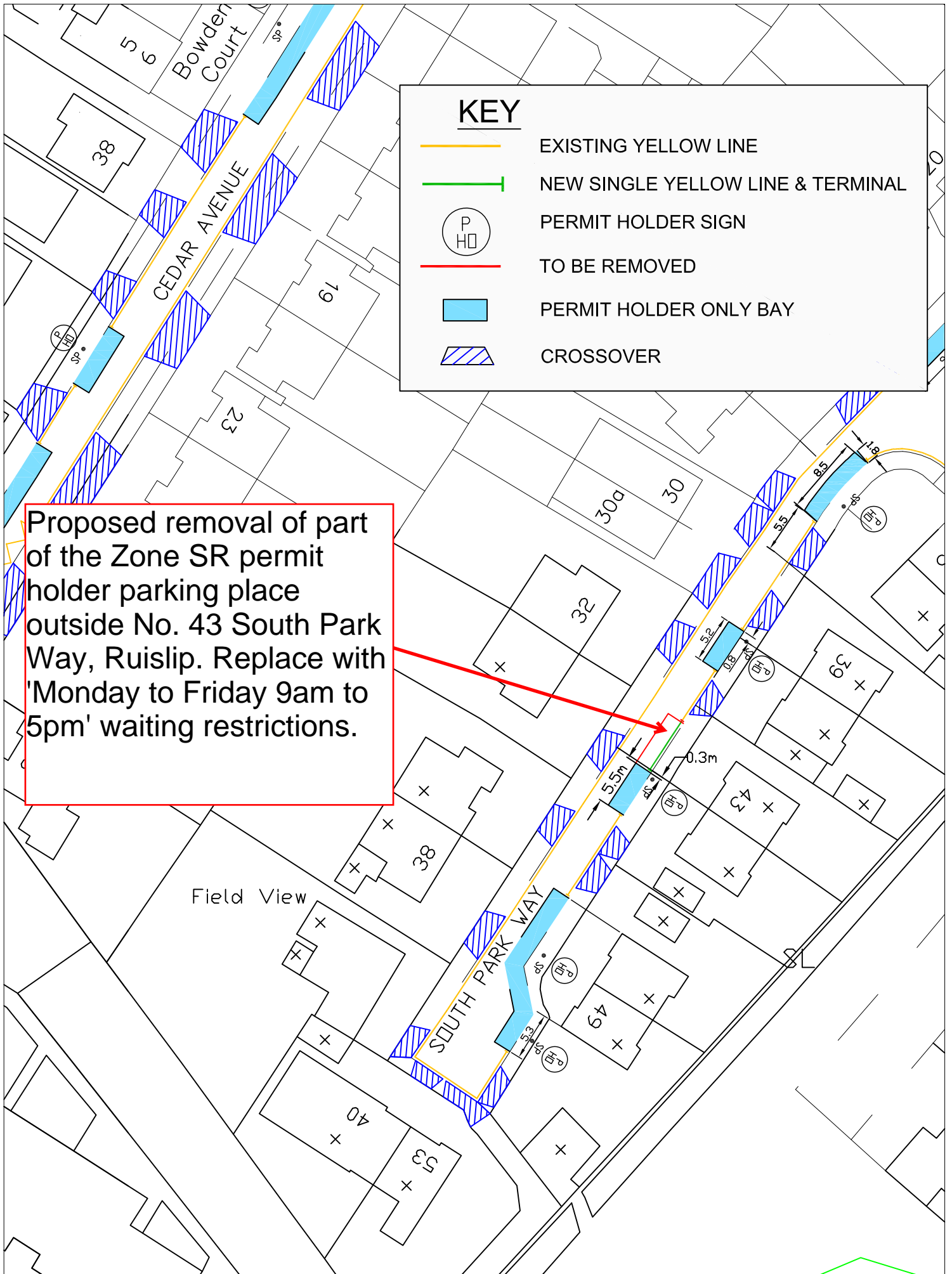

19 Canfield Drive, Ruislip - Proposed amendments to accommodate a new vehicle crossover

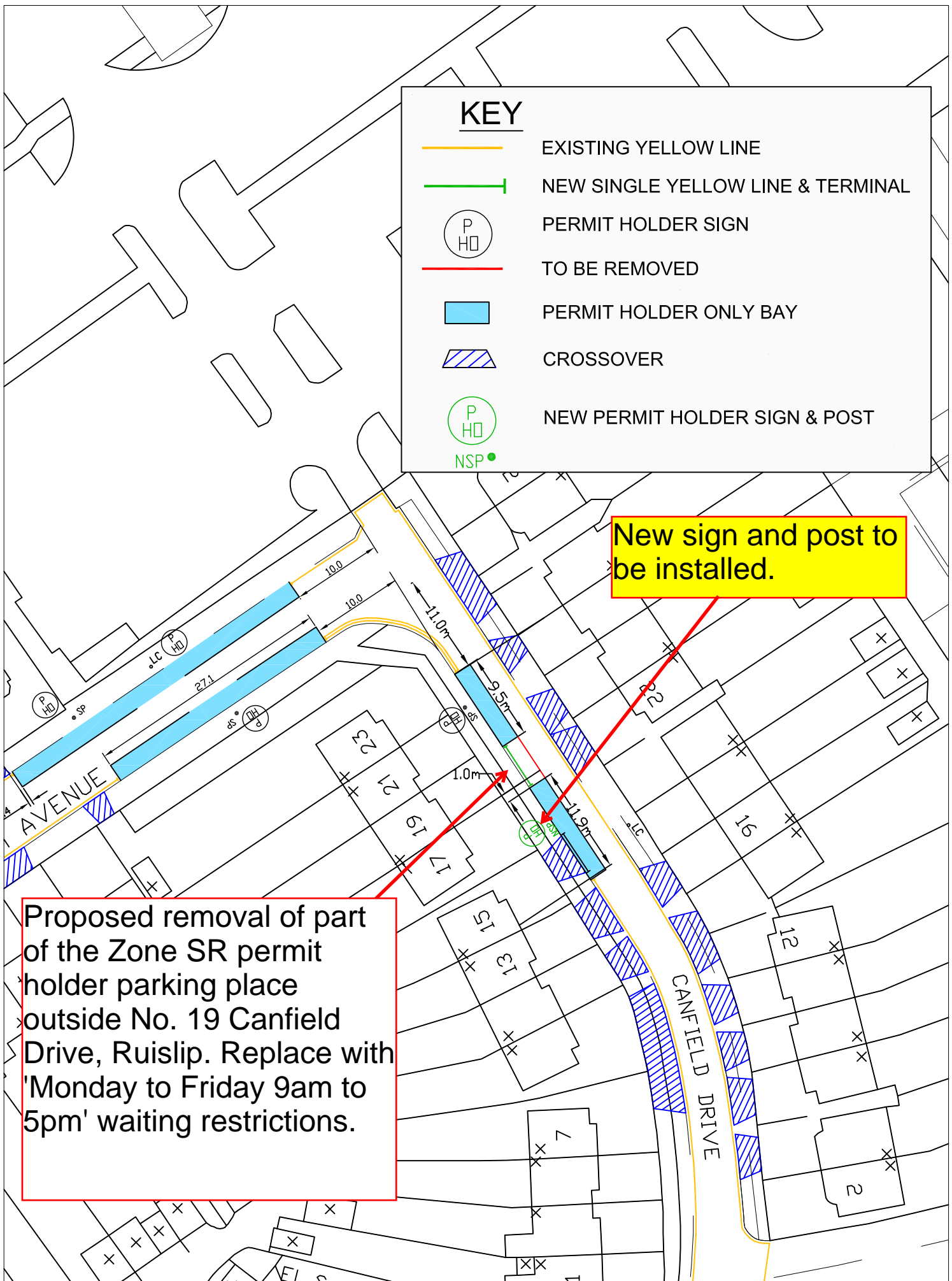

Murray Road, Northwood - Proposed amendments for vehicle crossover extension outside No. 16

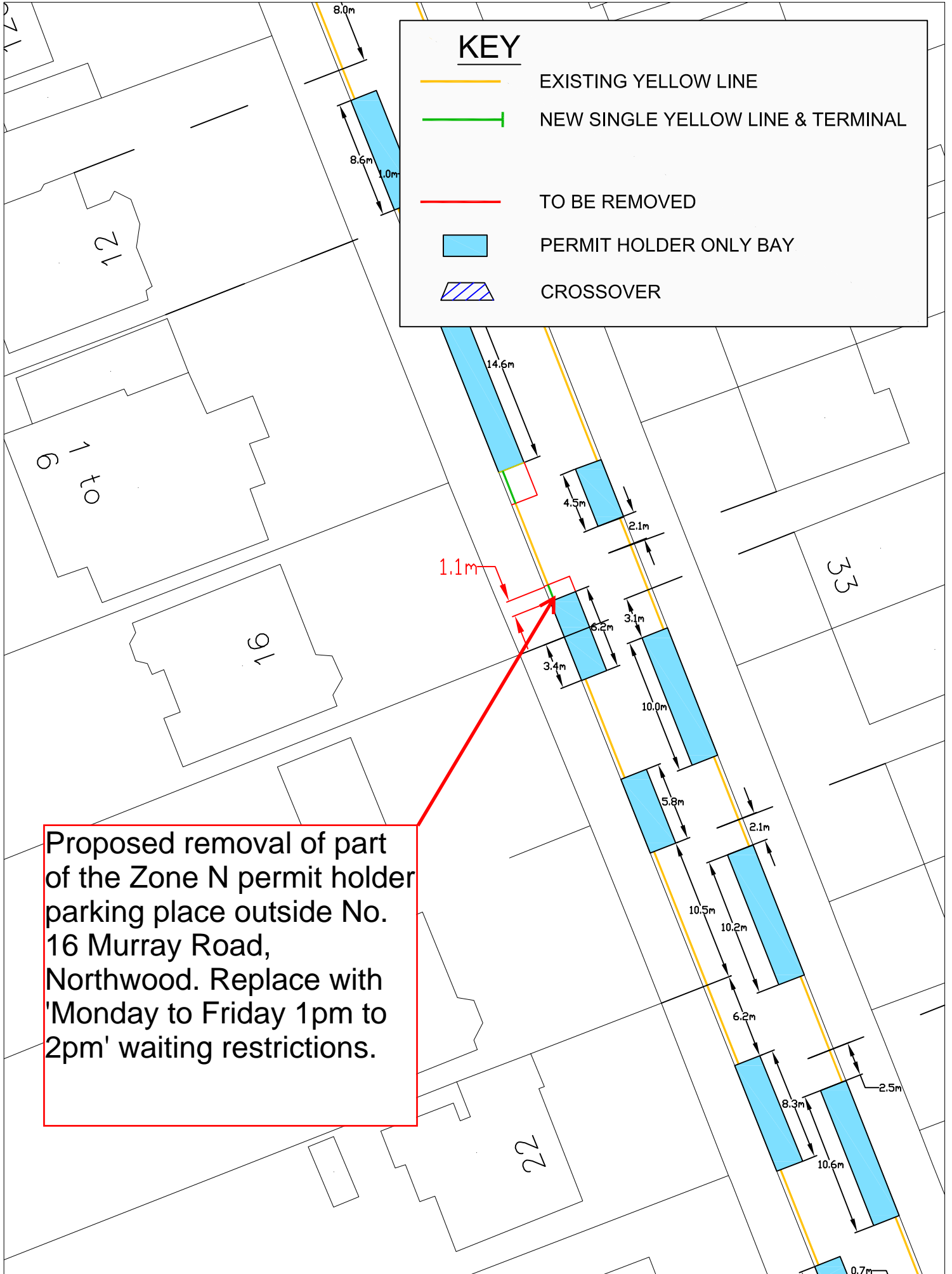

Haslam Close, Ruislip - Convert single yellow line outside Nos. 45 to 47 to double yellow lines

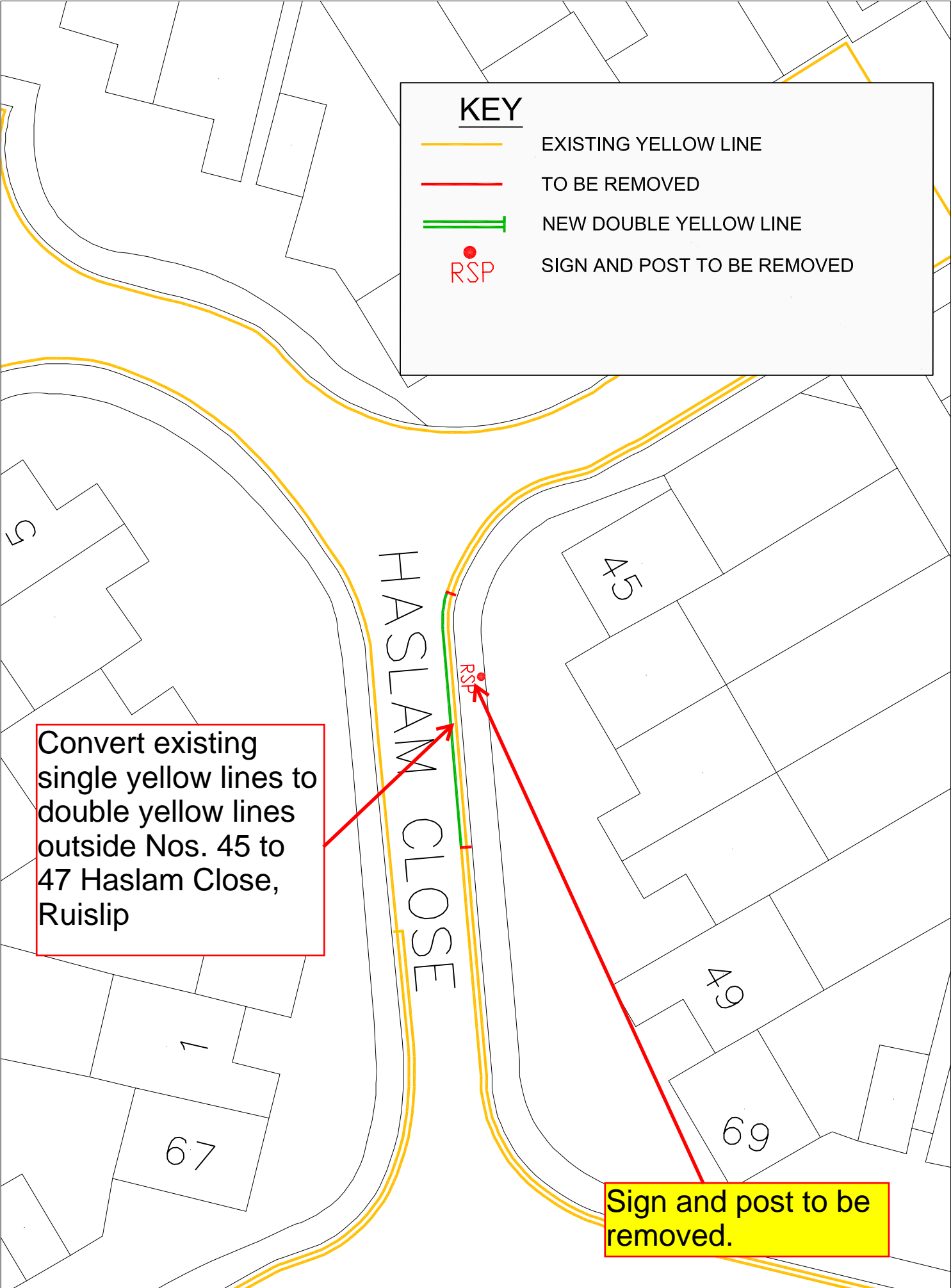



HILLINGDON
LONDON

London Borough of Hillingdon Traffic Management Order

2024 No. **XX**

The Hillingdon (On Street Parking Places) (Northwood Hills Parking Management Scheme) NWH & JS(B) Zones Order 2022 (Amendment **No. x**) Order 2024

Made on xx

Coming into operation on xx

The Council of the London Borough of Hillingdon (hereinafter referred to as “the Council”) in exercise of its powers under Sections 45, 46, 51 and 124 of and Part III and Part IV of Schedule 9 to the Road Traffic Regulation Act 1984¹ as amended by The Local Government Act 1985², The Road Traffic Regulation (Parking) Act 1986³, the Parking Act 1989⁴ and The Road Traffic Act 1991⁵ and all other powers enabling it in that behalf and after consultation with the Chief Officer of Police hereby makes the following Order.

1. This Order shall come into operation on the **xx** and may be cited as The Hillingdon (On Street Parking Places) (Northwood Hills Parking Management Scheme) NWH & JS(B) Zones Order 2022 (Amendment No. **xx**) Order 2024.
2. Without prejudice to the validity of anything done or to any liability incurred in respect of any act or omission before the coming into operation of this Order as The Hillingdon (On Street Parking Places) (Northwood Hills Parking Management Scheme) NWH & JS(B) Zones Order 2022⁶ shall have effect as though the parking place numbered 35 in Schedule 1 of that Order was substituted by the parking place numbered the same in Schedule 1 of this Order.

¹ 1984 c.27

² 1985 c.51

³ 1986 c.27

⁴ 1989 c.16

⁵ 1991 c.40

⁶ 2022 No. 53

Dated this the xx day of xxx

DAVID KNOWLES,
Head of Transport & Town Centre Projects

SCHEDULE 1

RESIDENT PERMIT HOLDERS PARKING PLACES - ZONE NWH

In relation to the parking place referred to in this schedule, the expression "permitted hours," means the period between 'Monday to Friday 1pm to 2pm' inclusive, any such day not being Christmas Day, Good Friday or a Bank Holiday. Parking places in which a vehicle may be left during the permitted hours if it displays a valid Zone NWH permit or visitor voucher or has been granted either a virtual permit or virtual visitor voucher. All parking places are 2 metres wide unless otherwise stated.

| Parking Place No. | Designated Parking Place |
|--------------------------|---|
| 35 | BRIARWOOD DRIVE, The east to west arm, the north side, from a point 0.8 metres east of the common boundary of Nos. 59 and 60 Briarwood Drive, westwards for a distance of 6 metres. |



HILLINGDON
LONDON

London Borough of Hillingdon Traffic Management Order

2024 No. X

The Hillingdon (On Street Parking Places) (West Drayton) (Residents) WD Zones Order 2022 (Amendment No. X) Order 2024

Made on XX

Coming into operation on XX

The Council of the London Borough of Hillingdon (hereinafter referred to as “the Council”) in exercise of its powers under Sections 45, 46, 51 and 124 of and Part III and Part IV of Schedule 9 to the Road Traffic Regulation Act 1984¹ as amended by The Local Government Act 1985², The Road Traffic Regulation (Parking) Act 1986³, the Parking Act 1989⁴ and The Road Traffic Act 1991⁵ and all other powers enabling it in that behalf and after consultation with the Chief Officer of Police hereby makes the following Order.

1. This Order shall come into operation on the XX and may be cited as The Hillingdon (On Street Parking Places) (West Drayton) (Residents) WD Zones Order 2022 (Amendment No. X) Order 2024.
2. Without prejudice to the validity of anything done or to any liability incurred in respect of any act or omission before the coming into operation of this Order as The Hillingdon (On Street Parking Places) (West Drayton) (Residents) WD Zones Order 2022⁶ shall have effect as though the parking place numbered 16 in Schedule 6 of that Order was substituted by the parking places numbered 16a, 16b and 16c as set out in Schedule 6 within this Order.

¹ 1984 c.27

² 1985 c.51

³ 1986 c.27

⁴ 1989 c.16

⁵ 1991 c.40

⁶ 2022 No. 29

Dated this the xx day of xxx

DAVID KNOWLES,
Head of Transport & Town Centre Projects

SCHEDULE 6

RESIDENT PERMIT HOLDERS PARKING PLACES - ZONE WD5

In relation to the parking place referred to in this schedule, the expression "permitted hours," means the period between 'Monday to Friday 9am to 5pm' inclusive, any such day not being Christmas Day, Good Friday or a Bank Holiday. Parking places in which a vehicle may be left during the permitted hours if it displays a valid Zone WD5 permit or visitor voucher or has been granted either a virtual permit or virtual voucher. All parking places are 2 metres wide unless otherwise stated.

| Parking Place No. | Designated Parking Place |
|--------------------------|--|
| 16a | OLD FARM ROAD, the northeast side, from a point 31.5 metres northwest of the north-western kerblines of Swan Road, northwestwards to a point opposite a point in line with the common boundary of Nos. 9 and 11 Old Farm Road. |
| 16b | OLD FARM ROAD, the northeast side, from a point 1.5 metres northwest of the southeastern flank wall of No. 10 Old Farm Road, northwestwards for a distance of 4.5 metres. |
| 16c | OLD FARM ROAD, the northeast side, from a point 0.7 metres northwest of the common boundary of Nos. 12 and 14 Old Farm Road, northwestwards for a distance of 8.9 metres. |



HILLINGDON
LONDON

London Borough of Hillingdon Traffic Management Order

2024 No. xx

The Hillingdon (On Street Parking Places) (Cowley Parking Management Scheme) C Zones (No. 2) Order 2022 (Amendment No. x) Order 2024

Made on xx

Coming into operation on xx

The Council of the London Borough of Hillingdon (hereinafter referred to as “the Council”) in exercise of its powers under Sections 45, 46, 51 and 124 of and Part III and Part IV of Schedule 9 to the Road Traffic Regulation Act 1984¹ as amended by The Local Government Act 1985², The Road Traffic Regulation (Parking) Act 1986³, the Parking Act 1989⁴ and The Road Traffic Act 1991⁵ and all other powers enabling it in that behalf and after consultation with the Chief Officer of Police hereby makes the following Order.

1. This Order shall come into operation on the xx and may be cited as The Hillingdon (On Street Parking Places) (Cowley Parking Management Scheme) C Zones (No. 2) Order 2022 (Amendment No. x) Order 2024.
2. Without prejudice to the validity of anything done or to any liability incurred in respect of any act or omission before the coming into operation of this Order as The Hillingdon (On Street Parking Places) (Cowley Parking Management Scheme) C Zones (No. 2) Order 2022⁶ shall have effect as though the parking place numbered 90 in Schedule 1 of that Order was deleted.

¹ 1984 c.27

² 1985 c.51

³ 1986 c.27

⁴ 1989 c.16

⁵ 1991 c.40

⁶ 2022 No. 55

Dated this the xx day of xxxx

DAVID KNOWLES,
Head of Transport & Town Centre Projects



HILLINGDON
LONDON

London Borough of Hillingdon Traffic Management Order

2024 No. **XX**

The Hillingdon(On-Street Parking Places) (West Ruislip) (Residents Zones WR1 & WR2) Order 2021 (Amendment **No. x**) Order 2024

Made on xx

Coming into operation on xx

The Council of the London Borough of Hillingdon (hereinafter referred to as “the Council”) in exercise of its powers under Sections 45, 46, 51 and 124 of and Part III and Part IV of Schedule 9 to the Road Traffic Regulation Act 1984¹ as amended by The Local Government Act 1985², The Road Traffic Regulation (Parking) Act 1986³, the Parking Act 1989⁴ and The Road Traffic Act 1991⁵ and all other powers enabling it in that behalf and after consultation with the Chief Officer of Police hereby makes the following Order.

1. This Order shall come into operation on the **xx** and may be cited as The Hillingdon(On-Street Parking Places) (West Ruislip) (Residents Zones WR1 & WR2) Order 2021 (Amendment No. **xx**) Order 2024.
2. Without prejudice to the validity of anything done or to any liability incurred in respect of any act or omission before the coming into operation of this Order as The Hillingdon(On-Street Parking Places) (West Ruislip) (Residents Zones WR1 & WR2) Order 2021⁶ shall have effect as though the parking place numbered 7 in Schedule 2 of that Order was substituted by the parking place numbered the same in Schedule 2 of this Order.

¹ 1984 c.27

² 1985 c.51

³ 1986 c.27

⁴ 1989 c.16

⁵ 1991 c.40

⁶ 2021 No. 28

Dated this the xx day of xxx

DAVID KNOWLES,
Head of Transport & Town Centre Projects

SCHEDULE 1

RESIDENT PERMIT HOLDERS PARKING PLACES - ZONE WR1

In relation to the parking place referred to in this schedule, the expression "permitted hours," means the period between 9am to 5pm inclusive, any such day not being Christmas Day, Good Friday or a Bank Holiday. Parking places in which a vehicle may be left during the permitted hours if it displays a valid Zone WR1 permit or visitor voucher. All parking places are 2 metres wide unless otherwise stated.

| Parking Place No. | Designated Parking Place |
|--------------------------|--|
| 7 | ICKENHAM CLOSE – Southwest side, from a point 5.7 metres northwest of the common boundary of Nos. 60 and 62 Ickenham Close, northwestwards for a distance of 6.1 metres. |



HILLINGDON
LONDON

London Borough of Hillingdon Traffic Management Order

2024 No. **XX**

The Hillingdon (Waiting & Loading Restrictions) Order 2023 (Amendment No. **XX**) Order 2024

Made on **XXXXXXXXXXXX**

Coming into operation **XXXXXXXXXXXX**

The Council of the London Borough of Hillingdon, after consulting the Commissioner of Police of the Metropolis in exercise of the powers conferred by Section 6 and 124 of and part IV of Schedule 9 to the Road Traffic Regulation Act 1984¹ as amended by Section 8 and Schedule 5 of the Local Government Act 1985², the Road Traffic Act 1991³ and of all other enabling powers hereby make the following Order:-

1. This Order shall come into operation on **XXXXXXXXXX** and may be cited as The Hillingdon (Waiting & Loading Restrictions) Order 2023 (Amendment No. **XX**) Order 2024.
2. In this Order the expression “enactment” means any enactment, whether public, general or local, and includes any order, bye-law, rule, regulation, scheme or other instrument having effect by virtue of an enactment and any reference in this Order to any enactment shall be construed as a reference to that enactment as amended, applied, consolidated, re-enacted by or as having effect by virtue of any subsequent enactment.
3. Without prejudice to the validity of anything done or to any liability incurred in respect of any act or omission before the coming into operation of this Order, The Hillingdon (Waiting & Loading Restrictions) Order 2023⁴ shall have effect as though the item numbered 1065 in

¹ 1984 c.27

² 1985 c.51

³ 1991 c.40

⁴ 2023 No. 19

Schedule 1 of that Order was substituted by the item numbered the same as set out in columns 1, 2 and 3 of Schedule 1 of this Order.

Dated this the XX day of XXXXXXXXXXXX

DAVID KNOWLES,
Head of Transport & Town Centre Projects

| 1 | 2 | 3 |
|------|--|-----|
| 1065 | HASLAM CLOSE, ICKENHAM | |
| | a) The west side, from the northern kerbline of Aylsham Drive for a distance of 20 metres. | A |
| | b) The east side, from the northern kerbline of Aylsham Drive, northwards to a point in line with the northeastern boundary of Nos. 45 – 49 Haslam Close. | A |
| | c) The south east side, from a point in line with the northeastern boundary of Nos. 45 – 49 Haslam Close to a point in line with the eastern kerbline of the north to south arm of Haslam Close. | A |
| | c) The rest of the adopted highway of Haslam Close not mentioned in a), b) and c) above. | JJJ |

KEY

A = 'At any time' waiting restrictions.

JJJ = 'Monday to Friday 9.30am to 10.30am and between 3.30pm to 4.30pm' waiting restrictions.



HILLINGDON
LONDON

London Borough of Hillingdon Traffic Management Order

2024 No. xx

The Hillingdon (On Street Parking Places) (South Ruislip Parking Management Scheme) SR Zones Order 2022 (Amendment No. x) Order 2024

Made on xx

Coming into operation on xx

The Council of the London Borough of Hillingdon (hereinafter referred to as “the Council”) in exercise of its powers under Sections 45, 46, 51 and 124 of and Part III and Part IV of Schedule 9 to the Road Traffic Regulation Act 1984¹ as amended by The Local Government Act 1985², The Road Traffic Regulation (Parking) Act 1986³, the Parking Act 1989⁴ and The Road Traffic Act 1991⁵ and all other powers enabling it in that behalf and after consultation with the Chief Officer of Police hereby makes the following Order.

1. This Order shall come into operation on the xx and may be cited as The Hillingdon (On Street Parking Places) (South Ruislip Parking Management Scheme) SR Zones Order 2022 (Amendment No. x) Order 2024.
2. Without prejudice to the validity of anything done or to any liability incurred in respect of any act or omission before the coming into operation of this Order as The Hillingdon (On Street Parking Places) (South Ruislip Parking Management Scheme) SR Zones Order 2022⁶ shall have effect as though:
 - i) the parking place numbered 29 in Schedule 1 of that Order was substituted by the parking places numbered as 29a and 29b as set out in Schedule 1 of this Order.

¹ 1984 c.27

² 1985 c.51

³ 1986 c.27

⁴ 1989 c.16

⁵ 1991 c.40

⁶ 2022 No. 40

ii) the parking place numbered 230 in Schedule 1 of that Order was substituted by the parking place numbered the same as set out in Schedule 1 of this Order.

Dated this the xx day of xxxx

DAVID KNOWLES,
Head of Transport & Town Centre Projects

SCHEDULE 1

RESIDENT PERMIT HOLDERS PARKING PLACES - ZONE SR

In relation to the parking place referred to in this schedule, the expression "permitted hours," means the period between 'Monday to Friday 9am to 5pm' inclusive, any such day not being Christmas Day, Good Friday or a Bank Holiday. Parking places in which a vehicle may be left during the permitted hours if it displays a valid Zone SR permit or visitor voucher or has been granted either a virtual residents permit or virtual visitor voucher. All parking places are 2 metres wide unless otherwise stated.

| Parking Place No. | Designated Parking Place |
|--------------------------|---|
| 29a | CANFIELD DRIVE, (southwest side) from a point 11.0 metres southeast of the southeastern kerbline of Cavendish Avenue, southeastwards for a distance of 9.5 metres. |
| 29b | CANFIELD DRIVE, (southwest side) from a point 1 metres southeast of the common boundary of Nos. 17 and 19 Cavendish Avenue, southeastwards for a distance of 11.9 metres. |
| 230 | SOUTH PARK WAY, (southeast side) from a point 0.3 metres southwest of the common boundary of Nos. 43 and 45 South Park Way, southwestwards for a distance of 5.5 metres. |



HILLINGDON
LONDON

London Borough of Hillingdon Traffic Management Order

2024 No. xx

The Hillingdon (On Street Parking Places) (Northwood Parking Management Scheme) N Zones Order 2023 (Amendment No. x) Order 2024

Made on xx

Coming into operation on xx

The Council of the London Borough of Hillingdon (hereinafter referred to as “the Council”) in exercise of its powers under Sections 45, 46, 51 and 124 of and Part III and Part IV of Schedule 9 to the Road Traffic Regulation Act 1984¹ as amended by The Local Government Act 1985², The Road Traffic Regulation (Parking) Act 1986³, the Parking Act 1989⁴ and The Road Traffic Act 1991⁵ and all other powers enabling it in that behalf and after consultation with the Chief Officer of Police hereby makes the following Order.

1. This Order shall come into operation on the xx and may be cited as The Hillingdon (On Street Parking Places) (Northwood Parking Management Scheme) N Zones Order 2023 (Amendment No. x) Order 2024.
2. Without prejudice to the validity of anything done or to any liability incurred in respect of any act or omission before the coming into operation of this Order as The Hillingdon (On Street Parking Places) (Northwood Parking Management Scheme) N Zones Order 2023⁶ shall have effect as though the parking numbered 123 in Schedule 1 of that Order was substituted by the parking place numbered the same as set out in Schedule 1 of this order.

¹ 1984 c.27

² 1985 c.51

³ 1986 c.27

⁴ 1989 c.16

⁵ 1991 c.40

⁶ 2023 No. 7

Dated this the xx day of xxx

DAVID KNOWLES,
Head of Transport & Town Centre Projects

SCHEDULE 1

RESIDENT PERMIT HOLDERS PARKING PLACES - ZONE N

In relation to the parking place referred to in this schedule, the expression "permitted hours," means the period between 'Monday to Friday 1pm to 2pm' inclusive, any such day not being Christmas Day, Good Friday or a Bank Holiday. Parking places in which a vehicle may be left during the permitted hours if it displays a valid Zone N permit or visitor voucher or has been granted either a virtual residents permit or virtual visitor voucher. All parking places are 2 metres wide unless otherwise stated.

| Parking Place No. | Designated Parking Place |
|--------------------------|---|
| 123 | MURRAY ROAD, The southwest side, from a point 1 metres northwest of the common boundary of No. 12C Murray Road and Tudor Lodge to a point 12 metres southwest of the common boundary of Nos. 28 and 30 Murray Road. |