

LONDON BOROUGH OF HILLINGDON
THE HILLINGDON (ON STREET PARKING PLACES) (NORTHWOOD PARKING
MANAGEMENT SCHEME) N ZONES ORDER 2023 (AMENDMENT) ORDER 2025
THE HILLINGDON (ON STREET PARKING PLACES) (HEATHROW PARKING MANAGEMENT
SCHEME) H ZONES ORDER 2022 (AMENDMENT) ORDER 2025
THE HILLINGDON (ON STREET PARKING PLACES) (YIEWSLEY PARKING MANAGEMENT
SCHEME) Y ZONES ORDER 2024 (AMENEMENT) ORDER 2025
THE HILLINGDON (ON STREET PARKING PLACES) (UXBRIDGE SOUTH PARKING
MANAGEMENT SCHEME) ZONES U4, U5, U6 & UM ORDER 2022 (AMENDMENT) ORDER
2025
THE HILLINGDON (WAITING & LOADING RESTRICTIONS) ORDER 2023 (AMENDMENT)
ORDER 2025
THE HILLINGDON (ON STREET PARKING PLACES) (SOUTH RUISLIP PARKING
MANAGEMENT SCHEME) SR ZONES ORDER 2022 (AMENDMENT) ORDER 2025
THE HILLINGDON (FREE PARKING PLACES) (DISABLED PERSONS) TRAFFIC ORDER
2024 (AMENDMENT) ORDER 2025

Hillingdon Council gives notice that it proposes to make these Orders to **remove the following sections of permit holder parking places to facilitate the installation of new vehicle crossings:**

- i) Remove a section of the Zone N permit holder parking place outside No. 1a Frithwood Avenue, Northwood and replace with 'Monday to Friday 1pm to 2pm' waiting restrictions.
- ii) Remove sections of the Zone N permit holder parking place outside Nos. 21 and 23 Moor Park Road, Northwood and replace with 'Monday to Friday 1pm to 2pm' waiting restrictions.
- iii) Remove the entire Zone Y2 permit holder parking place outside No. 2 Gordon Road, Yiewsley and replace with 'Monday to Friday 8.30am to 5pm' waiting restrictions.
- iv) Remove a section of the Zone U5 business permit holder parking place outside No. 1a Villier Street, Uxbridge and replace with 'at any time' waiting restrictions.
- v) Remove a section of the Zone H1 permit holder parking place outside No. 46 Doghurst Avenue, Hayes and replace with '9am to 5pm' waiting restrictions.
- vi) Remove a section of the Zone SR permit holder parking place outside No. 63 Great Central Avenue, Ruislip and replace with 'Monday to Friday 9am to 5pm' waiting restrictions. Convert the redundant disabled parking place outside No. 61 Great Central Avenue to Zone SR permit holder parking.
- vii) Remove the entire Zone SR permit holder parking place outside No. 25 Masson Avenue, Ruislip and replace with 'Monday to Friday 9am to 5pm' waiting restrictions.
- viii) Remove the entire Zone U5 permit holder parking place outside No. 89 Manor Waye, Uxbridge and replace with 'Monday to Friday 9am to 5pm' waiting restrictions.

Copies of the notice of proposals, proposed Orders together with full details, plans and the Council's statement of reasons for the proposal can be sent upon request or viewed online at <https://www.hillingdon.gov.uk/improvement-schemes> until 29th October 2025. Further information can be obtained by email parkingmanagementschemes@hillingsdon.gov.uk . If you wish to comment on, or object to the proposals please write or email by 29th October 2025, stating grounds for objection and your home address to Transport & Projects, Place Directorate, Civic Centre, Uxbridge, Middlesex UB8 1UW quoting reference 3N/04/08/10/25.

Dated this the 8th day of October 2025.

DAN KENNEDY,
Corporate Director of Residents' Services

STATEMENT OF REASONS

The proposed removal of parts of existing permit holder parking places are intended to provide clear access to new off-street parking areas being created in line with the Highways policy for new vehicle crossings and approved by the Council's Highways Delivery Manager.

1a Frithwood Avenue, Northwood

Amendments to accommodate a new vehicle crossover

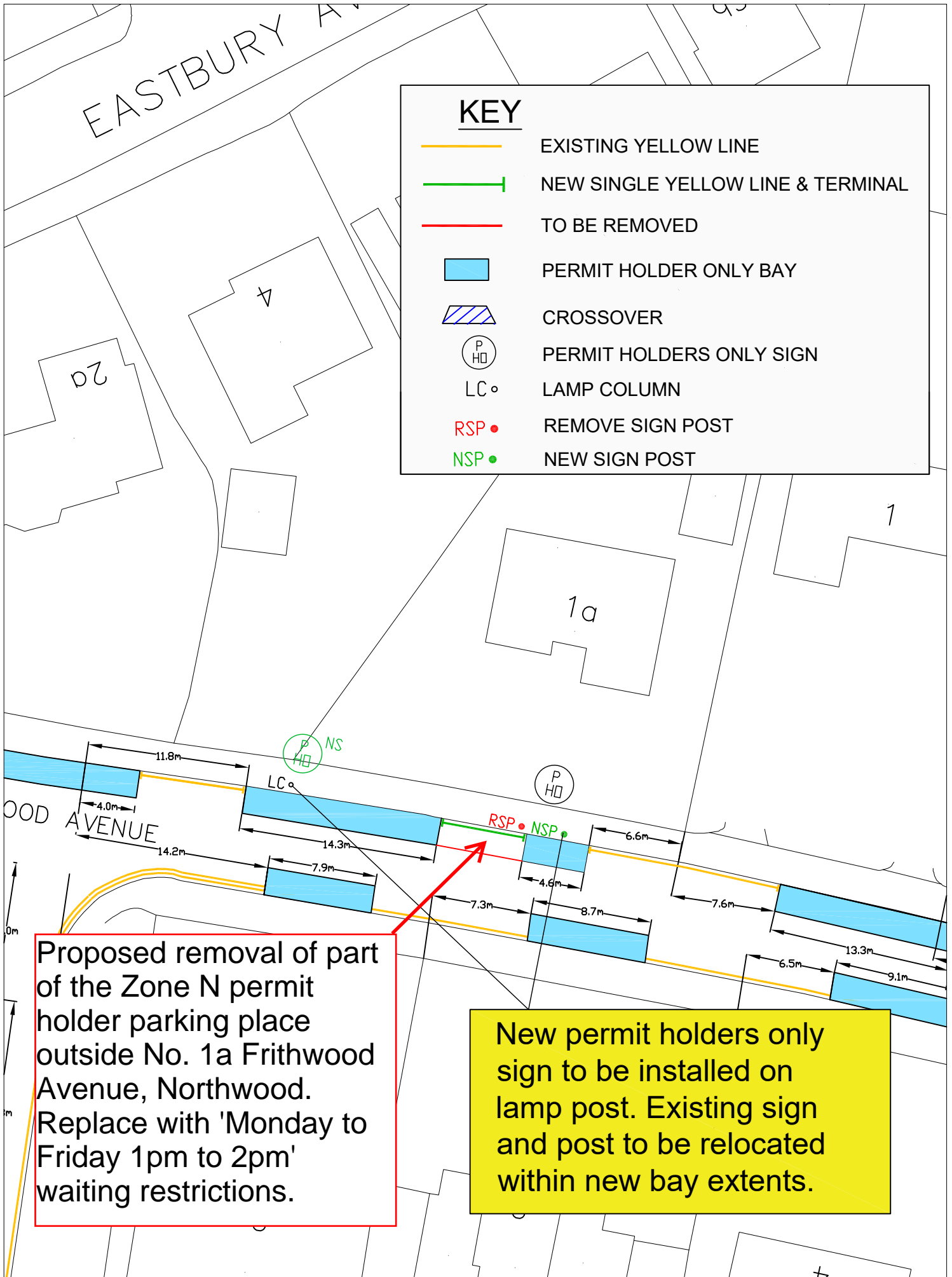

21 & 23 Moor Park Road, Northwood - Amendments to accommodate new vehicle crossovers

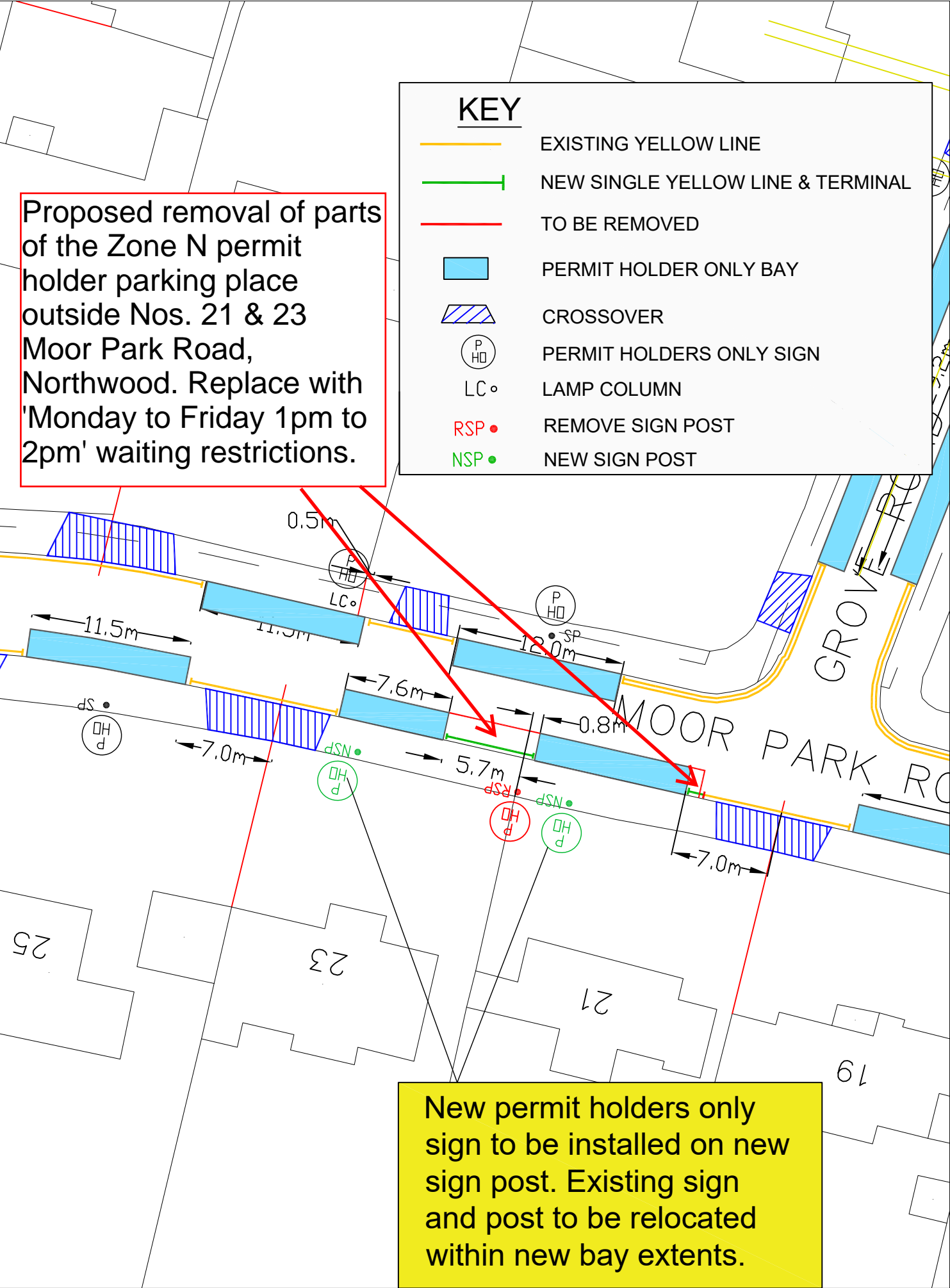

2 Gordon Road, Yiewsley - Amendments to accommodate a new vehicle crossing

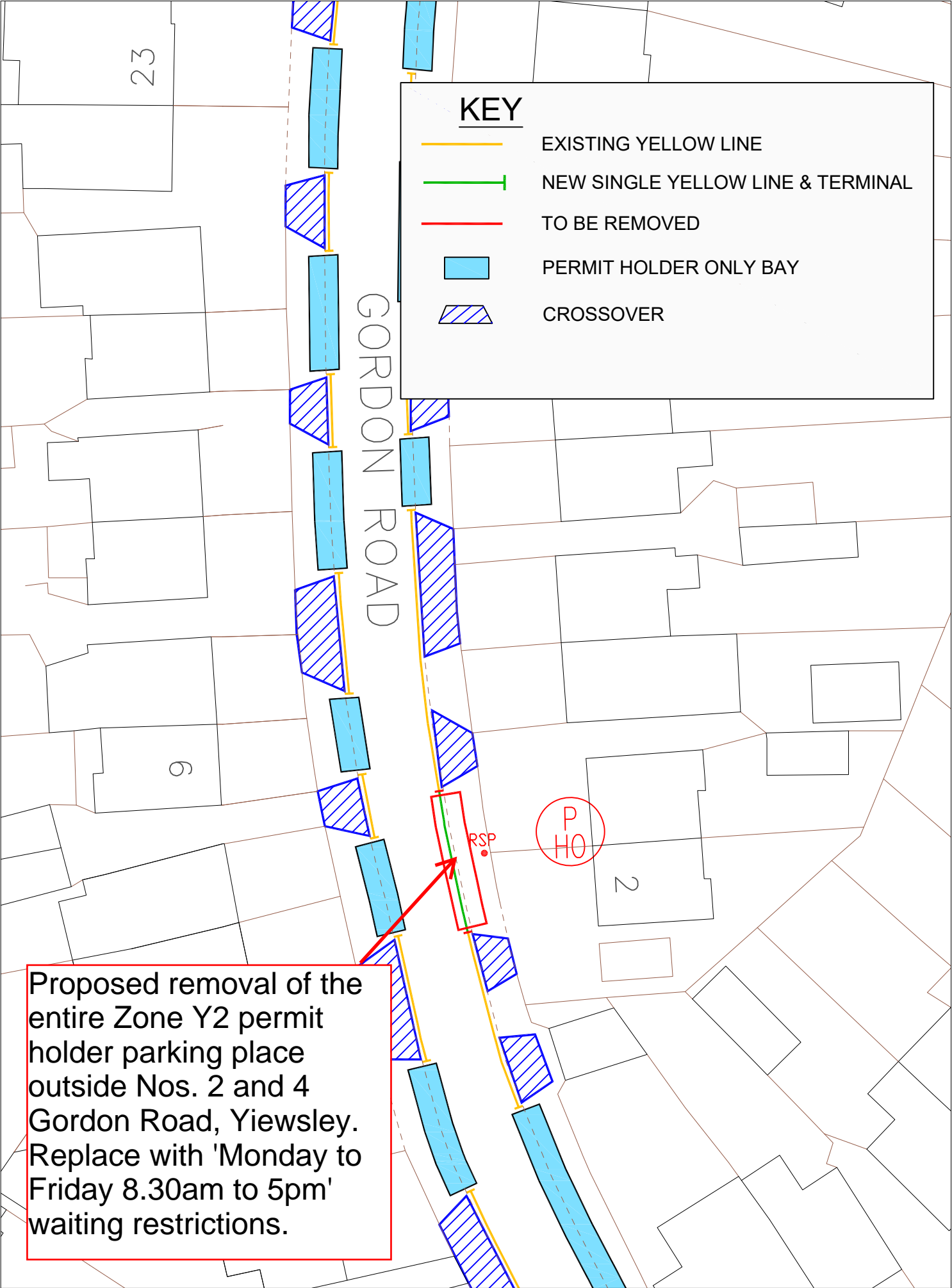

1a Villier Street, Uxbridge - Amendments to accommodate a vehicle crossing extension

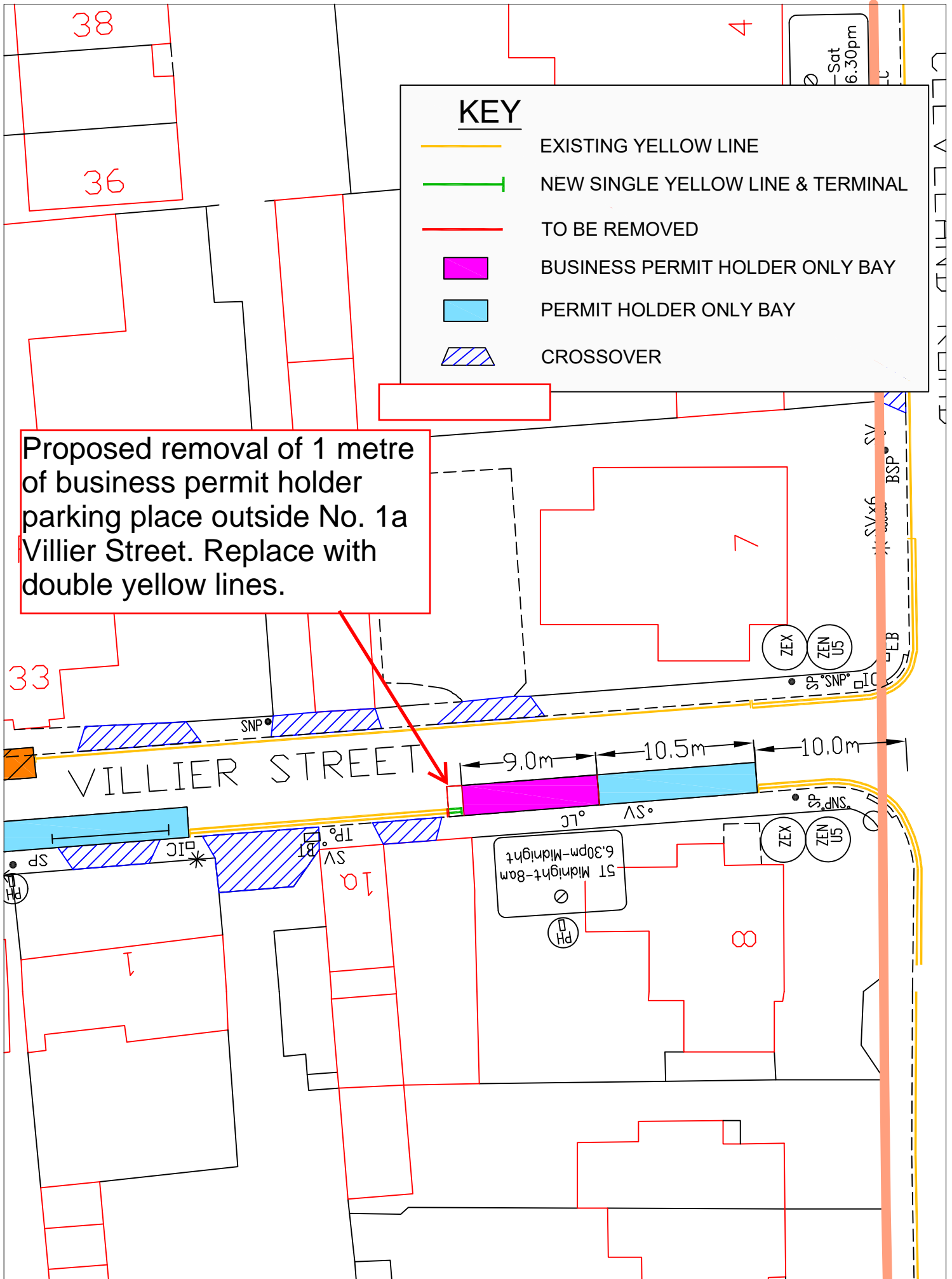

46 Doghurst Avenue, Hayes

Amendments for a vehicle crossing extension

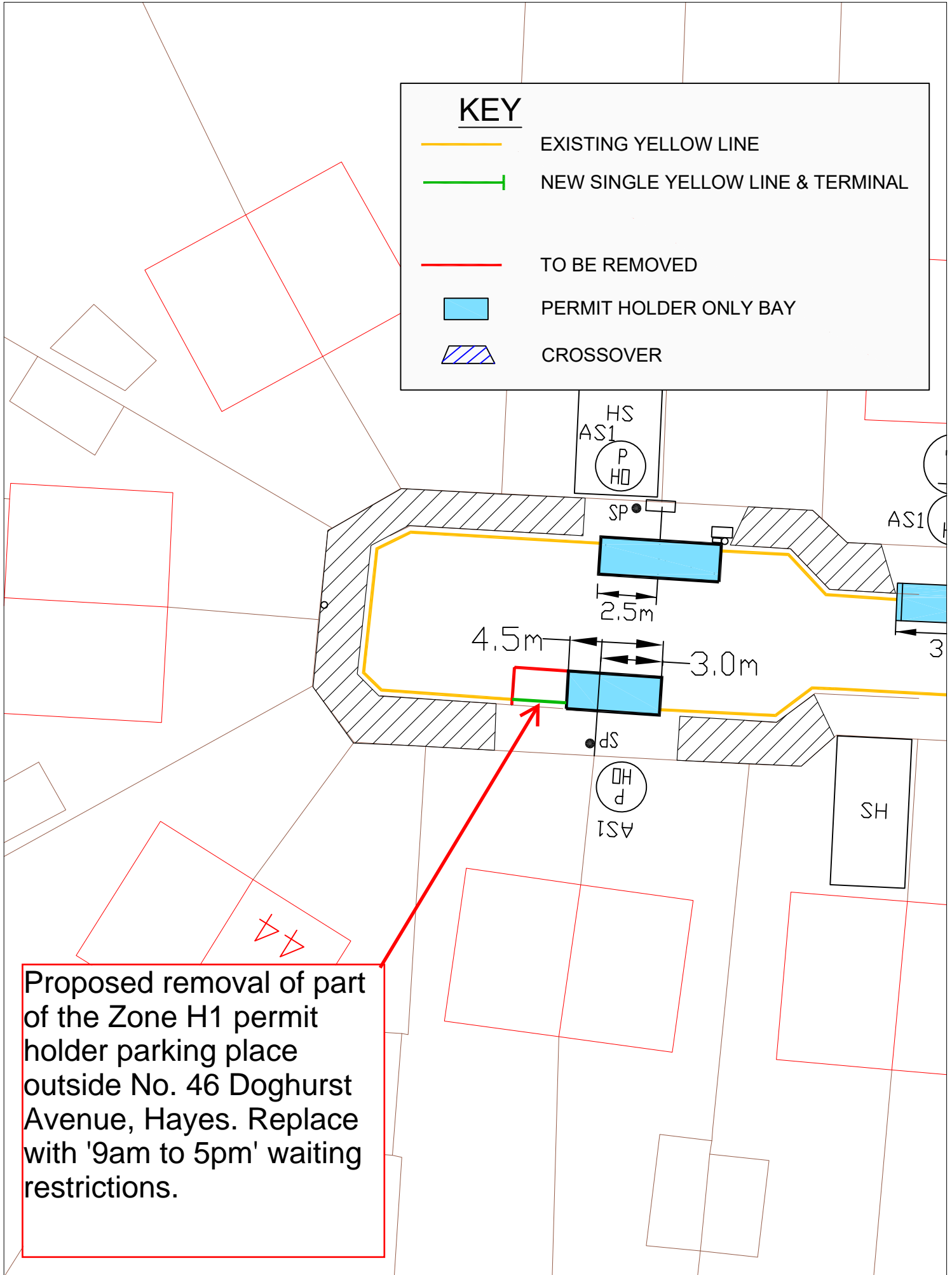

63 Great Central Avenue, Ruislip - Amendments to accommodate a new vehicle crossing

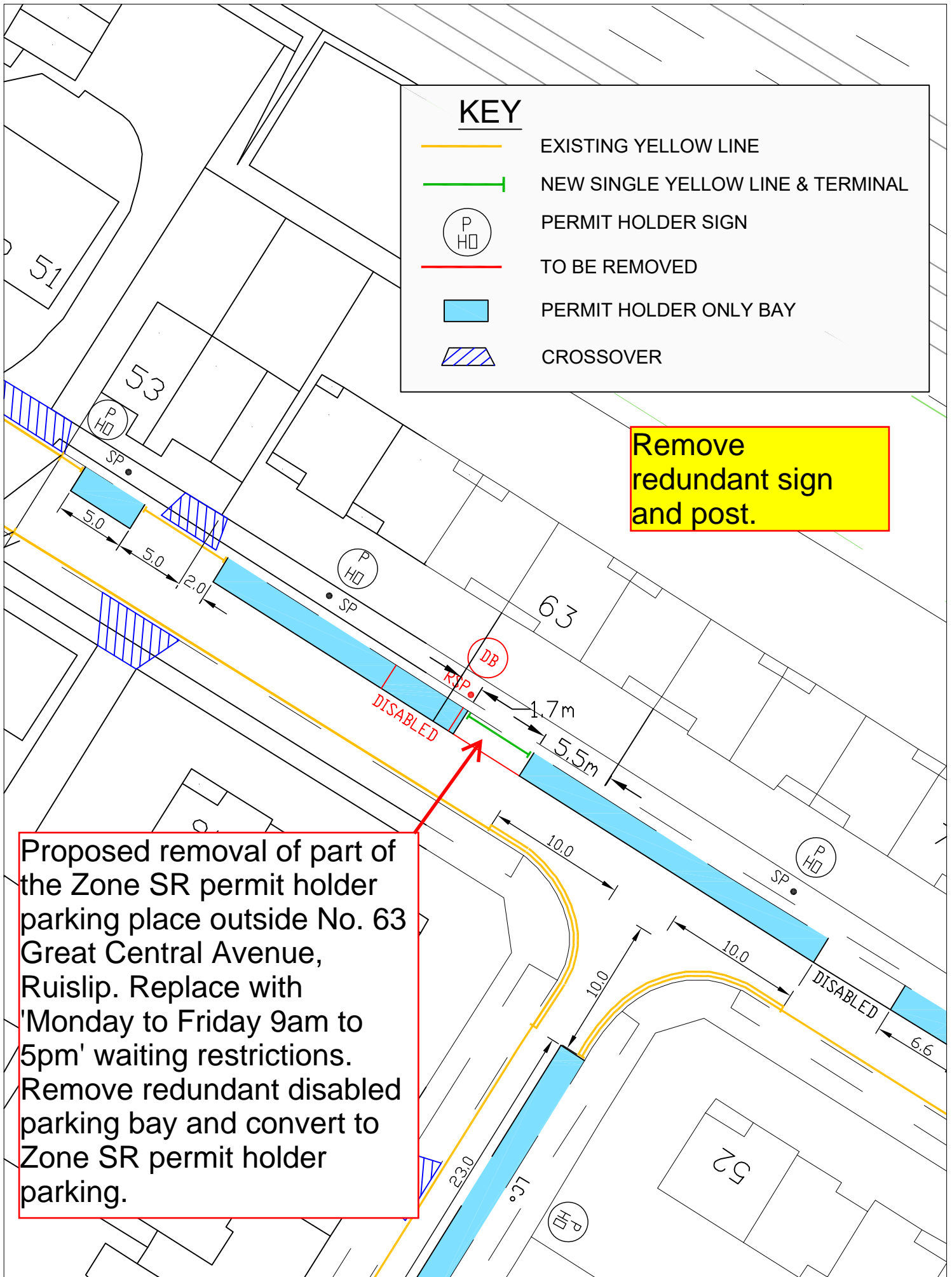

25 Masson Avenue, Ruislip - Amendments to accommodate a new vehicle crossing

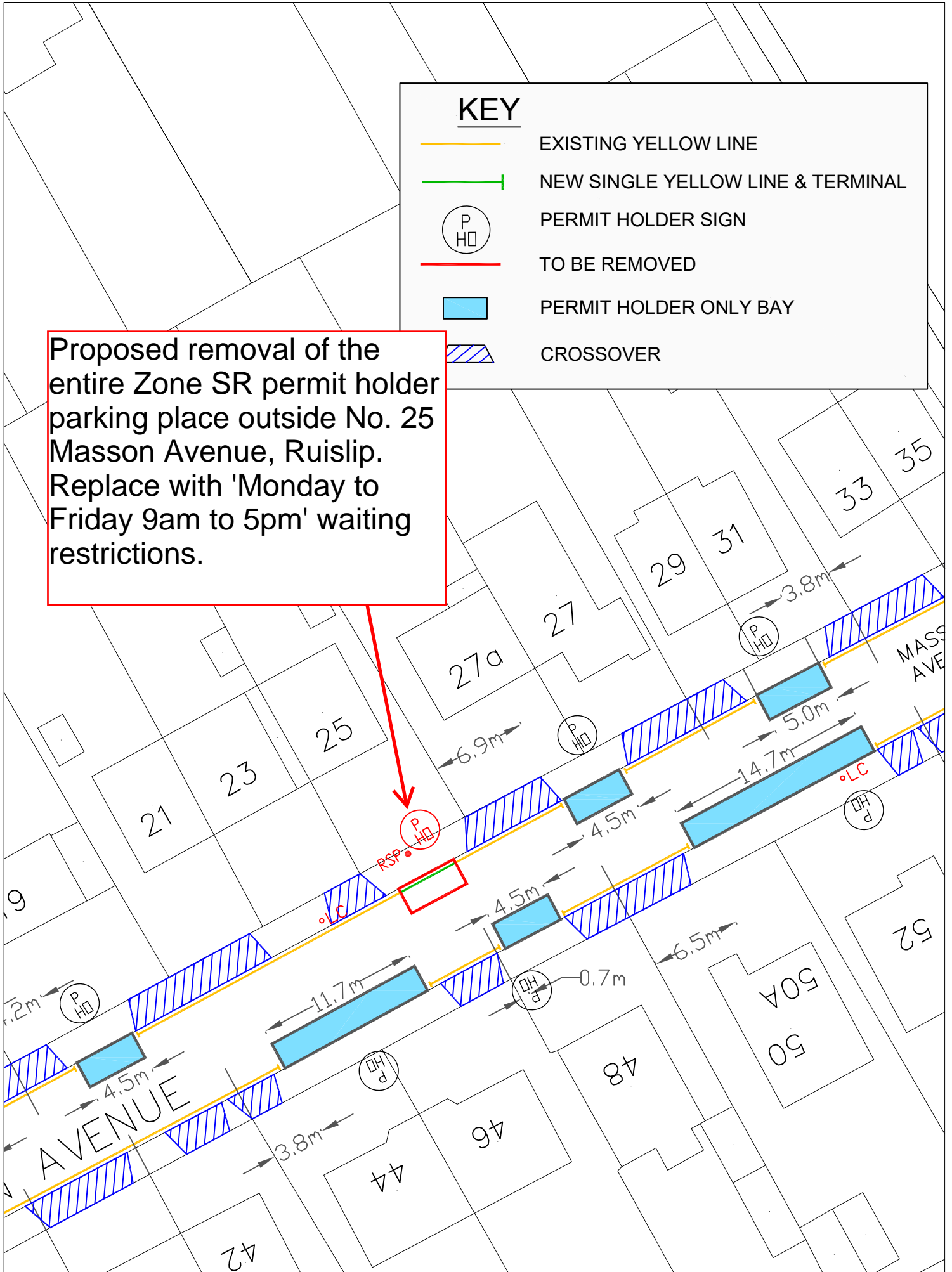

89 Manor Way, Uxbridge

Proposed amendments for new vehicle crossing

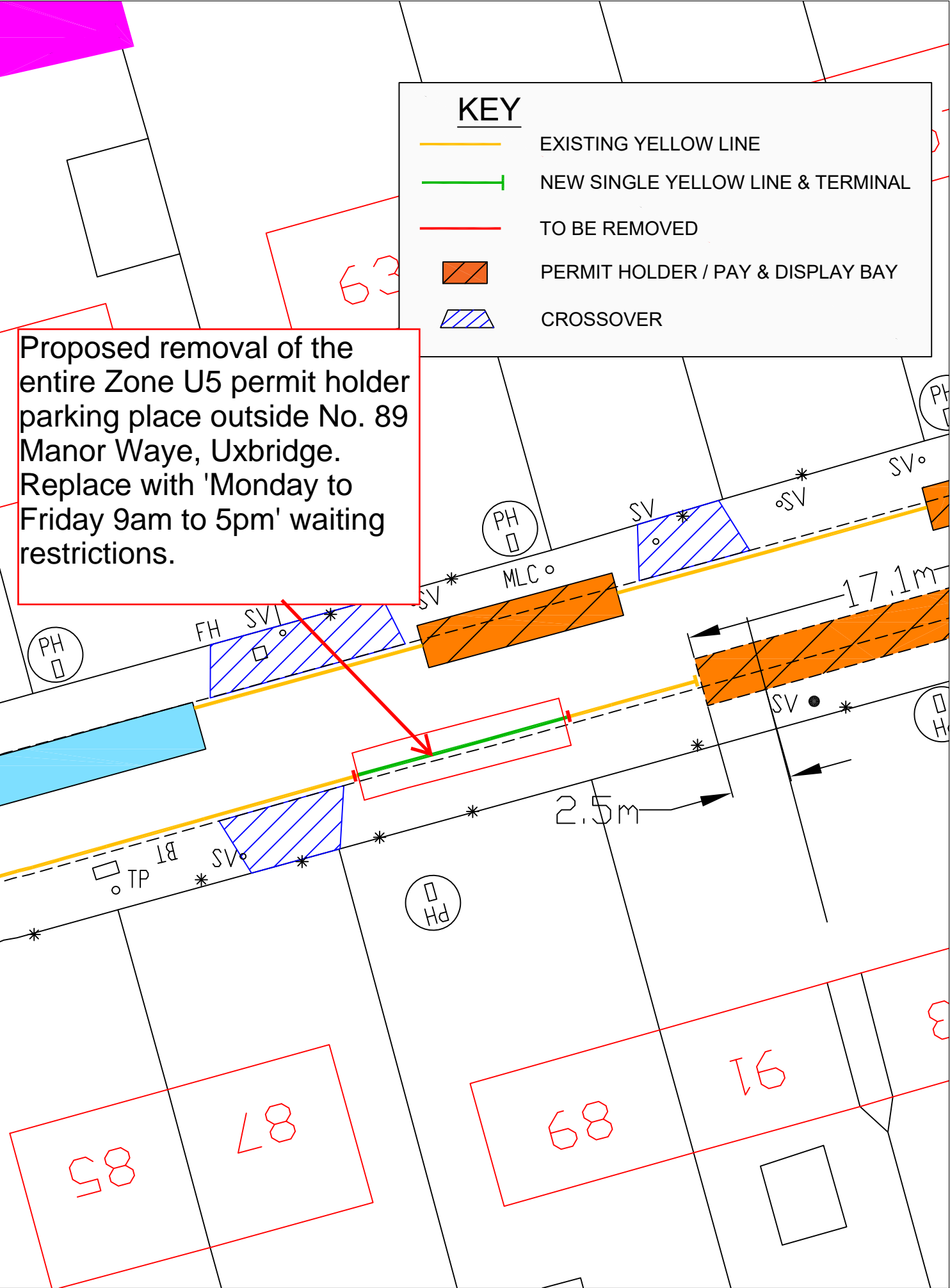



London Borough of Hillingdon Traffic Management Order

2025 No. XX

The Hillingdon (On Street Parking Places) (Northwood Parking Management Scheme) N Zones Order 2023 (Amendment No. X) Order 2025

Made on XXX

Coming into operation on XXX

The Council of the London Borough of Hillingdon (hereinafter referred to as “the Council”) in exercise of its powers under Sections 45, 46, 51 and 124 of and Part III and Part IV of Schedule 9 to the Road Traffic Regulation Act 1984¹ as amended by The Local Government Act 1985², The Road Traffic Regulation (Parking) Act 1986³, the Parking Act 1989⁴ and The Road Traffic Act 1991⁵ and all other powers enabling it in that behalf and after consultation with the Chief Officer of Police hereby makes the following Order.

1. This Order shall come into operation on the XXX and may be cited as The Hillingdon (On Street Parking Places) (Northwood Parking Management Scheme) N Zones Order 2023 (Amendment No. X) Order 2024.
2. Without prejudice to the validity of anything done or to any liability incurred in respect of any act or omission before the coming into operation of this Order as The Hillingdon (On Street Parking Places) (Northwood Parking Management Scheme) N Zones Order 2023⁶ shall have effect as though:

¹ 1984 c.27

² 1985 c.51

³ 1986 c.27

⁴ 1989 c.16

⁵ 1991 c.40

⁶ 2023 No. 7

- i) the parking place numbered 30 in Schedule 1 of that Order were substituted by the parking place numbered the same as set out in Schedule 1 of this Order.
- ii) the parking place numbered 113 in Schedule 1 of that Order were substituted by the parking places numbered 113a and 113b as set out in Schedule 1 of this Order.

Dated this the XX day of XXX

DAN KENNEDY,
Corporate Director of Residents' Services

SCHEDULE 1

RESIDENT PERMIT HOLDERS PARKING PLACES - ZONE N

In relation to the parking place referred to in this schedule, the expression "permitted hours," means the period between 'Monday to Friday 1pm to 2pm' inclusive, any such day not being Christmas Day, Good Friday or a Bank Holiday. Parking places in which a vehicle may be left during the permitted hours if it displays a valid Zone N permit or visitor voucher or has been granted either a virtual residents permit or virtual visitor voucher. All parking places are 2 metres wide unless otherwise stated.

Parking Place No.	Designated Parking Place
30	FRITHWOOD AVENUE, The northeast side, from a point opposite a point 22 metres east of the eastern kerbline of Eastbury Road, to a point 12 metres west of the western kerbline of Morgan Close.
113a	MOOR PARK ROAD, The south side, from a point 7 metres northwest of the common boundary of Nos. 19 and 21 Moor Park Road, northwestwards to a point 0.8 metres southeast of the common boundary of Nos. 21 and 23 Moor Park Road.
113b	MOOR PARK ROAD, The south side, from a point 5.7 metres northwest of the common boundary of Nos. 21 and 23 Moor Park Road, northwestwards for a distance of 7.7 metres.



London Borough of Hillingdon

Traffic Management Order

2025 No. XX

The Hillingdon (On Street Parking Places) (Heathrow Parking Management Scheme) H Zones Order 2022 (Amendment No. X) Order 2025

Made on XX

Coming into operation XX

The Council of the London Borough of Hillingdon (hereinafter referred to as “the Council”) in exercise of its powers under Sections 45, 46, 51 and 124 of and Part III and Part IV of Schedule 9 to the Road Traffic Regulation Act 1984¹ as amended by The Local Government Act 1985², The Road Traffic Regulation (Parking) Act 1986³, the Parking Act 1989⁴ and The Road Traffic Act 1991⁵ and all other powers enabling it in that behalf and after consultation with the Chief Officer of Police hereby makes the following Order.

1. This Order shall come into operation on the XX and may be cited as The Hillingdon (On Street Parking Places) (Heathrow Parking Management Scheme) H Zones Order 2022 (Amendment No. X) Order 2025.
2. Without prejudice to the validity of anything done or to any liability incurred in respect of any act or omission before the coming into operation of this Order as The Hillingdon (On Street Parking Places) (Heathrow Parking Management Scheme) H Zones Order 2022⁶ shall have effect as though the parking place numbered 12 in Schedule 5 of that Order was substituted by the parking place numbered the same as set out within Schedule 5 of this Order.

¹ 1984 c.27

² 1985 c.51

³ 1986 c.27

⁴ 1989 c.16

⁵ 1991 c.40

⁶ 2022 No. 26

Dated this the XX day of XXX

DAN KENNEDY,
Corporate Director of Residents' Services

SCHEDULE 5

RESIDENT PERMIT HOLDERS PARKING PLACES - ZONE H1

In relation to the parking place referred to in this schedule, the expression "permitted hours," means the period between '9am to 5pm', any such day not being Christmas Day, Good Friday or a Bank Holiday. Parking places in which a vehicle may be left during the permitted hours if it displays a valid Zone H1 permit or visitor voucher or has been granted either a virtual residents permit or virtual visitor voucher. All parking places are 2 metres wide unless otherwise stated.

Parking Place No.	Designated Parking Place
12	DOGHURST AVENUE, the south side, from a point 3 metres east of the common boundary of Nos. 40 & 42 Doghurst Avenue, westwards for a distance of 4.5 metres.



London Borough of Hillingdon

Traffic Management Order

2025 No. XX

The Hillingdon (On Street Parking Places) (Yiewsley Parking Management Scheme) Y Zones Order 2024 (Amendment No. X) Order 2025

Made on XX

Coming into operation XX

The Council of the London Borough of Hillingdon (hereinafter referred to as “the Council”) in exercise of its powers under Sections 45, 46, 51 and 124 of and Part III and Part IV of Schedule 9 to the Road Traffic Regulation Act 1984¹ as amended by The Local Government Act 1985², The Road Traffic Regulation (Parking) Act 1986³, the Parking Act 1989⁴ and The Road Traffic Act 1991⁵ and all other powers enabling it in that behalf and after consultation with the Chief Officer of Police hereby makes the following Order.

1. This Order shall come into operation on the XX 2025 and may be cited as The Hillingdon (On Street Parking Places) (Yiewsley Parking Management Scheme) Y Zones Order 2024 (Amendment No. X) Order 2025.
2. Without prejudice to the validity of anything done or to any liability incurred in respect of any act or omission before the coming into operation of this Order as The Hillingdon (On Street Parking Places) (Yiewsley Parking Management Scheme) Y Zones Order 2024⁶ shall have effect as though Schedule 4 of that Order was substituted by Schedule 4 of this Order.

¹ 1984 c.27

² 1985 c.51

³ 1986 c.27

⁴ 1989 c.16

⁵ 1991 c.40

⁶ 2024 No. 9

Dated this the XX day of XXX

DAN KENNEDY,
Corporate Director of Residents' Services

SCHEDULE 4

RESIDENT PERMIT HOLDERS PARKING PLACES - ZONE Y2

In relation to the parking place referred to in this schedule, the expression "permitted hours," means the period between 'Monday to Friday 8.30am to 5pm' inclusive, any such day not being Christmas Day, Good Friday or a Bank Holiday. Parking places in which a vehicle may be left during the permitted hours if it displays a valid Zone Y2 permit or visitor voucher or has been granted either a virtual residents permit or virtual visitor voucher. All parking places are 2 metres wide unless otherwise stated.

Parking Place No.	Designated Parking Place
1	GORDON ROAD, The northwest side, from a point 11 metres northwest of the northwestern kerbline of Falling Lane slip road, northwestwards for a distance of 10 metres. SPECIAL MANNER OF STANDING: Vehicles permitted to park on the footway with two wheels only for a distance of 1.2 metres from the kerb
2	GORDON ROAD, The northwest side, from a point 3.5 metres southeast of the common boundary of Nos. 1 and 3 Gordon Road, northwestwards for a distance of 9.1 metres. SPECIAL MANNER OF STANDING: Vehicles permitted to park on the footway with two wheels only for a distance of 1.2 metres from the kerb
3	GORDON ROAD, The west side, from a point 3.3 metres south of the common boundary of Nos. 5 and 7 Gordon Road, northwards for a distance of 6.3 metres. SPECIAL MANNER OF STANDING: Vehicles permitted to park on the footway with two wheels only for a distance of 1.2 metres from the kerb
4	GORDON ROAD, YIEWSLEY, The west side, from a point 3.8 metres south of the common boundary of Nos. 9 and 11 Gordon Road, northwards for a distance of 5.0 metres. SPECIAL MANNER OF STANDING: Vehicles permitted to park on the footway with two wheels only for a distance of 1.2 metres from the kerb

SCHEDULE 4

RESIDENT PERMIT HOLDERS PARKING PLACES - ZONE Y2

In relation to the parking place referred to in this schedule, the expression "permitted hours," means the period between 'Monday to Friday 8.30am to 5pm' inclusive, any such day not being Christmas Day, Good Friday or a Bank Holiday. Parking places in which a vehicle may be left during the permitted hours if it displays a valid Zone Y2 permit or visitor voucher or has been granted either a virtual residents permit or virtual visitor voucher. All parking places are 2 metres wide unless otherwise stated.

Parking Place No.	Designated Parking Place
5	GORDON ROAD, YIEWSLEY, The west side, from a point 4.1 metres south of the common boundary of Nos. 13 and 15 Gordon Road, northwards for a distance of 8.0 metres. SPECIAL MANNER OF STANDING: Vehicles permitted to park on the footway with two wheels only for a distance of 1.2 metres from the kerb
6	GORDON ROAD, The west side, from a point 4.3 metres south of the common boundary of Nos. 17 and 19 Gordon Road, northwards for a distance of 7.9 metres. SPECIAL MANNER OF STANDING: Vehicles permitted to park on the footway with two wheels only for a distance of 1.2 metres from the kerb
7	GORDON ROAD, The west side, from a point 4.2 metres south of the common boundary of Nos. 21 and 23 Gordon Road, northwards for a distance of 8.2 metres. SPECIAL MANNER OF STANDING: Vehicles permitted to park on the footway with two wheels only for a distance of 1.2 metres from the kerb
8	GORDON ROAD, The southeast side, from a point 10 metres northwest of the northwestern kerbline of Falling Lane slip road, northwestwards for a distance of 22.8 metres. SPECIAL MANNER OF STANDING: Vehicles permitted to park on the footway with two wheels only for a distance of 1.2 metres from the kerb
9	GORDON ROAD, The east side, from a point 3.9 metres south of the common boundary of Nos. 10 and 12 Gordon Road, northwards for a distance of 4.6 metres. SPECIAL MANNER OF STANDING: Vehicles permitted to park on the footway with two wheels only for a distance of 1.2 metres from the kerb

SCHEDULE 4

RESIDENT PERMIT HOLDERS PARKING PLACES - ZONE Y2

In relation to the parking place referred to in this schedule, the expression "permitted hours," means the period between 'Monday to Friday 8.30am to 5pm' inclusive, any such day not being Christmas Day, Good Friday or a Bank Holiday. Parking places in which a vehicle may be left during the permitted hours if it displays a valid Zone Y2 permit or visitor voucher or has been granted either a virtual residents permit or virtual visitor voucher. All parking places are 2 metres wide unless otherwise stated.

Parking Place No.	Designated Parking Place
10	GORDON ROAD, The east side, from a point 4.1 metres south of the common boundary of Nos. 14 and 16 Gordon Road, northwards for a distance of 9.6 metres. SPECIAL MANNER OF STANDING: Vehicles permitted to park on the footway with two wheels only for a distance of 1.2 metres from the kerb
11	GORDON ROAD, The east side, from a point 5.3 metres south of the common boundary of Nos. 18 and 20 Gordon Road, northwards for a distance of 11.3 metres. SPECIAL MANNER OF STANDING: Vehicles permitted to park on the footway with two wheels only for a distance of 1.2 metres from the kerb



London Borough of Hillingdon

Traffic Management Order

2025 No. XX

The Hillingdon (On Street Parking Places) (Uxbridge South Parking Management Scheme) Zones U4, U5, U6 & UM Order 2022 (Amendment No. XX) Order 2025

Made on XX

Coming into operation XX

The Council of the London Borough of Hillingdon (hereinafter referred to as “the Council”) in exercise of its powers under Sections 45, 46, 51 and 124 of and Part III and Part IV of Schedule 9 to the Road Traffic Regulation Act 1984¹ as amended by The Local Government Act 1985², The Road Traffic Regulation (Parking) Act 1986³, the Parking Act 1989⁴ and The Road Traffic Act 1991⁵ and all other powers enabling it in that behalf and after consultation with the Chief Officer of Police hereby makes the following Order.

1. This Order shall come into operation on the XX and may be cited as The Hillingdon (On Street Parking Places) (Uxbridge South Parking Management Scheme) Zones U4, U5, U6 & UM Order 2022 (Amendment No. X) Order 2025.
2. Without prejudice to the validity of anything done or to any liability incurred in respect of any act or omission before the coming into operation of this Order as The Hillingdon (On Street Parking Places) (Uxbridge South Parking Management Scheme) Zones U4, U5, U6 & UM Order 2022⁶ shall have effect as though:

¹ 1984 c.27

² 1985 c.51

³ 1986 c.27

⁴ 1989 c.16

⁵ 1991 c.40

⁶ 2022 No. 33

- i) the parking place numbered 47 in Schedule 2 of that Order was substituted by the parking place numbered the same in Schedule 2 of this Order.
- ii) the parking place numbered 4 in Schedule 13 of that Order was substituted by the parking place numbered the same in Schedule 13 of this Order.

Dated this the xx day of xxx

DAN KENNEDY,
Corporate Director of Residents' Services

SCHEDULE 2

RESIDENT PERMIT HOLDERS PARKING PLACES - ZONE U5

In relation to the parking place referred to in this schedule, the expression "permitted hours," means the period between 'Monday to Friday 9am to 5pm' inclusive, any such day not being Christmas Day, Good Friday or a Bank Holiday. Parking places in which a vehicle may be left during the permitted hours if it displays a valid Zone U5 permit or visitor voucher or has been granted either a virtual residents permit or virtual visitor voucher. All parking places are 2 metres wide unless otherwise stated.

Parking Place No.	Designated Parking Place
47	<p>MANOR WAYE, The northern northeast to southwest arm, the south side, from a point 1.5 metres east of the common boundary of Nos. 87 and 89 Manor Waye, to a point 3.0 metres west of the common boundary of Nos. 107 and 109 Manor Waye. Bay width 1.8 metres.</p> <p>SPECIAL MANNER OF STANDING: Vehicles permitted to park on the footway with two wheels only, for a maximum distance of 0.4 metres from the kerb.</p>

SCHEDULE 13

BUSINESS PERMIT HOLDERS PARKING PLACES - ZONE U5(B)

In relation to the parking place referred to in this schedule, the expression "permitted hours," means the period between 'Monday to Friday 9am to 5pm', any such day not being Christmas Day, Good Friday or a Bank Holiday. Parking places in which a vehicle may be left during the permitted hours if it displays a valid Zone U5(B) business permit or has been granted a valid virtual business permit. All parking places are 2 metres wide unless otherwise stated.

Parking Place No.	Designated Parking Place
4	VILLIER STREET, The south side, from a point 20.5 metres west of the western kerbline of Cleveland Road westwards for a distance of 9 metres.



HILLINGDON
LONDON

London Borough of Hillingdon Traffic Management Order

2025 No. XX

The Hillingdon (Waiting & Loading Restrictions) Order 2023 (Amendment No. XX) Order 2025

Made on XXX

Coming into operation XXX

The Council of the London Borough of Hillingdon, after consulting the Commissioner of Police of the Metropolis in exercise of the powers conferred by Section 6 and 124 of and part IV of Schedule 9 to the Road Traffic Regulation Act 1984¹ as amended by Section 8 and Schedule 5 of the Local Government Act 1985², the Road Traffic Act 1991³ and of all other enabling powers hereby make the following Order:-

1. This Order shall come into operation on XXX and may be cited as The Hillingdon (Waiting & Loading Restrictions) Order 2023 (Amendment No. XX) Order 2025.
2. In this Order the expression “enactment” means any enactment, whether public, general or local, and includes any order, bye-law, rule, regulation, scheme or other instrument having effect by virtue of an enactment and any reference in this Order to any enactment shall be construed as a reference to that enactment as amended, applied, consolidated, re-enacted by or as having effect by virtue of any subsequent enactment.
3. Without prejudice to the validity of anything done or to any liability incurred in respect of any act or omission before the coming into operation of this Order, The Hillingdon (Waiting & Loading Restrictions) Order 2023⁴ shall have effect as though the item numbered 528 in

¹ 1984 c.27

² 1985 c.51

³ 1991 c.40

⁴ 2023 No. 19

Schedule 1 of that Order were substituted by the items numbered the same as set out in columns 1, 2 and 3 of Schedule 1 of this Order.

Dated this the XX day of XXXXX

DAN KENNEDY,
Corporate Director of Residents' Services

1	2	3
528	VILLIER STREET, UXBRIDGE	
	a) The north side	
	i) from a point in line with the western kerbline of Enfield Close westwards for a distance of 13 metres.	A
	ii) from a point in line with the eastern kerbline of Enfield Close eastwards for a distance of 10 metres.	A
	iii) between a point in line with the western flank wall of Villier Street Auto Repairs Garage and a point 1 metre west of the eastern boundary of No. 33 Villier Street.	A
	b) The south side, from a point 29.5 metres west of the western kerbline of Cleveland Road westwards for a distance of 20 metres.	A
	c) Both sides	
	i) from a point in line with the western kerbline of Cleveland Road westwards for a distance of 10 metres	A
	ii) from a point in line with the eastern kerbline of Elthorne Road eastwards for a distance of 8 metres	A
	d) The rest of the public highway of Villier Street excluding that mentioned in a) b) and c)	LL

KEY

A = 'At any time' waiting restrictions.

LL = 'Monday to Friday 9am to 5pm' waiting restrictions.



London Borough of Hillingdon Traffic Management Order

2025 No. XX

The Hillingdon (On Street Parking Places) (South Ruislip Parking Management Scheme) SR Zones Order 2022 (Amendment No. XX) Order 2025

Made on XXX

Coming into operation on XXX

The Council of the London Borough of Hillingdon (hereinafter referred to as “the Council”) in exercise of its powers under Sections 45, 46, 51 and 124 of and Part III and Part IV of Schedule 9 to the Road Traffic Regulation Act 1984¹ as amended by The Local Government Act 1985², The Road Traffic Regulation (Parking) Act 1986³, the Parking Act 1989⁴ and The Road Traffic Act 1991⁵ and all other powers enabling it in that behalf and after consultation with the Chief Officer of Police hereby makes the following Order.

1. This Order shall come into operation on the XXX and may be cited as The Hillingdon (On Street Parking Places) (South Ruislip Parking Management Scheme) SR Zones Order 2022 (Amendment No. XX) Order 2026.
2. Without prejudice to the validity of anything done or to any liability incurred in respect of any act or omission before the coming into operation of this Order as The Hillingdon (On Street Parking Places) (South Ruislip Parking Management Scheme) SR Zones Order 2022⁶ shall have effect as though

¹ 1984 c.27

² 1985 c.51

³ 1986 c.27

⁴ 1989 c.16

⁵ 1991 c.40

⁶ 2022 No. 40

- i) the parking places numbered 100 and 101 in Schedule 1 of that Order was substituted by the parking places numbered the same in Schedule 1 of that Order.
- ii) the parking place numbered 102 in Schedule 1 of that Order was deleted.

Dated this the xx day of xxx

DAN KENNEDY,
Corporate Director of Residents' Services

SCHEDULE 1

RESIDENT PERMIT HOLDERS PARKING PLACES - ZONE SR

In relation to the parking place referred to in this schedule, the expression "permitted hours," means the period between 'Monday to Friday 9am to 5pm' inclusive, any such day not being Christmas Day, Good Friday or a Bank Holiday. Parking places in which a vehicle may be left during the permitted hours if it displays a valid Zone SR permit or visitor voucher or has been granted either a virtual residents permit or virtual visitor voucher. All parking places are 2 metres wide unless otherwise stated.

Parking Place No.	Designated Parking Place
100	GREAT CENTRAL AVENUE, (northeast side) from a point 2.0 metres southeast of the common boundary of Nos. 55 and 57, southeastwards to a point 1.7 metres southeast of the common boundary of Nos. 61 and 63 Great Central Avenue.
101	GREAT CENTRAL AVENUE, (northeast side) from a point 5.5 metres northeast of the common boundary of Nos. 65 and 67 Great Central Avenue, southeastwards to a point 2 metres northwest of the common boundary of Nos. 79 and 81 Great Central Avenue.



HILLINGDON
LONDON

London Borough of Hillingdon Traffic Management Order

2025 No. ??

The Hillingdon (Free Parking Places) (Disabled Persons) Traffic Order 2024
(Amendment No. XX) Order 2025

Made on ??????????

Coming into operation on ??????????

The London Borough of Hillingdon, after consulting the Commissioner of Police of Metropolis, in exercise of the powers conferred by section 6 of the Road Traffic Regulation Act 1984¹, as amended The Local Government Act 1985² and of all other powers thereunto enabling hereby make the following Order:

1. This Order shall come into operation on the ????????? and may be cited as The Hillingdon (Free Parking Places) (Disabled Persons) Traffic Order 2024 (Amendment No. XX) Order 2025.
2. Without prejudice to the validity of anything done or to any liability incurred in respect of any act or omission before the coming into operation of this Order, The Hillingdon (Free Parking Places) (Disabled Persons) Traffic Order 2024³ shall have effect as though the parking place numbered 602 in Schedule 1 of that Order was deleted.

Dated this the ?? day of ??????????????

KARRIE WHELAN,
Corporate Director Place

¹ 1984 c.27

² 1985 c.51

³ 2024 No. 42