

LONDON BOROUGH OF HILLINGDON
THE HILLINGDON (WAITING AND LOADING RESTRICTION) (CONSOLIDATION)
ORDER 1994 (AMENDMENT) ORDER 2019

THE HILLINGDON (ON STREET PARKING PLACES) (HAYES END STOP & SHOP) ORDER 2019
Hillingdon Council gives notice that it proposes to make these Orders which will:

1. Amend the current layout of the Stop & Shop parking scheme outside Hayes End Parade, Uxbridge Road, Hayes as follows:

- i) Introduction of various lengths of 'at any time' waiting and loading restrictions along the parade to improve access and promote road safety.
- ii) Relocate of the goods vehicle loading only bay within the service road to outside Nos. 1250 to 1258 Uxbridge Road.
- iii) Repositioning of various pay & display and blue badge disabled parking bays to maximise the available kerbside space.

2. Introduce raised road tables with a maximum height of 75mm and 1:20 gradient ramps on each approach at the following locations:

- i) At the junction of the service road fronting Hayes End Parade and Newport Road, Hayes.
- ii) Within the service road fronting Hayes End Parade outside Nos. 1266 to 1274 Uxbridge Road, Hayes.
- iii) Within the service road fronting Hayes End Parade outside Nos. 1302 to 1306 Uxbridge Road, Hayes.
- iv) At the junction of the service road fronting Hayes End Parade and Hayes End Drive, Hayes
- v) At the western entrance to the service road fronting Hayes End Parade, Uxbridge Road, Hayes.

CHARGES FOR PAY & DISPLAY PARKING BAYS

Parking Period	Standard Charge	HillingdonFirst Cardholder Tariff
30 minutes	Free(on displaying a ticket)	Free(on displaying a ticket)
60 minutes	70p	20p
90 minutes	£1.40	40p
Up to 2 hours	£2.10	60p

Copies of the notice of proposals, proposed Orders together with full details, plans and the Council's statement of reasons for the proposals can be seen at Hayes End Library and by appointment at Civic Centre, Uxbridge during normal office hours until 13th November 2019. Further information can be obtained by telephoning Residents Services on 01895 250461. If you wish to comment on, or object to the proposals please write by 13th November 2019, stating grounds for objection and your home address to Transport & Projects, Residents Services, Civic Centre, Uxbridge, Middlesex UB8 1UW quoting reference 3N/04/HT/23/10/19. Dated this the 23rd day of October 2019.

JEAN PALMER,

Deputy Chief Executive & Corporate Director of Residents Services.

STATEMENT OF REASONS

The proposed amendments will maximise the available parking within the scheme. The proposals have the support of the local Ward Councillors and Cabinet Members.

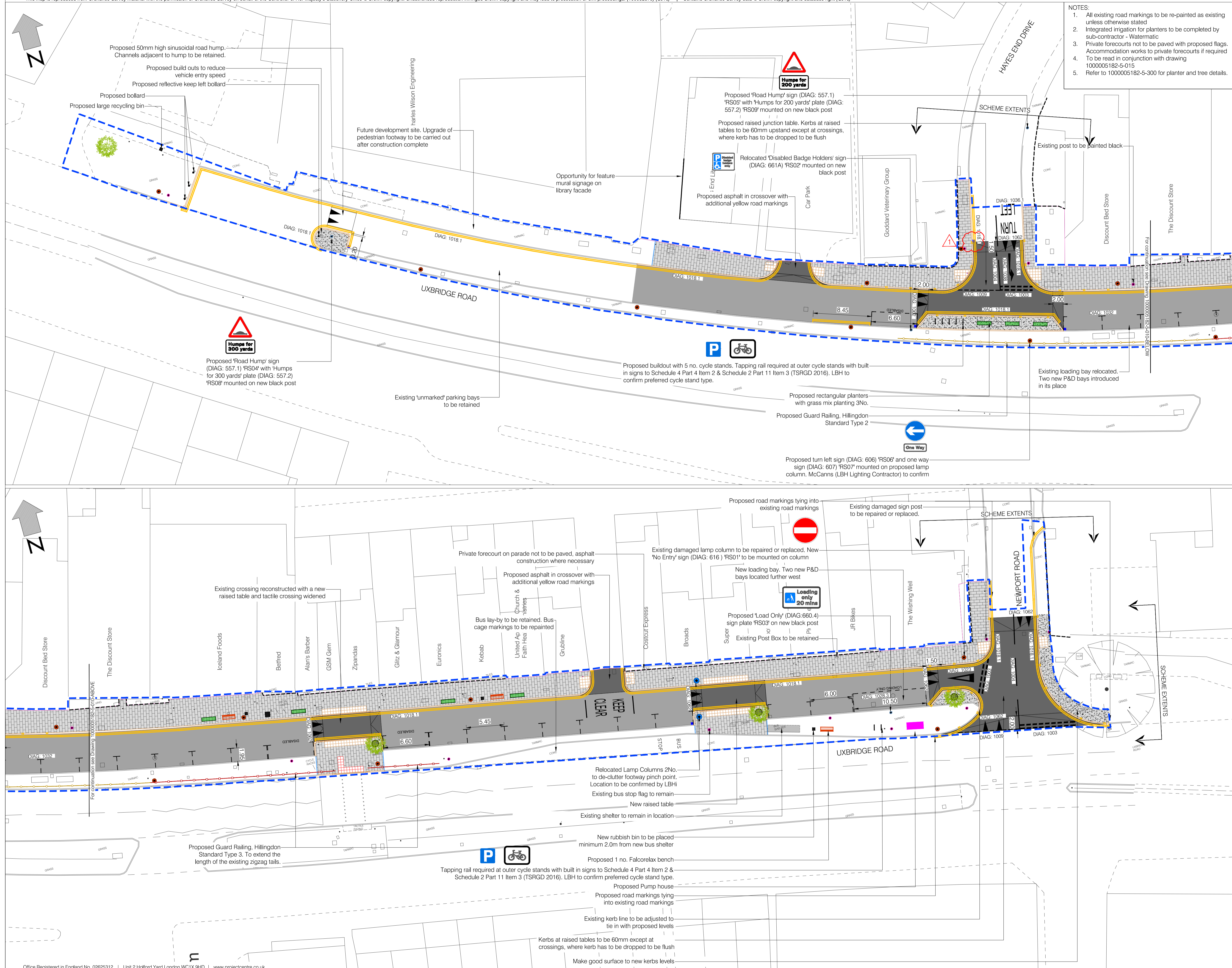

- NOTES:**
- All existing road markings to be re-painted as existing unless otherwise stated
 - Integrated irrigation for planters to be completed by sub-contractor - Watermatic
 - Private forecourts not to be paved with proposed flags. Accommodation works to private forecourts if required 1000005182-5-015
 - To be read in conjunction with drawing 1000005182-5-015
 - Refer to 1000005182-5-300 for planter and tree details.

- LEGEND**
- Proposed large Myriad block paving, various sizes Qty: 664m². Refer to drawing 1000005182-4-015 for details
 - Proposed footway with asphalt surface Qty: 90m². Refer to drawing 1000005182-4-015 for details
 - Proposed asphalt construction for ramps, raised tables and crossovers Qty: 489m². Refer to drawing 1000005182-4-015 for details
 - Proposed resurfaced asphalt carriageway Qty: 855m². Refer to drawing 1000005182-4-015 for details
 - New 400 x 400 x 65 mm PCC buff tactile paving for uncontrolled crossings Qty: 38m²
 - New 400 x 400 x 65 mm PCC red tactile paving for controlled crossings Qty: 5m²
 - Proposed 150x300 wide granite kerb Qty: 370m
 - Proposed 150x300 wide granite dropped kerb
 - Proposed 50x150mm PPC edging Qty: 13m
 - Proposed black post Qty: 3No.
 - Existing post - To be retained and painted black
 - Proposed lamp column - Refer to council lighting team Qty: 2No.
 - Existing lamp column - To be retained and painted black
 - Proposed bench - FalcoRelax bench Qty: 3No.
 - Proposed rectangular planter - Acuario Precious Stone Planter Qty: 7No.
 - Existing rubbish bin to be replaced with Glasdon Brunel Bins - with stubbers, Firexpire® Fire Safety Device and Hillingdon logo Qty: 4No.
 - Large Recycling bin Qty: 1No.
 - Proposed bollard Qty: 3No. (Type to be confirmed by LBH)
 - Proposed reflective bollard Qty: 1No.
 - Proposed gully Qty: 5No.
 - Proposed New Sheffield cycle stand galvanised finish 1000x1300mm Qty: 7No.
 - Proposed tree (positions indicative, size/type to be agreed) Qty: 1No.
 - Proposed trees within circular planters Qty: 3No. - TBC species - Glove Planter (Ø1500mm) (Ebony Black) - Integrated irrigation
 - Proposed guard railing standard Hillingdon type 2 Qty: 46m
 - Proposed guard railing standard Hillingdon type 3 Qty: 37m
 - Proposed ramp
 - Limit of works
 - Private boundary

1	04/06/2019	ADDITIONAL GULLY	JES	ADI	ADu
0	18/04/2019	ORIGINAL ISSUE	AS	SM	AD
Rev	Date	Description	Dm	Chk	App

PROJECT CENTRE

Unit 2 Holford Yard
London WC1X 9HD
Tel: 0330 0080 855
Mail: info@projectcentre.co.uk
Web: www.projectcentre.co.uk
FS 77166

Client: **HILLINGDON** LONDON

Project: **HAYES END PARADE**
UXBRIDGE ROAD

Drawing Title: **GENERAL ARRANGEMENT**
SHEET 1 OF 1

Drawing Status: **FOR CONSTRUCTION**

Drawn	JES	Designed	SD	Date	FEB 2019	Scale	1:250	Size	A1	
Drawing No.	1000005182-5-010-01								Rev	1

LONDON BOROUGH OF HILLINGDON

THE HILLINGDON (PRESCRIBED ROUTES) (NO.) TRAFFIC ORDER 2019

Hillingdon Council gives notice that it proposes to make this Order which will **introduce a 7.5T weight limit except for access on Ladygate Lane, Ruislip between the junctions of Whiteheath Avenue and St Margarets Road**. A copy of the notice of proposals, proposed Order together with full details, a plan and the Council's statement of reasons for the proposals can be seen at Manor Farm Library and by appointment at Civic Centre, Uxbridge during normal office hours until 13th November 2019. Further information can be obtained by telephoning Residents Services on 01895 558391. If you wish to comment on, or object to the proposals please write by 13th November 2019, stating grounds for objection and your home address to Transport & Projects, Residents Services, Civic Centre, Uxbridge, Middlesex UB8 1UW quoting reference 3N/04/SW/23/10/19.

Dated this the 23rd day of October 2019.

JEAN PALMER,

Deputy Chief Executive & Corporate Director of Residents Services.

STATEMENT OF REASONS

The proposed weight restriction is intended to enhance road safety along Ladygate Lane, Ruislip

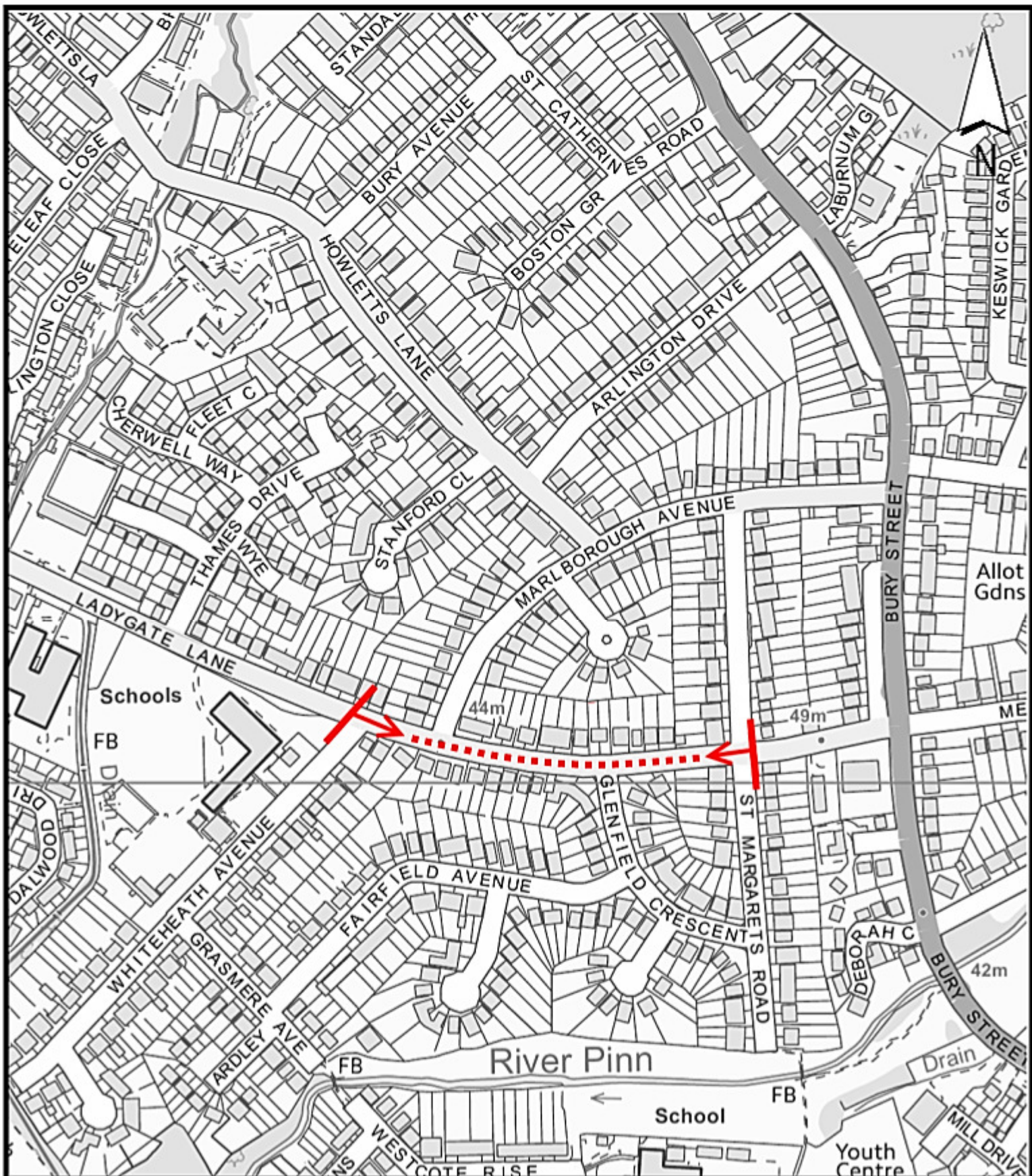

Ladygate Lane, Ruislip Proposed 7.5t weight limit

October 2019

Scale 1:4,000



Proposed 7.5t weight limit on Ladygate Lane
except for access between the junctions of
St Margarets Road and Whiteheath Avenue.



LONDON BOROUGH OF HILLINGDON
THE HILLINGDON (WAITING AND LOADING RESTRICTION) (CONSOLIDATION)
ORDER 1994 (AMENDMENT) ORDER 2019
THE HILLINGDON (HILLINGDON HOSPITAL) (RESIDENTS ZONE HH)
(ON STREET PARKING PLACES) (CONSOLIDATION) ORDER 2019
THE HILLINGDON (HILLINGDON HILL)(RESIDENTS ZONE HN1) (ON-STREET PARKING PLACES)
(AMENDMENT) ORDER 2019
THE HILLINGDON (NORTH HILLINGDON) (ON STREET PARKING PLACES)(ZONE NH) ORDER 2019
THE HILLINGDON (ON STREET PARKING PLACES) (SOUTH RUISLIP) (RESIDENTS) ZONES SR
& SR2 (AMENDMENT) ORDER 2019

Hillingdon Council gives notice that it proposes to make these Orders which will:

1. Remove the following sections of permit holder parking places to facilitate the installation of new or extended vehicle crossings:

- i) Remove a section of Zone SR parking place outside No. 93 Wingfield Way, Ruislip and replace with 'at any time' waiting restrictions.
- ii) Remove a section of Zone SR parking place outside No. 18 Cavendish Avenue, Ruislip and replace with 'Monday to Friday 9am to 5pm' waiting restrictions.
- iii) Remove a section of Zone E2 parking place outside No. 349 Field End Road, Ruislip and replace with 'Monday to Saturday 9am to 5pm' waiting restrictions.
- iv) Remove a section of Zone HH parking place outside No. 1 Peel Way, Hillingdon and replace with 'at any time' waiting restrictions.
- v) Remove a section of Zone HH parking place outside No. 29 Lavender Road, Hillingdon and replace with 'Monday to Friday 9am to 5pm' waiting restrictions.

2. Extend the Zone SR permit holder parking place outside No. 11 Masson Avenue, Ruislip northeastwards for a new total bay length of 12.9 metres.

3. Swap the positions of the goods vehicle loading only bay and shared used pay and display or permit holder parking place within the service road fronting Nos. 299 to 323 Long Lane, Hillingdon.

4. Revise the previously advertised extension to the Hillingdon Hospital Parking Management Scheme in Bramble Close, Hillingdon as follows:

- i) Extend the previously proposed Zone HH permit holder parking place outside Nos. 1 and 3 Bramble Close further across the frontage of No. 3.
- ii) Propose an additional Zone HH permit holder parking place outside No. 20 Bramble Close.

5. Extend the permit holder parking place outside No. 72 Hillingdon Hill utilising a section of footway to be reinstated outside No. 74 Hillingdon Hill, Uxbridge to ensure that there is no overall loss in parking space when the adjacent parking place is reduced to accommodate a new vehicle crossing.

6. Install double yellow lines at the junction of Dawlish Drive and Dulverton Road, Ruislip.

Copies of the notice of proposals, proposed Orders together with full details, plans and the Council's statement of reasons for the proposals can be seen at Eastcote, Manor Farm, Oak Farm, South Ruislip, Uxbridge and Yiewsley libraries and by appointment at Civic Centre, Uxbridge during normal office hours until 13th November 2019. Further information can be obtained by telephoning Residents Services on 01895 250631. If you wish to comment on, or object to the proposals please write by 13th November 2019, stating grounds for objection and your home address to Transport & Projects, Residents Services, Civic Centre, Uxbridge, Middlesex UB8 1UW quoting reference 3N/04/23/10/19.

Dated this the 23rd day of October 2019.

JEAN PALMER,

Deputy Chief Executive & Corporate Director of Residents Services.

STATEMENT OF REASONS

The proposed removal of parts of existing permit holder parking places are intended to provide clear access to new off-street parking areas being created.

The proposed extension of the Zone SR permit holder parking place outside No. 11 Masson Avenue, Ruislip is intended to provide addition parking for residents and their visitors.

The proposed amendments within the service road fronting Nos. 299 to 323 Long Lane, Hillingdon will help assist access to the new development.

The amendments to the previously advertised extension to the Hillingdon Hospital Parking Management Scheme in Bramble Close are as a direct result of the comments made by residents during the previous consultation. The amendments are intended to provide additional parking for residents.

The proposed extension of the parking outside No. 72 & 74 Hillingdon Hill, Uxbridge is intended to off-set the loss of parking when a new vehicle crossing is constructed outside No. 74 Hillingdon Hill.

The proposed double yellow lines at the junction with Dawlish Drive and Dulverton Road, Ruislip are intended to prevent obstructive parking and promote road safety.

Remove a section of Zone SR permit holder parking place outside No. 93 Wingfield Way, Ruislip. Replace with 'at any time' waiting restrictions to facilitate the installation of a new vehicle crossing.

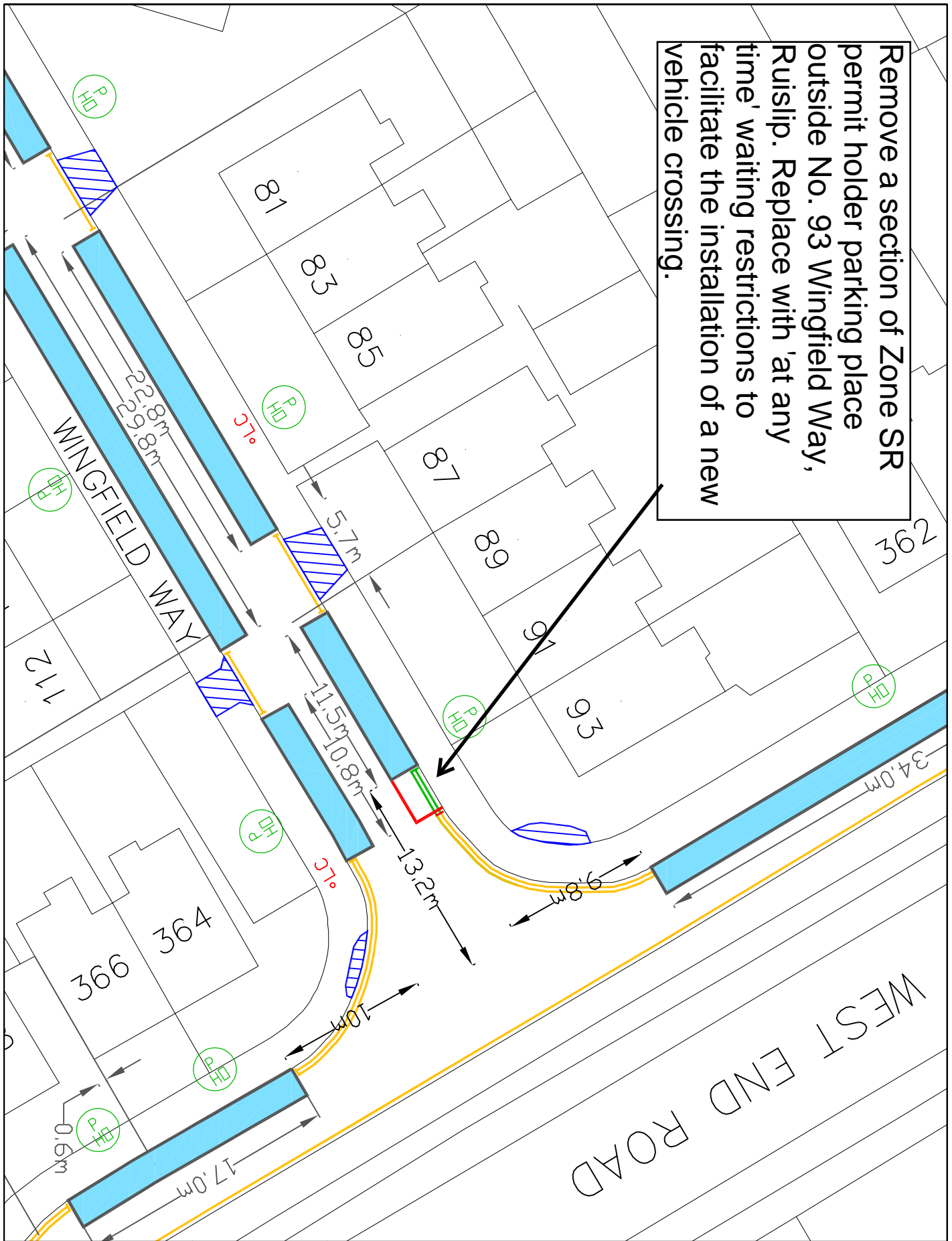

- KEY**
- EXISTING YELLOW LINE
 - BURN OFF ROAD MARKING
 - PROPOSED DOUBLE YELLOW LINE
 - PERMIT HOLDER ONLY BAY
 - CROSSOVER
 - PERMIT HOLDER SIGN

This map is based upon Ordnance Survey material with the permission of Ordnance Survey on behalf of the Controller of Her Majesty's Stationery Office. Ordnance Survey copyright and any other copyright or other proceedings or London Borough of Hillingdon 100019283 ©2019



TRANSPORT & PROJECTS
RESIDENTS SERVICES DIRECTORATE
ONE CENTRE 44/05, MAIN STREET, URBAN2, UB8 3UH
Tel No: 01895 271000/01895 288716

93 Wingfield Way, Ruislip
Dropped kerb amendments

Scale: From: **NTS** (Not To Scale)
Date: **KU 18/09/19**

Appendix B

Remove a section of Zone SR permit holder parking place outside No. 18 Cavendish Avenue, Ruislip. Replace with 'Monday to Friday 9am to 5pm' waiting restrictions to facilitate the installation of a new vehicle crossing.

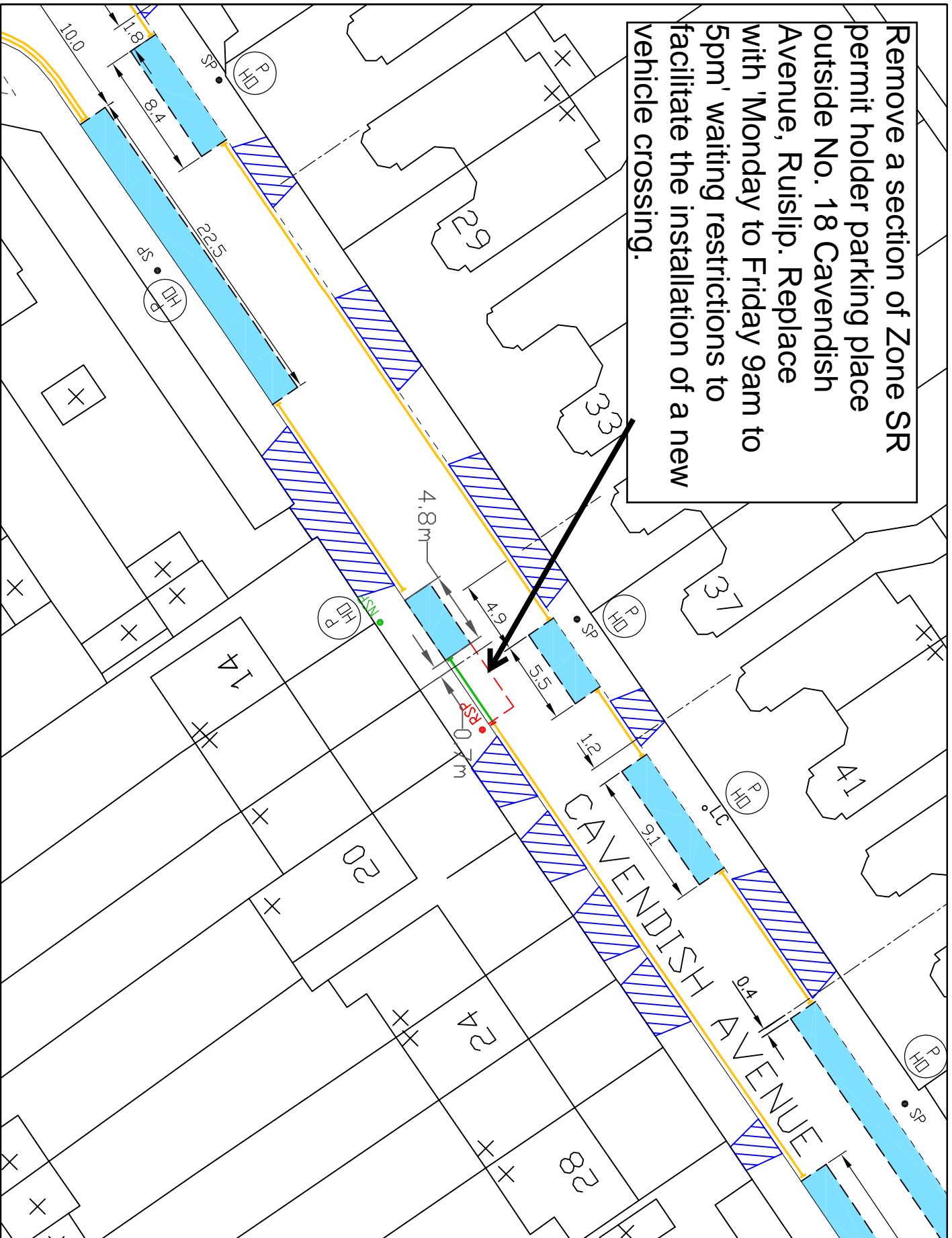

- KEY**
- EXISTING YELLOW LINE
 - BURN OFF ROAD MARKING
 - SLOTTED
 - PROPOSED SINGLE YELLOW LINE
 - PERMIT HOLDER ONLY BAY
 - CROSSOVER
 - PERMIT HOLDER SIGN

This map is based upon Ordnance Survey material with the permission of Ordnance Survey on behalf of the Controller of the Highway (as defined in the Road Traffic Act 1988) and the Ordnance Survey. All other copyright and any other material contained herein is the property of Hillingdon London Borough Council. ©2019



TRANSPORT & PROJECTS
RESIDENTS SERVICES DIRECTORATE
 CIVIC CENTRE 44/46A, MAIN STREET, URBANAGE, UB8 3UH
 TEL: 01895 271000/01895 258976

Project
18 Cavendish Avenue, Ruislip

Proposed amendments

Scale: **NTS** (Not To Scale)

From: **KU 18/09/19**

Remove a section of Zone E2 permit holder parking place outside No. 349 Field End Road, Eastcote. Replace with 'Monday to Saturday 9am to 5pm' waiting restrictions to facilitate the installation of a vehicle crossing extension.

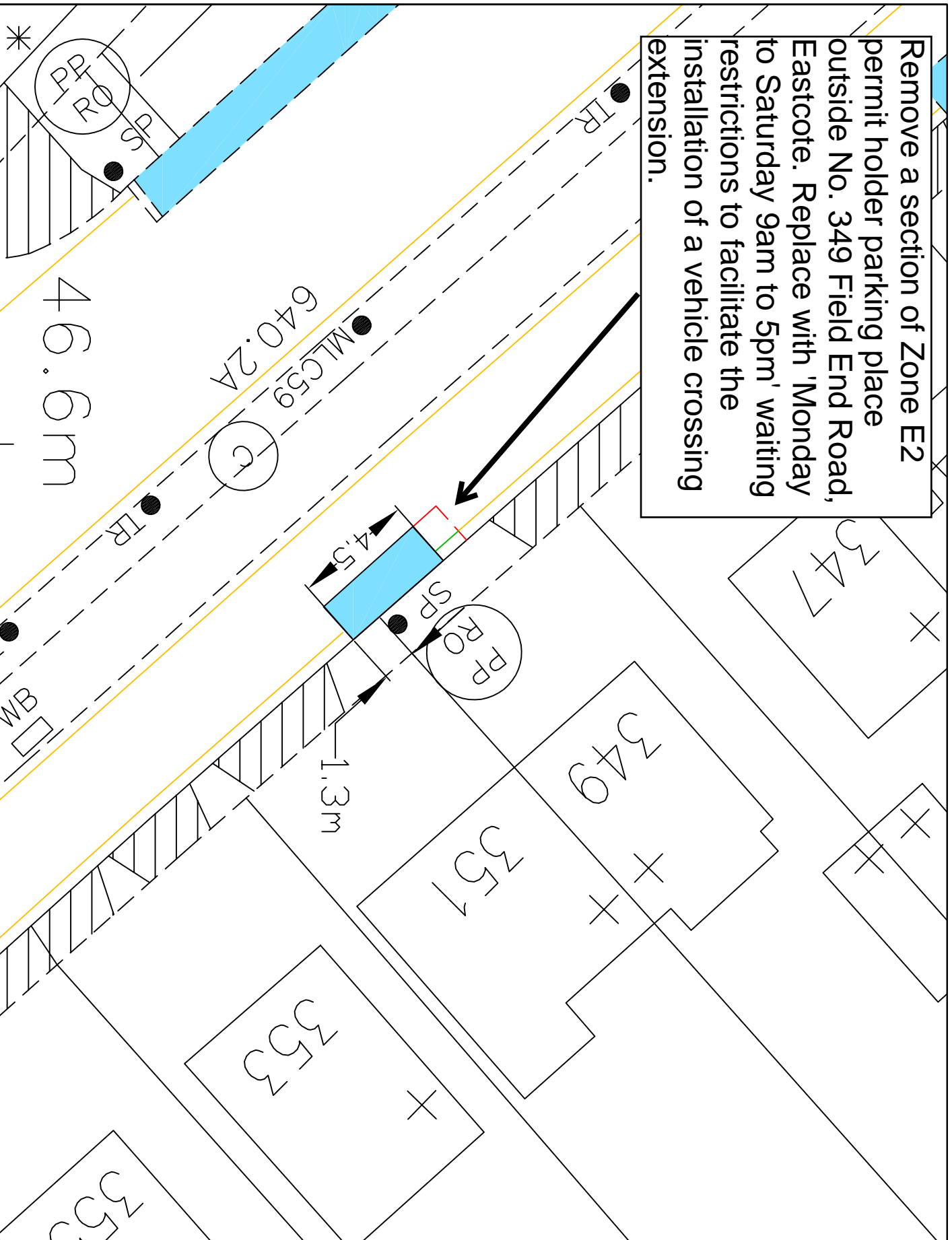

- KEY**
- EXISTING YELLOW LINE
 - BURN OFF ROAD MARKING
 - SMT PROPOSED SINGLE YELLOW LINE
 - PERMIT HOLDER ONLY BAY
 - CROSSOVER
 - SP SIGNPOST
 - LC LAMP COLUMN
 - RP PERMIT HOLDER SIGN

This map is based upon Ordnance Survey material with the permission of Ordnance Survey on behalf of the Controller of Her Majesty's Stationery Office. All Crown Copyright. Copyright © 2019. All rights reserved. No part of this publication may be reproduced, stored in a retrieval system or transmitted in any form or by any means, electronic, mechanical, photocopying, recording or otherwise, without the prior written permission of the Controller of Her Majesty's Stationery Office. ©2019 London Borough of Hillingdon 100019283



TRANSPORT & PROJECTS
RESIDENTS SERVICES DIRECTORATE
 CIVIC CENTRE 44/05, HIGH STREET, UXTON, URB 11W
 TEL: 01895 271000/01895 288710

**349 Field End Road,
 Eastcote**

Description	
New dropped kerb amendments	
Scale	Form
NTS	KU 19/09/19

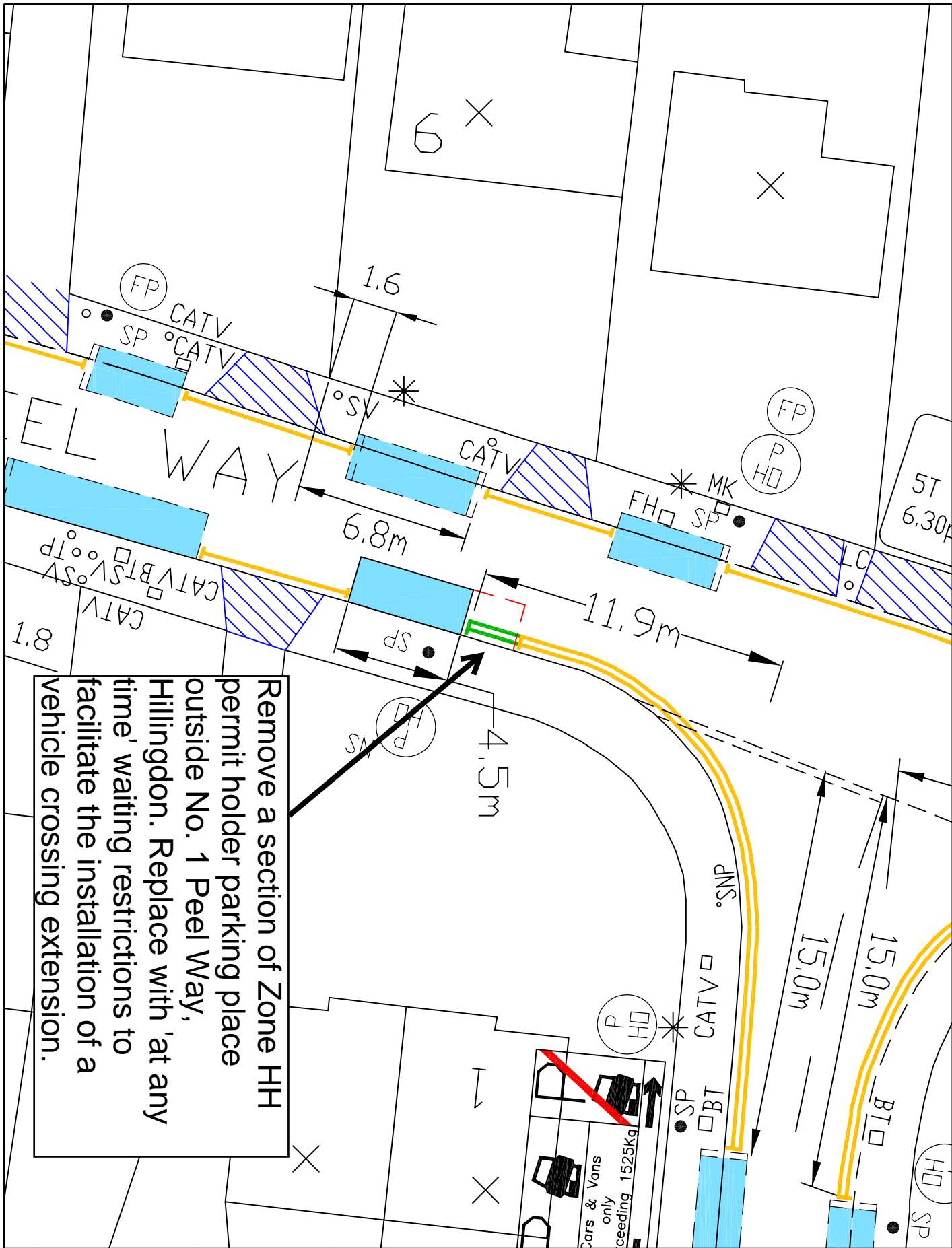

Remove a section of Zone HH permit holder parking place outside No. 1 Peel Way, Hillingdon. Replace with 'at any time' waiting restrictions to facilitate the installation of a vehicle crossing extension.

- KEY**
- EXISTING YELLOW LINE
 - BURN OFF ROAD MARKING
 - SMTI
 - PROPOSED SINGLE YELLOW LINE
 - PERMIT HOLDER ONLY BAY
 - CROSSOVER
 - SP SIGNPOST
 - OLC LAMP COLUMN
 - PH PERMIT HOLDER SIGN

This map is based upon Ordnance Survey material with the permission of Ordnance Survey on behalf of the Controller of the Copyright. No liability is accepted by the copyright owner for any error or omission on the part of the copyright owner or for any loss or damage caused by the use of the information contained on this map.

London Borough of Hillingdon 100019283 ©2019



HILLINGDON
LONDON

TRANSPORT & PROJECTS
RESIDENTS SERVICES DIRECTORATE
Civic Centre 4th/5th, Main Street, Uxendon, Ux8 1UH
Tel No. 01895 27100/01895 28076

Project
**1 Peel Way,
Hillingdon**

Description
**Dropped kerb
amends**

Scale
NTS

Form Ref
KU 25/09/19

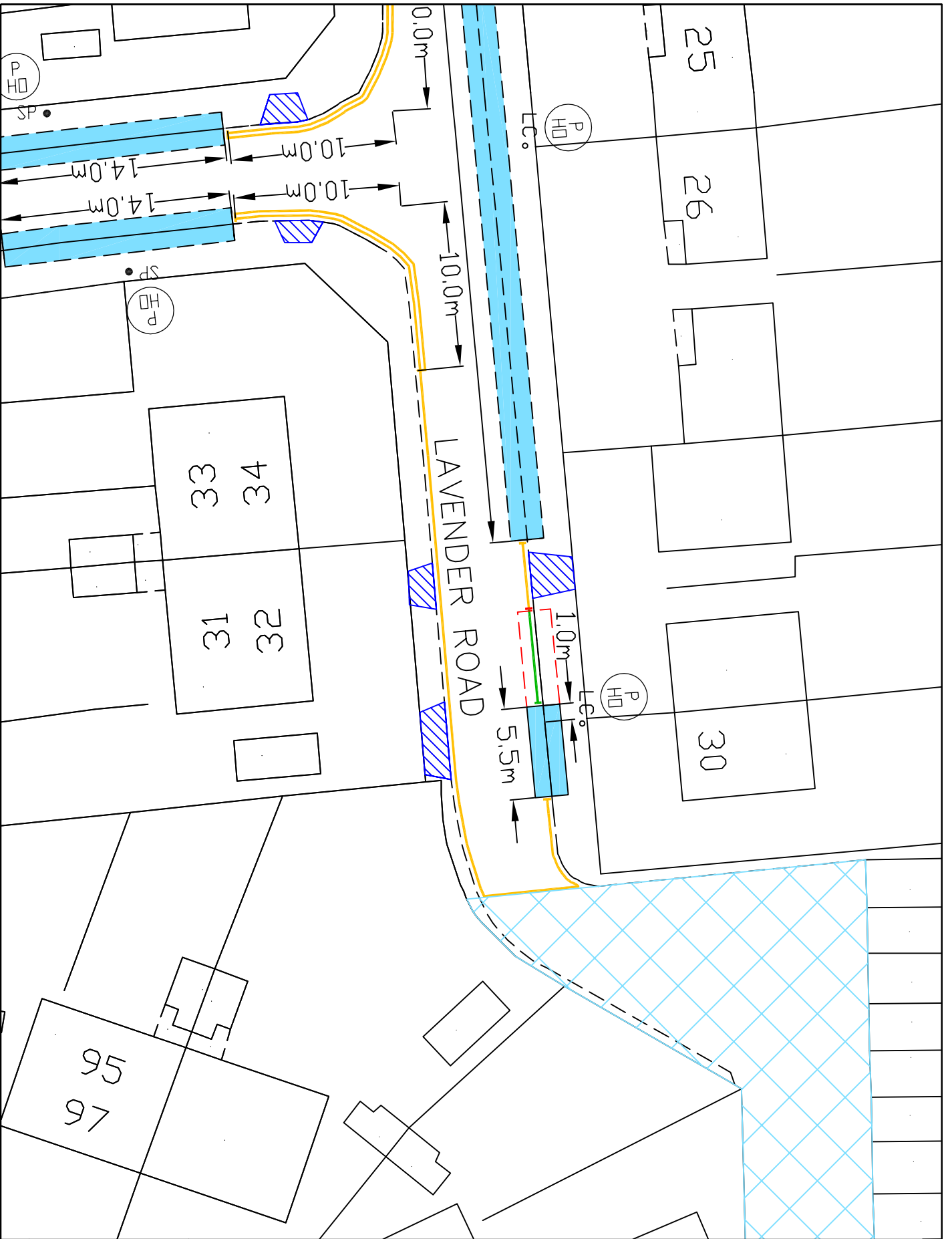

- KEY**
- EXISTING YELLOW LINE
 - BURN OFF ROAD MARKING
 - SMT
 - PROPOSED SINGLE YELLOW LINE
 - PERMIT HOLDER ONLY BAY
 - CROSSOVER
 - SP SIGNPOST
 - OLC LAMP COLUMN
 - PERMIT HOLDER SIGN

This map is based upon Ordnance Survey material with the permission of Ordnance Survey on behalf of the Controller of the Map. It is a Secondary Office Map. Copyright in the material is owned by Ordnance Survey and may lead to prosecution or civil proceedings. London Borough of Hillingdon 100019283 ©2019



TRANSPORT & PROJECTS
RESIDENTS SERVICES DIRECTORATE
ONE CENTRE 44/05, MAIN STREET, UXTON, 188 1UN
TEL: 01895 271000/01895 280710

Project
29 Lavender Road,
Hillingdon

Description
Dropped kerb
amends

Scale
1:1000

Date
19/09/19

Form
KCU

Proposed extension of the Zone SR permit holder parking place outside No. 11 Masson Avenue, Ruislip.

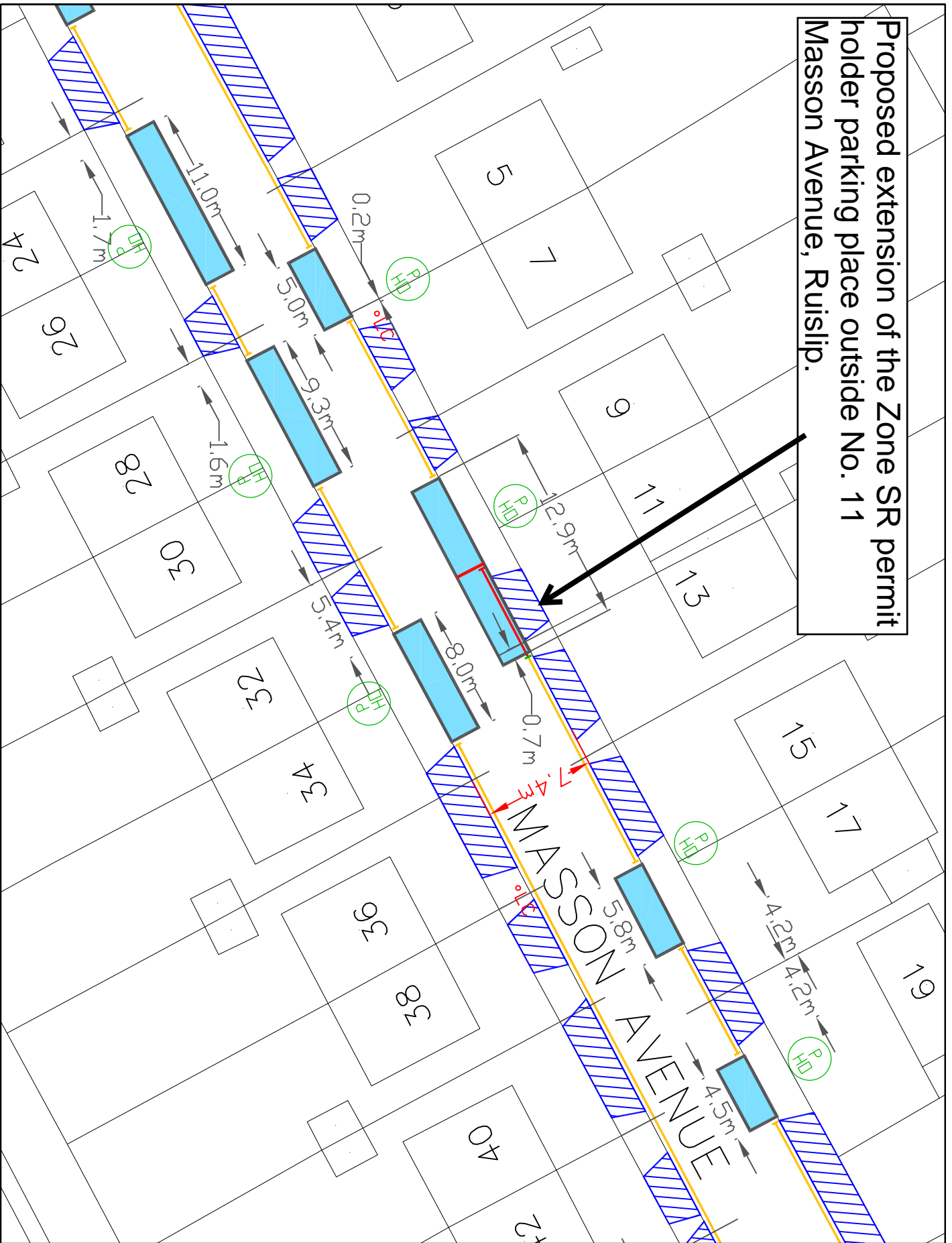

- KEY**
- EXISTING YELLOW LINE
 - BURN OFF ROAD MARKING
 - PROPOSED SINGLE YELLOW LINE TERMINAL
 - PERMIT HOLDER ONLY BAY
 - CROSSOVER
 - PERMIT HOLDER SIGN

This map is based upon Ordnance Survey material with the permission of Ordnance Survey on behalf of the Controller of Her Majesty's Stationery Office. All rights reserved. No part of this publication may be reproduced, stored in a retrieval system, or transmitted in any form or by any means, electronic, mechanical, photocopying, recording, or by any information storage or retrieval system, without the prior written permission of Ordnance Survey. © 2019 London Borough of Hillingdon



TRANSPORT & PROJECTS
 RESIDENTS SERVICES DIRECTORATE
 CIVIC CENTRE 44/46A, MAIN STREET, UPPONDAZE, UB8 3JW
 TEL: 01895 271000/01895 258076

**11 Masson Avenue,
 Ruislip**

**Extension of
 parking place**

Scale: From: **KU 18/09/19**

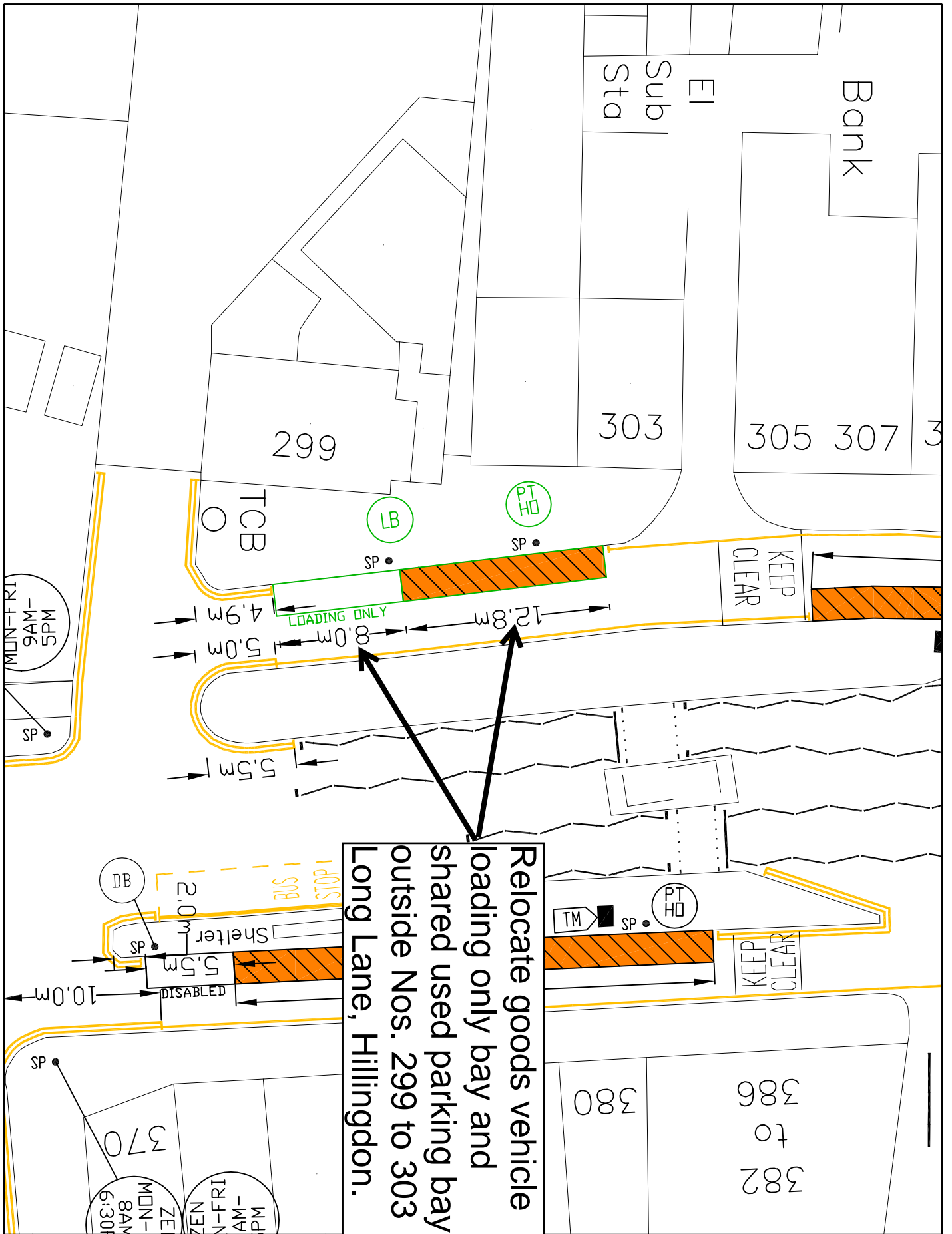

Relocate goods vehicle loading only bay and shared used parking bay outside Nos. 299 to 303 Long Lane, Hillingdon.

- KEY**
- EXISTING YELLOW LINE
 - PAY AND DISPLAY AND PERMIT HOLDERS AND PERMIT HOLDER ONLY BAY
 - PERMIT HOLDER ONLY BAY
 - TICKET MACHINE
 - CROSSOVER
 - SIGNPOST
 - LAMP COLUMN
 - PERMIT HOLDER SIGN
 - ZONE ENTRY SIGN
 - ZONE EXIT SIGN
 - SHARED USE BAY SIGN
 - LOADING ONLY BAY SIGN

This plan is based upon Ordnance Survey material with the permission of Ordnance Survey on behalf of the Controller of Her Majesty's Stationery Office. All rights reserved. No part of this publication may be reproduced, stored in a retrieval system or transmitted in any form or by any means, electronic, mechanical, photocopying, recording or otherwise, without the prior written permission of Ordnance Survey. ©2019 London Borough of Hillingdon 100019283



HILLINGDON
LONDON

TRANSPORT & PROJECTS
RESIDENTS SERVICES DIRECTORATE
ONE CENTRE 44/05, MAIN STREET, URBANAGE, UB8 3JW
Tel No. 01895 271000/01895 258719

**Long Lane,
Hillingdon**

**Proposed
amendments**

Scale: **1:100**
Date: **18/09/19**

MON-FRI
9AM-5PM

DB
2.0m
Shelter
5.5m
DISABLED
10.0m

SP
370
MON-8AM
FRI-5:30

PT HO
SP
TM
KEEP CLEAR

386 to 380
380

299
303
305 307 309
TCB
LB
PT HO
SP
LOADING ONLY
4.9m
8.0m
12.8m
5.0m
5.5m

KEEP CLEAR

KEEP CLEAR

Bank
Sub Sta
EI

Proposed additional permit holder parking places following confirmation from colleagues in Highways that several vehicle crossings in the road are not legitimate.

Parking bays positioned partly on footway where possible.

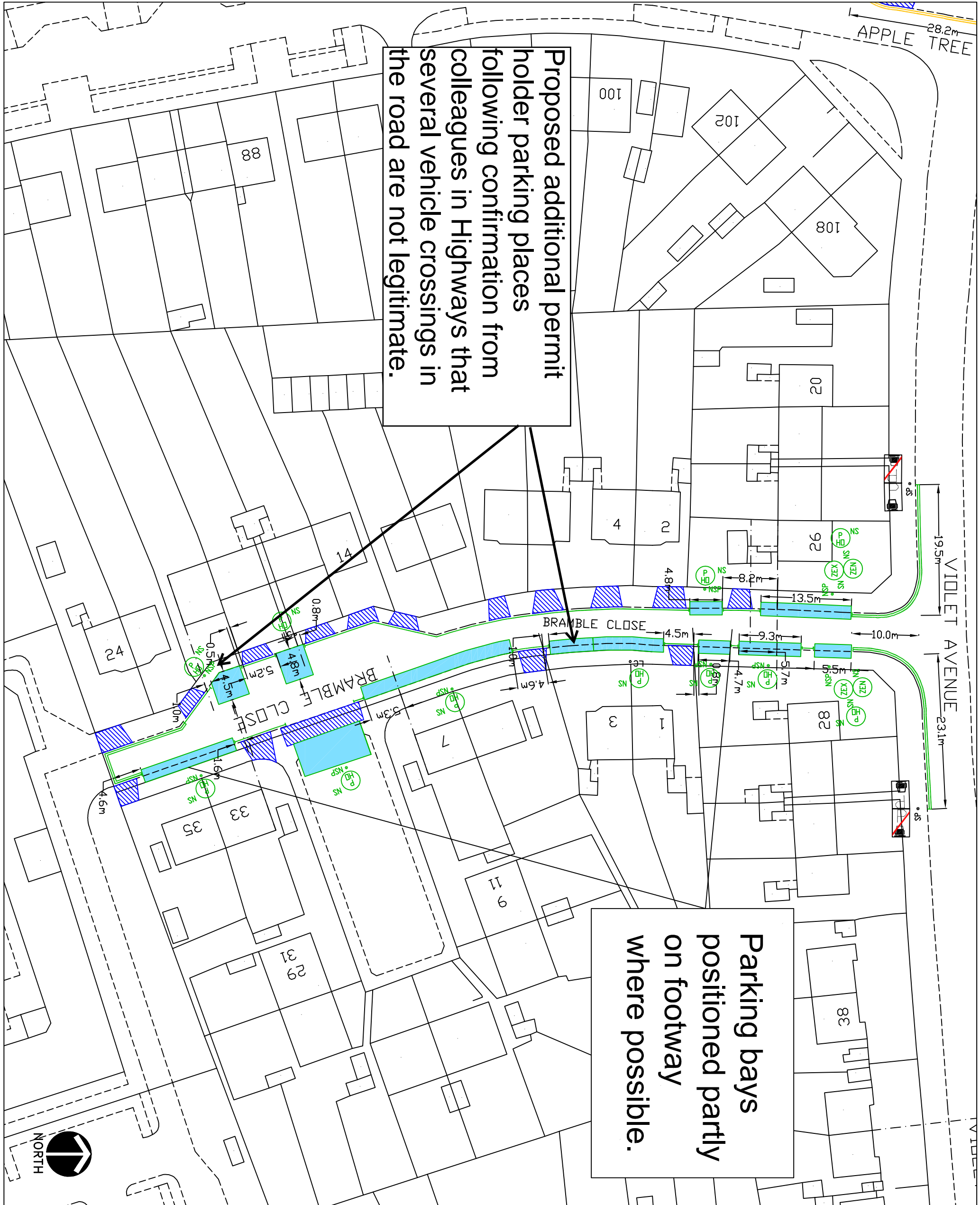

- KEY**
- EXISTING YELLOW LINE
 - BURN OFF ROAD MARKING
 - PROPOSED SINGLE YELLOW LINE OPERATIONAL MONDAY TO FRIDAY 9AM TO 5PM*
 - PROPOSED DOUBLE YELLOW LINE
 - PERMIT HOLDER ONLY BAY OPERATIONAL MONDAY TO FRIDAY 9AM TO 5PM*
 - DMT
 - CROSSOVER SIGNPOST
 - NEW SIGNPOST
 - LAMP COLUMN
 - PERMIT HOLDER ONLY SIGN
 - ZONE ENTRY SIGN
 - ZONE EXIT SIGN

This map is based upon Ordnance Survey material with the permission of Ordnance Survey on behalf of the Controller of Her Majesty's Stationary Office © Crown copyright. Unauthorised reproduction infringes Crown copyright and may lead to prosecution or civil proceedings.
 London Borough of Hillingdon 100019283 ©2019

HILLINGDON
 TRANSPORT & PROJECTS
 RESIDENTS SERVICES DIRECTORATE
 ONE CENTRAL AVENUE, HILLINGDON, LEICESTERSHIRE LE20 9JW
 TEL: 01895 277009 / 01895 250876

Project
 Proposed extension to the Hillingdon Hospital Parking Management Scheme

Description
 Proposed revised layout
 Bramble Close

Scale: NTS
 Designed: KU
 Drawn: KU
 Date: 05/08/19

HILLINGDON HILL

Extend adjacent parking place across reinstated footway to offset the loss of a parking space outside No. 74 Hillingdon Hill, Uxbridge.

Shelter + 50.3m

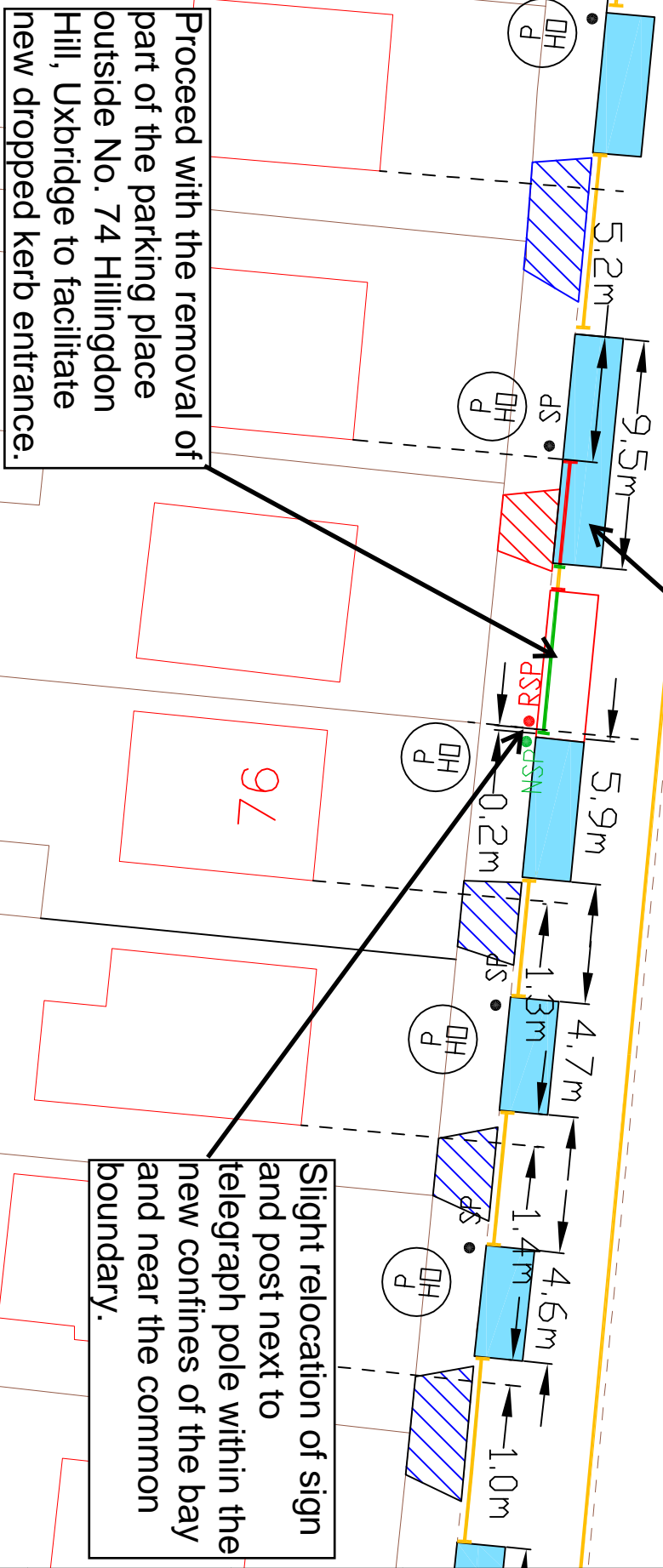

Proceed with the removal of part of the parking place outside No. 74 Hillingdon Hill, Uxbridge to facilitate new dropped kerb entrance.

Slight relocation of sign and post next to telegraph pole within the new confines of the bay and near the common boundary.

KEY

- EXISTING YELLOW LINE
- BURN OFF ROAD MARKING
- SHT
- PROPOSED SINGLE YELLOW LINE
- PERMIT HOLDER ONLY BAY
- CROSSOVER
- SIGNPOST
- OLC LAMP COLUMN
- PERMIT HOLDER SIGN
- ZONE ENTRY SIGN
- ZONE EXIT SIGN

This report is based upon Ordnance Survey material with the permission of Ordnance Survey on behalf of the Controller of Her Majesty's Stationery Office. Crown Copyright. All rights reserved. No part of this report, copyright, and may lead to promotion or other proceedings. London Borough of Hillingdon 100019283 ©2019







TRANSPORT & PROJECTS
RESIDENTS SERVICES DIRECTORATE
ONE CENTRE 44/05, MAIN STREET, UXBRIDGE, URB 11W
Tel No. 01895 271000/01895 250710

**74 Hillingdon Hill,
Hillingdon**

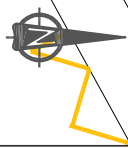
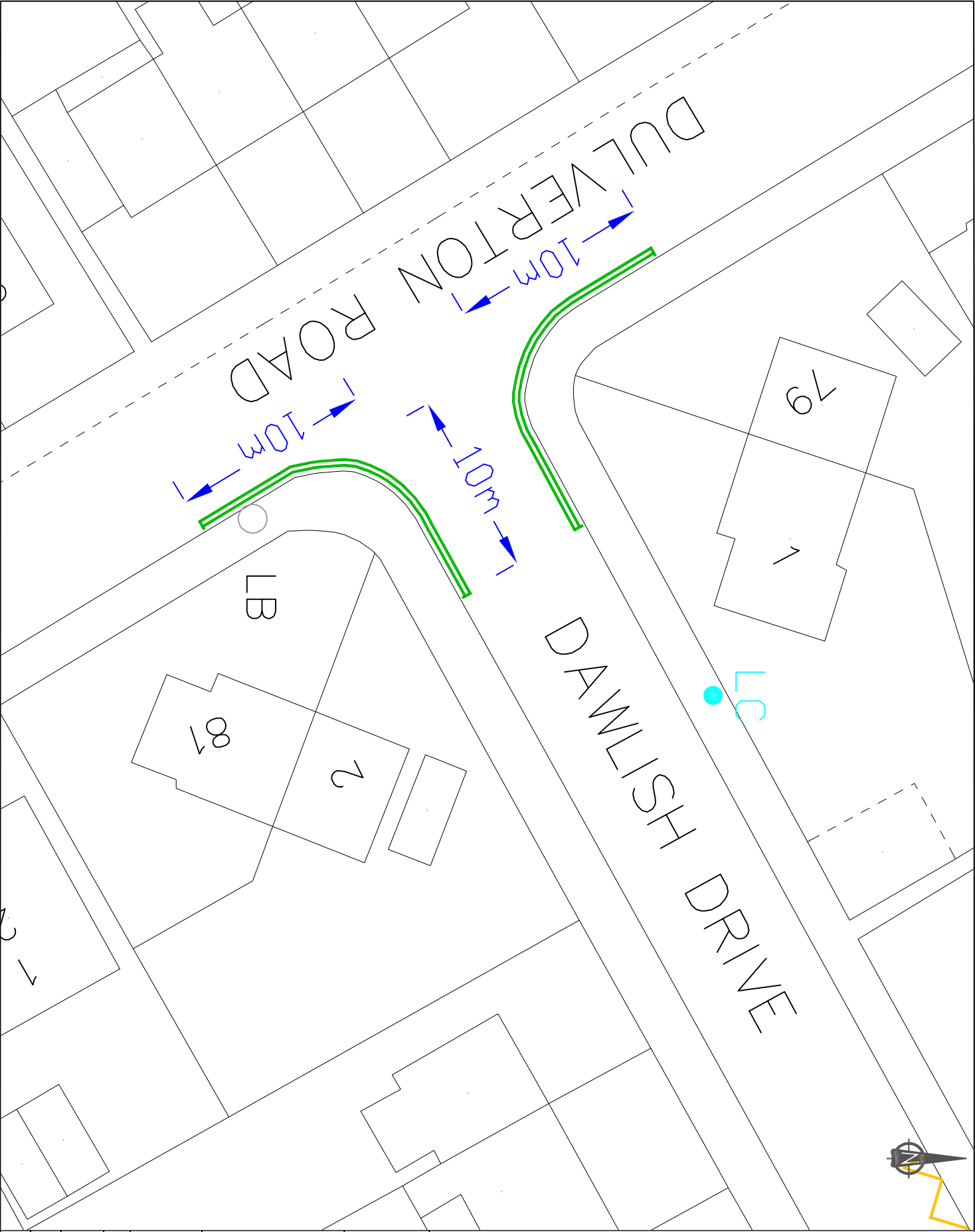
Revised proposals

Scale: **NTS** Date: **KU 05/08/19**



-  Proposed double yellow lines
-  Existing double yellow lines
-  Dropped Kerbs

This map is based upon Ordnance Survey data and is provided for information only. It is not a substitute for a professional survey. The map is provided under a Creative Commons Attribution-NonCommercial-ShareAlike license. All rights reserved. © Crown copyright. Unauthorised reproduction infringes Crown copyright and may lead to prosecution or civil proceedings. London Borough of Hillingdon 100019283 2019

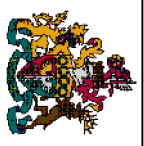

HILLINGDON
LONDON

Project
Road Safety Programme

Source
RSP/CAD drawings/Dawlish Drive

Description
Dulverton Road/Dawlish Drive,
Ruislip

Scale	Drawn	Checked
N.T.S	RC	09/19
Page Size	Drawing No.	Rev.
A4	RSP	