

LONDON BOROUGH OF HILLINGDON
THE HILLINGDON (WAITING AND LOADING RESTRICTION)
(CONSOLIDATION) ORDER 1994 (AMENDMENT) ORDER 2018

Hillingdon Council gives notice that it proposes to make this Order which will **impose 'at any time' waiting and loading restrictions in sections of road as set out in the Schedule of this notice.** A copy of the notice of proposals, proposed Order together with full details, a plan and the Council's statement of reasons for the proposals can be seen at Uxbridge Library and by appointment at, Civic Centre, Uxbridge during normal office hours until 18th July 2018. Further information can be obtained by telephoning Residents Services on 01895 250970. If you wish to comment on, or object to the proposals please write by 18th July 2018, stating grounds for objection and your home address to Transport & Projects, Residents Services, Civic Centre, Uxbridge, Middlesex UB8 1UW quoting reference 3N/04/KR/04010. Dated this the 27th day of June 2018.

JEAN PALMER,

Deputy Chief Executive & Corporate Director of Residents Services.

SCHEDULE 1 - Proposed 'at any time' waiting and loading restrictions

ASHLEY ROAD, UXBRIDGE - Both sides, from the junction with Cowley Mill Road to a point 10 metres southwest of the entrance of the new access being created for the new development.

COWLEY MILL ROAD, UXBRIDGE - Both sides, from a point in line with the common boundary of No. 75 and Atlantic House to a point east of the junction with Wallingford Road next to the width restrictions.

WALLINGFORD ROAD, UXBRIDGE - Both sides, between the junction with Cowley Mill Road, southwards for a distance of 23 metres, encompassing the full extent of the adopted highway.

STATEMENT OF REASONS

The proposed 'at any time' waiting and loading restrictions are intended to prevent obstructive parking and assist with the free flow of traffic whilst promoting road safety.

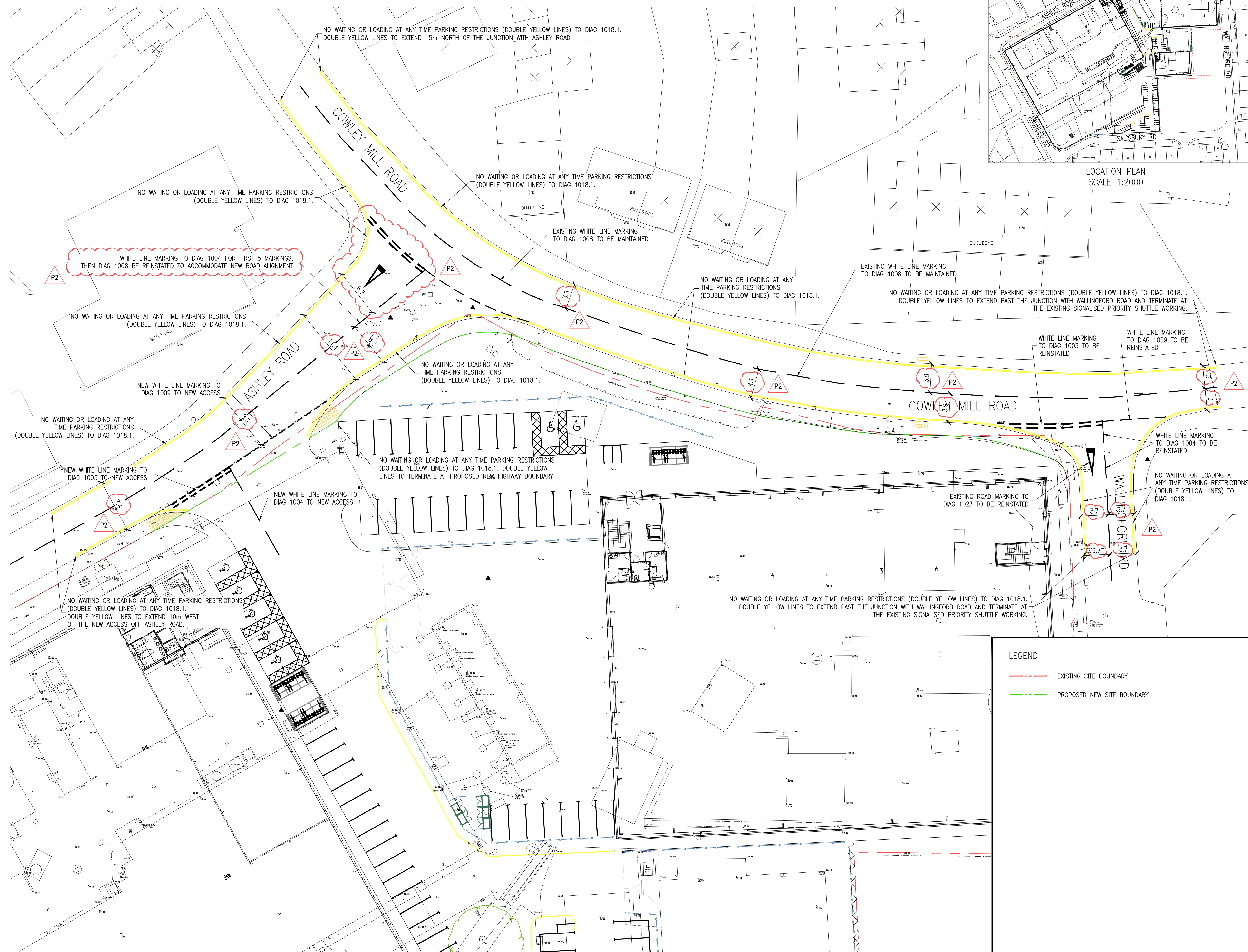
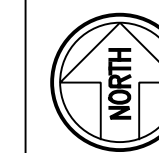
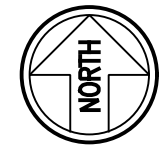

NOTES

1. ALL HIGHWAY WORKS TO BE AGREED WITH THE LOCAL COUNCIL PRIOR TO IMPLEMENTATION ON SITE. APPROPRIATE S278/S38 AGREEMENTS TO BE IN PLACE PRIOR TO THE WORKS COMMENCING (IF REQUIRED).
2. THE CONTRACTOR WILL BE RESPONSIBLE FOR PROVIDING ALL REQUIRED TRAFFIC MANAGEMENT LAYOUT INFORMATION, METHODS OF WORKING AND OPERATIVE ACCREDITATION TO THE COUNCIL ON REQUEST.
3. THE CONTRACTOR WILL BE RESPONSIBLE FOR ALL APPLICATIONS AND NOTIFICATIONS FOR ROAD SPACE BOOKING IN ACCORDANCE WITH THE CURRENT NRSWA.
4. THIS DRAWING IS TO BE READ IN CONJUNCTION WITH ALL RELEVANT ARCHITECTS DRAWINGS, ENGINEER'S DRAWINGS, THE SPECIFICATION, SURVEYS, REPORTS AND ANY PARTY WALL AGREEMENTS AND DOCUMENTATION.
5. ALL WORKMANSHIP AND MATERIALS ARE TO COMPLY WITH THE SPECIFICATION, BUILDING REGULATIONS, RELEVANT BRITISH STANDARD AND MANUFACTURERS RECOMMENDATIONS.
6. THIS DRAWING IS NOT TO BE SCALED. ALL DIMENSIONS ARE IN MM UNLESS NOTED OTHERWISE.
7. THE CONTRACTOR MUST MAKE HIMSELF FAMILIAR WITH THE EXISTING SITE LAYOUT WITH RESPECT TO ACCESS, EXISTING CONSTRUCTION, HEALTH AND SAFETY MATTERS, DRAINAGE BELOW GROUND AND SURFACE LEVEL, PARTY WALL MATTERS, CELLARS/VAULTS ETC. AND MAKE THE CONTRACT ADMINISTRATOR AWARE OF ANY VARIATIONS.
8. THE CONTRACTOR IS RESPONSIBLE FOR MAINTAINING THE STRUCTURAL STABILITY AND INTEGRITY OF ALL THE ADJACENT EXISTING STRUCTURES (EG. BUILDINGS, FOOTPATHS, ROADS, ETC) AND SERVICES TO BE RETAINED DURING THE DEMOLITION WORKS. THE CONTRACTOR MUST DESIGN, PROVIDE AND INSTALL ALL OR ANY TEMPORARY / PERMANENT PROPPING OR BRACING REQUIRED TO ACHIEVE THIS. THE CONTRACTOR MUST PROVIDE A DETAILED METHOD STATEMENT (INCLUDING CALCULATIONS AND DRAWINGS IF APPLICABLE) FOR THESE WORKS.
9. THE CONTRACTOR IS RESPONSIBLE FOR ALL SITE HEALTH AND SAFETY AND SECURITY MATTERS.
10. THIS DRAWING IS TO BE READ IN CONJUNCTION WITH:
 - 10.1. SITECH SURVEYING SERVICES & UTILITY SURVEY 6353 DATED DECEMBER 2013.

EXISTING BELOW GROUND SERVICES & DRAINAGE

1. SITECH SURVEYING SERVICES & UTILITY SURVEY 6353 DATED DECEMBER 2013.
2. THE CONTRACTOR IS RESPONSIBLE FOR ESTABLISHING THE CORRECT LOCATIONS AND ENSURING THAT EACH SERVICE HAS BEEN SAFELY ISOLATED PRIOR TO ITS REMOVAL AND COMMENCEMENT OF THE WORKS.

LEGEND

- EXISTING SITE BOUNDARY
- PROPOSED NEW SITE BOUNDARY

Rev	Date	Description
P2	DH 23.10.17	AMENDED AS CLOUDED. ADDED DIMENSIONS AS REQUESTED BY COUNCIL
P1	MM 14.07.16	ISSUED FOR APPROVAL

Kingston Office
 1st Floor, Neville House
 55 Eden Street
 Kingston upon Thames
 Surrey, KT1 1BW
 United Kingdom
 Tel: 020 8339 9006
 Email: info@bradbrookconsulting.com
 Web: www.bradbrookconsulting.com

Civil & Structural Engineers
 Kingston, London, Dubai, Qatar



Client
MENTMORE INVESTMENTS

Job Site
**ASHLEY ROAD
 LUXBRIDGE**

Drawing Title
**HIGHWAY WORKS
 ROAD MARKING LAYOUT**

Purpose of Issue
 Information Preliminary Approval Tender Construction Record Copy

Date	Drawn	Scale	Checked
28.10.16	DH	1:200 @ A1	GS

Drawing No.	Rev
15-129 / 423	P2