

LONDON BOROUGH OF HILLINGDON
THE HILLINGDON (WAITING AND LOADING RESTRICTION)
(CONSOLIDATION) ORDER 1994 (AMENDMENT) ORDER 2017
THE HILLINGDON (ON STREET PARKING PLACES)(WEST DRAYTON/YIEWSLEY)
(RESIDENTS) ZONES WD1, WD2, WD3, WD4 (AMENDMENT) ORDER 2017

Hillingdon Council gives notice that it proposes to make these Orders which will:

1. Impose 'at any time' waiting restrictions in sections of road as set out in the Schedule to this notice.

2. Reduce the length of the previously proposed Zone WD1 permit holder parking place outside No. 37 Ruffle Close, West Drayton to 6 metres.

Copies of the notice of proposals, proposed Orders together with full details, plans and the Council's statement of reasons for the proposals can be seen at Botwell Green, Harlington and West Drayton libraries and by appointment at, Civic Centre, Uxbridge during normal office hours until 2nd August 2017. Further information can be obtained by telephoning Residents Services on 01895 558294. If you wish to comment on, or object to the proposals please write by 2nd August 2017, stating grounds for objection and your home address to Transport & Projects, Residents Services, Civic Centre, Uxbridge, Middlesex UB8 1UW quoting reference 4W/06/12/7/17.

Dated this the 12th day of July 2017.

JEAN PALMER,

Deputy Chief Executive & Corporate Director of Residents Services.

SCHEDULE

PROPOSED 'AT ANY TIME' WAITING RESTRICTIONS

WATERSPLASH LANE, HAYES - The full extent of Watersplash Lane.

LAUREL LANE, WEST DRAYTON - At the junction with Berberis Walk.

BERBERIS WALK, WEST DRAYTON

- i) At the junction with Laurel Lane.
- ii) On the corner outside and adjacent to No. 1 Berberis Walk.

STATEMENT OF REASONS

The proposed waiting restrictions are intended to remove obstructive parking to improve road safety and promote the free flow of traffic.

The proposed reduction of the previously proposed parking place outside Nos. 37 and 39 Ruffle Close is in response to comments received as part of the previous formal consultation for an extension to the West Drayton Parking Management Scheme.

Watersplash Lane, Hayes Proposals

Item 1

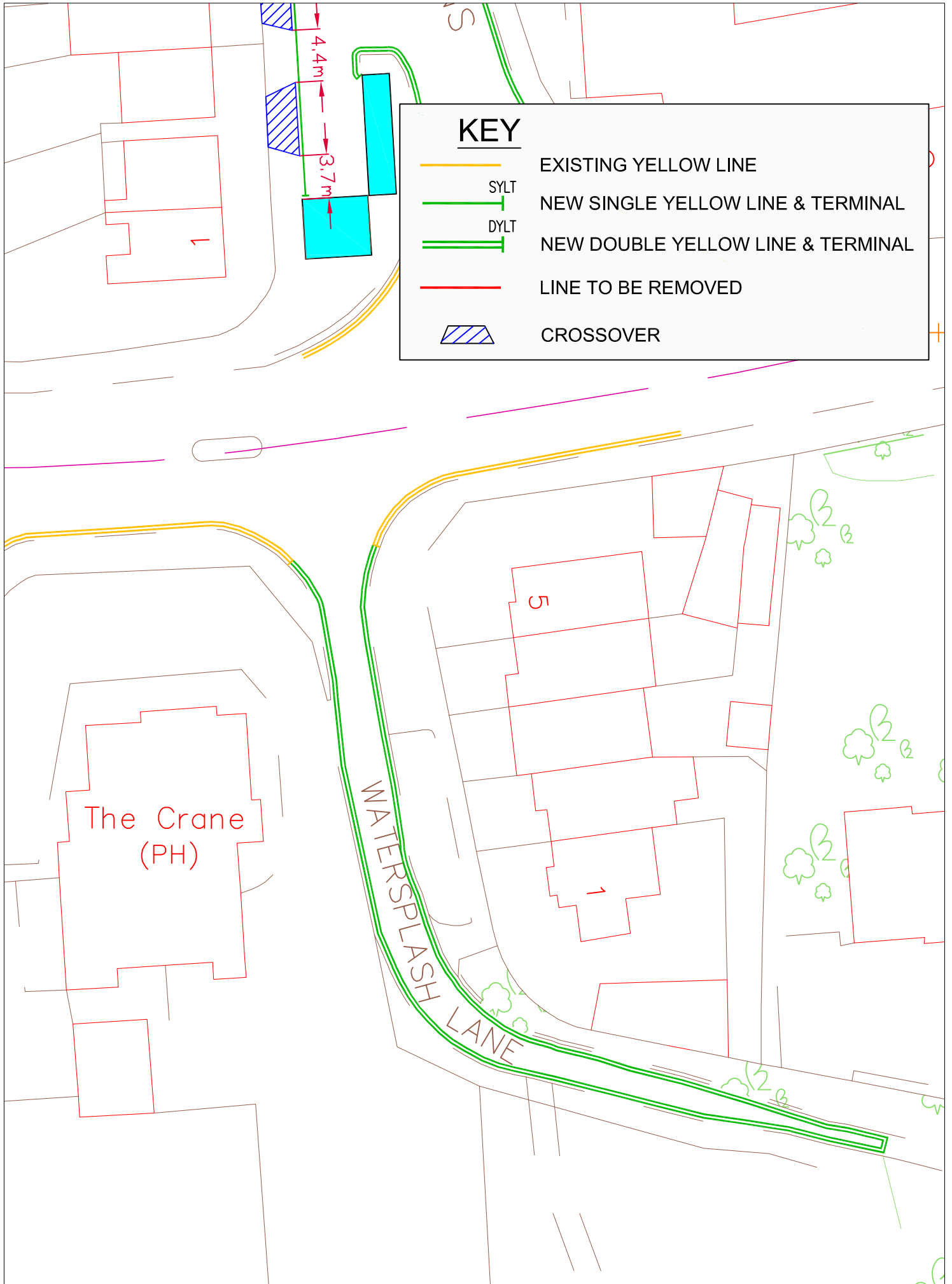

Items 2 & 3

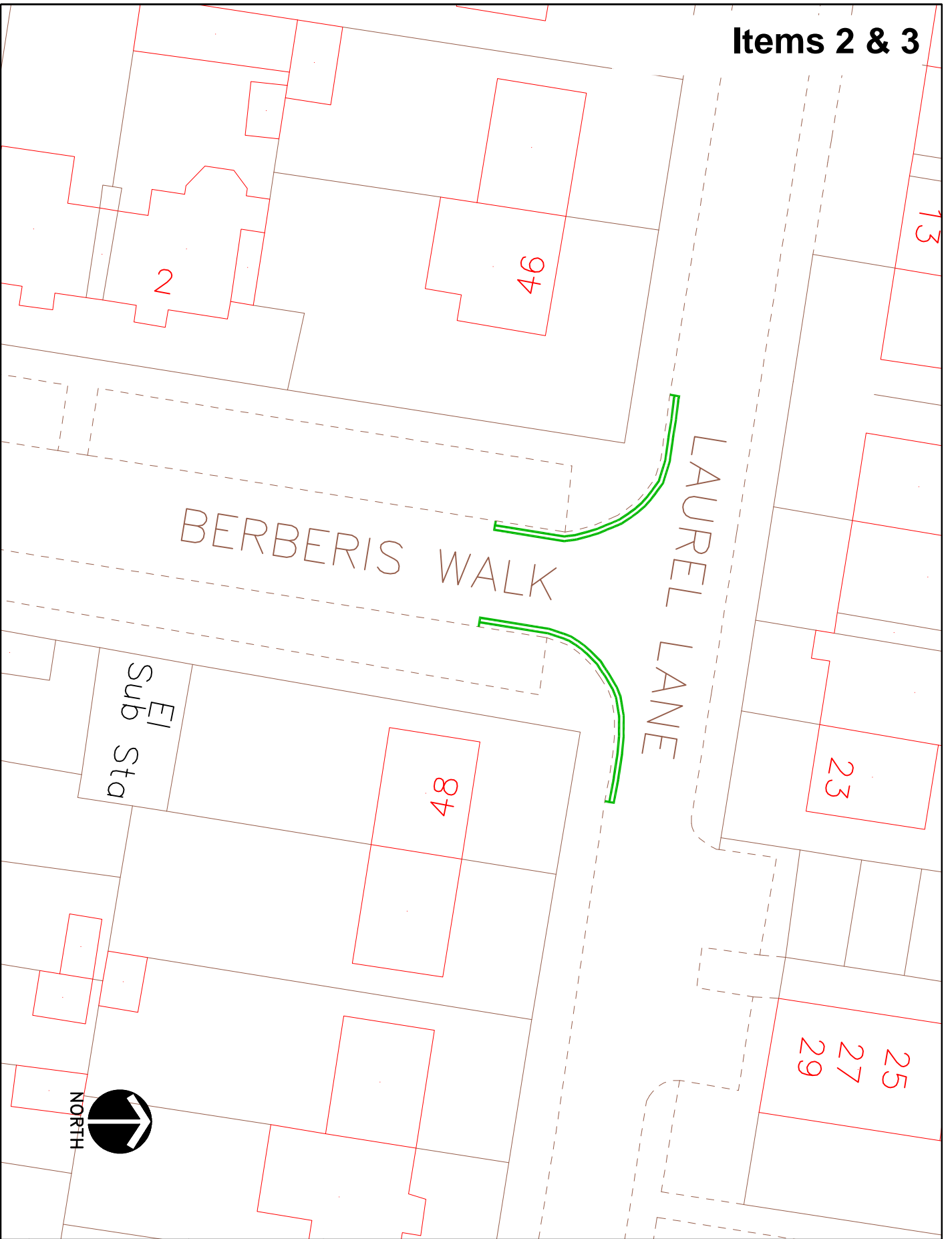

KEY	
	EXISTING YELLOW LINE
	DWT NEW DOUBLE YELLOW LINE & TERMINAL
	S/T NEW SINGLE YELLOW LINE & TERMINAL

This map is based upon Ordnance Survey material with the permission of Ordnance Survey on behalf of the Controller of Her Majesty's Stationery Office. All Crown Copyright. This map is published with the permission of the copyright and may lead to prosecution or other proceedings.
London Borough of Hillingdon 100019283 ©2011



HILLINGDON
LONDON
TRANSPORT & PROJECTS
PLANNING, ENVIRONMENT, EDUCATION
AND COMMUNITY SERVICES DIRECTORATE
ONE CENTRE ROAD, UXTON, MIDDLESEX, UK
Tel: No. 01895 272005/01895 258576

Project
Laura Lane /
Berberis Walk
Junction

Description
DYLs to improve ease of
access.

Scale
Drawn (initials/date)
GH/05MAY17

Item 3



BERBERIS WALK

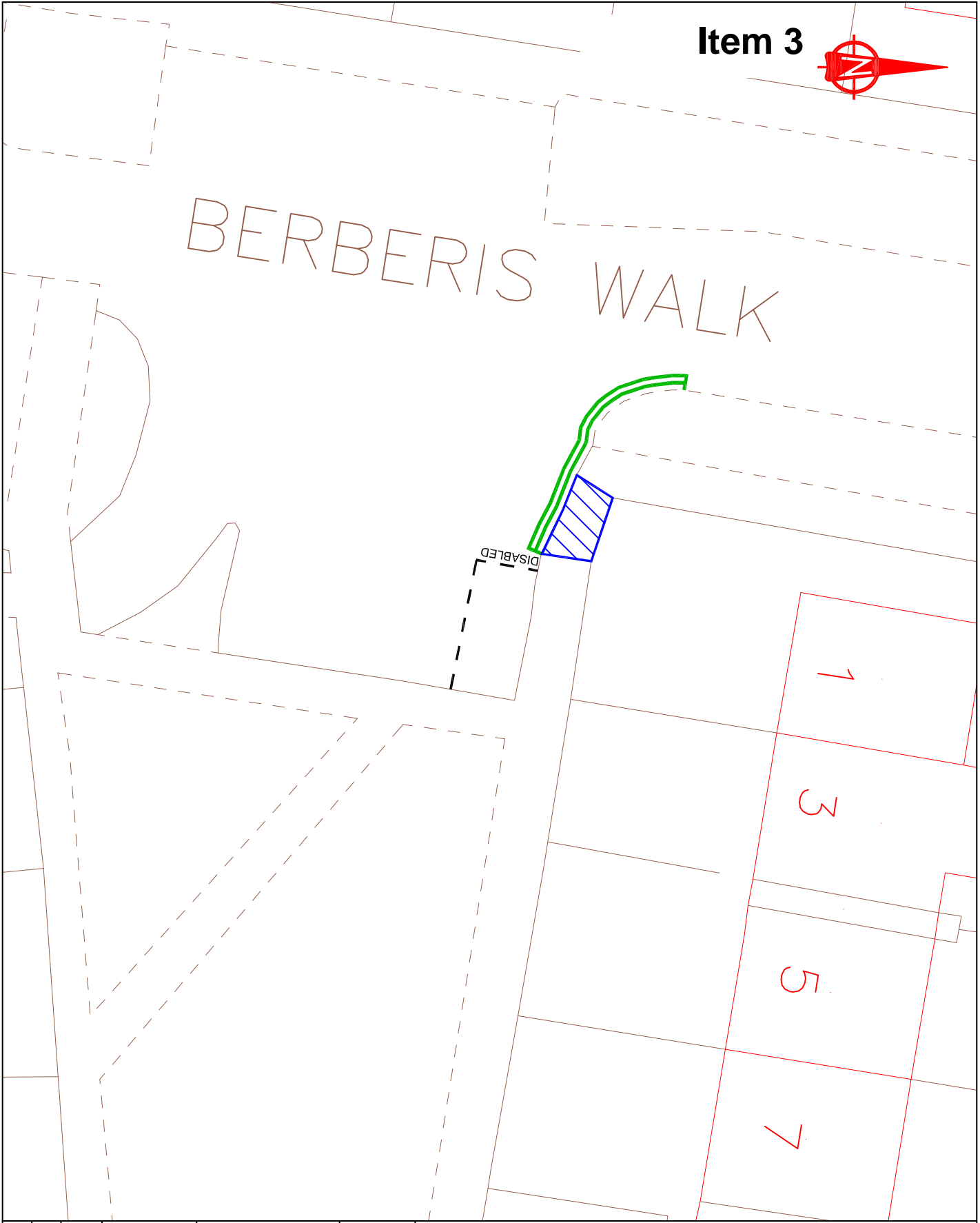

DISABLED

1

3

5

7

This map is based upon Ordnance Survey
 records with the permission of Ordnance Survey
 on behalf of the Controller of Her
 Majesty's Stationery Office. Crown copyright.
 All rights reserved. No part of this
 copyright and may lead to prosecution or
 civil proceedings.
 London Borough of Hillingdon 100019283 2016



Project
 Berberis Walk,
 West Drayton

Description PROPOSED YELLOW LINES TO STOP OBSTRUCTIVE PARKING			
Scale NTS	Drawn (Initials/Date)	Checked (Initials/Date)	Rev.
Project No.	Drawing No.		

Bay Reduction Ruffle Close, West Drayton

KEY

- EXISTING YELLOW LINE
- SYLT NEW SINGLE YELLOW LINE & TERMINAL
- DYLT NEW DOUBLE YELLOW LINE & TERMINAL
- PERMIT HOLDER ONLY BAY
- CROSSOVER

