

LONDON BOROUGH OF HILLINGDON
THE HILLINGDON (WAITING AND LOADING RESTRICTION)
(CONSOLIDATION) ORDER 1994 (AMENDMENT) ORDER 2016
THE HILLINGDON (BROWN BADGE ON-STREET PARKING PLACES)
TRAFFIC ORDER 2012 (AMENDMENT) ORDER 2016
THE HILLINGDON (ON STREET PARKING PLACES)
(HAYES TOWN CENTRE) ORDER 2016

Hillingdon Council gives notice that it intends to make these Orders which will:

- 1. Introduce 'Monday to Friday 11am to Midday' waiting restrictions throughout Hartshill Close, Uxbridge with 'at any time' waiting restrictions at the junction with Sweetcroft Lane.**
- 2. Revise the layout of the parking places in Station Road, Hayes between the junctions of Coldharbour Lane and Crown Close as follows:**
 - i) Introduce Pay & Display parking bays operational 'Monday to Saturday 9am to 6.30pm' outside and opposite Nos. 28 to 36 Station Road with 'Monday to Saturday 6am to 9am' waiting restrictions within these spaces.**
 - ii) Introduce a loading bay outside Nos. 20/22 Station Road.**
 - iii) Introduce disabled parking bays outside No. 38 Station Road and opposite No. 22/28 Station Road.**
 - iv) Introduce a motorcycle parking place outside No. 42/42a Station Road.**
 - v) Introduce 'at any time' waiting restriction throughout this section of Station Road not mentioned above with 'at any time' loading restrictions at the junction with Crown Close.**
- 3. Remove the three Pay & Display parking bays in Hunters Grove, Hayes adjacent to No. 104 Coldharbour Lane, replace with 'at any time' waiting and loading restrictions.**
- 4. Introduce a new motorcycle parking place outside No. 23 Coldharbour Lane, Hayes.**
- 5. Relocate the two brown badge bays from outside Nos. 46 and 48 Coldharbour Lane, Hayes to outside No. 38 and Brotherhood Court Coldharbour Lane, Hayes.**

CHARGES FOR PAY & DISPLAY PARKING PLACES IN STATION ROAD, HAYES		
Parking Period	Standard Charge	HillingdonFirst Cardholder Tariff
30 minutes	Free(on displaying a ticket)	Free(on displaying a ticket)
60 minutes	70p	20p
90 minutes	£1.40	40p
Up to 2 hours	£2.10	60p

Copies of the proposed Orders together with plans and the Council's statement of reasons for the proposals can be seen at Botwell Green and Oak Farm libraries during opening hours and by appointment at the Civic Centre, Uxbridge during normal office hours for 21 days following the date on which this notice is published. Further information can be obtained by telephoning Residents Services Directorate on 01895 250631. If you wish to comment on, or object to the proposals please write by 29th June 2016, stating grounds for objection and your home address, to Transport and Projects, Residents Services, Civic Centre, Uxbridge, Middlesex UB8 1UW quoting reference 4W/06/08/06/16/. Dated this the 8th day of June 2016.

JEAN PALMER,

Deputy Chief Executive & Corporate Director of Residents Services.

STATEMENT OF REASONS

The proposed amendments will accommodate the new public realm improvements for Hayes Town Centre, which have already undergone public consultation with local residents and businesses and received the full support of the Hayes Town Centre Working Group.

The proposed installation of waiting restrictions is intended to prevent all day non-residential parking and promote road safety.

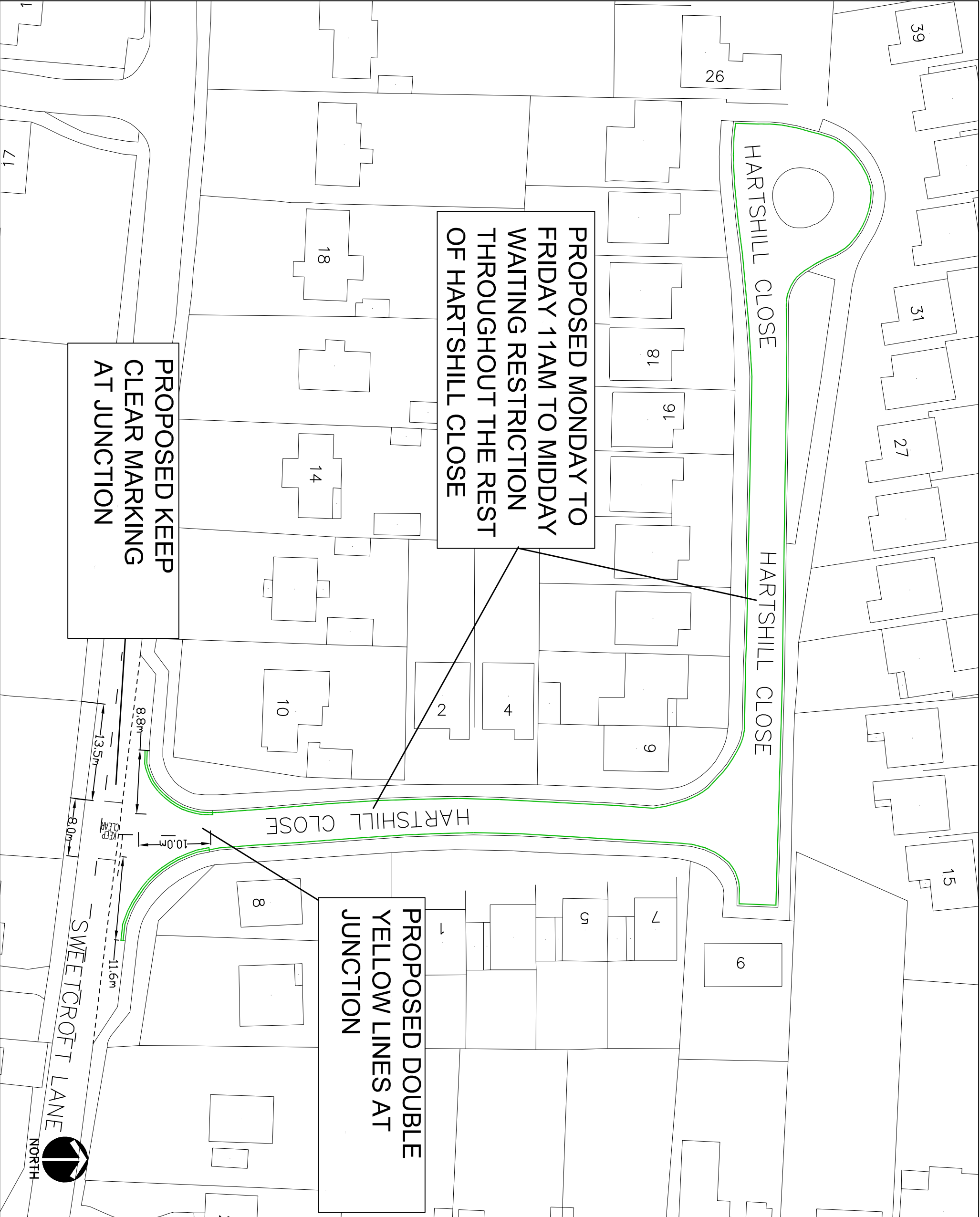

KEY

SRL PROPOSED SINGLE YELLOW LINE
MONDAY TO FRIDAY 11AM TO MIDDAY

DYL PROPOSED DOUBLE YELLOW LINE

This map is based upon Ordnance Survey material with the permission of Ordnance Survey on behalf of the Controller of Her Majesty's Stationery Office © Crown copyright. Unauthorised reproduction infringes Crown copyright and may lead to prosecution or civil proceedings.
London Borough of Hillingdon 100019283 ©2016

HILLINGDON
LONDON

TRANSPORT & PROJECTS
RESIDENTS SERVICES DIRECTORATE
CWC CENTRE, 44/45A, HIGH STREET, URBURGH, URB 10W
Tel: 01895 277009/01895 288976

Project

**Hartshill Close,
Uxbridge**

Description

**Proposed waiting
restrictions and keep
clear marking**

Scale
1:500(A3)

Designed
KU

Drawn
KU

Date
5/05/16

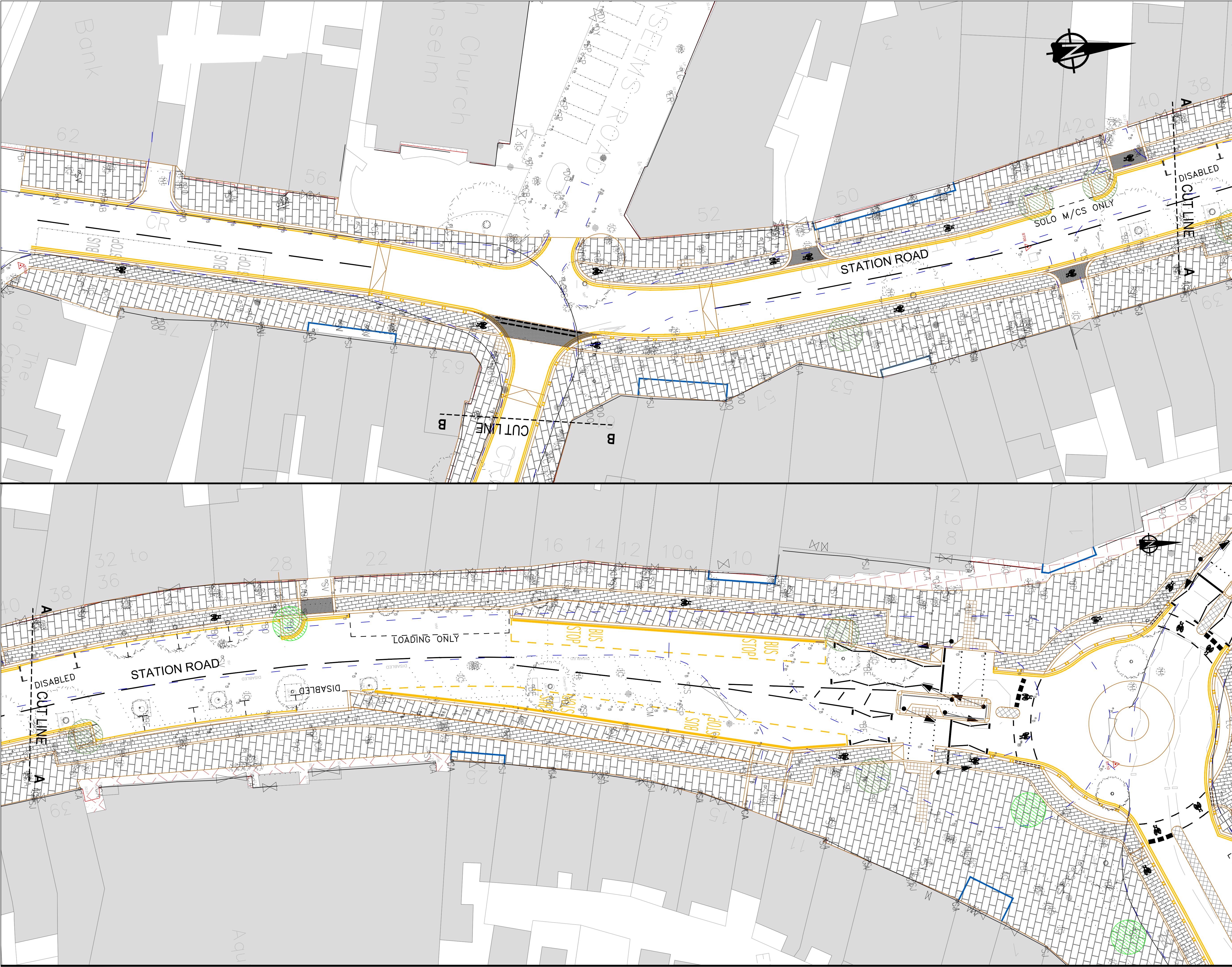

ALL WORKS TO BE CARRIED OUT WITH THE CURRENT LOCAL AUTHORITY TERM MAINTENANCE CONTRACT

EXTENTS OF WORK TO BE CONFIRMED ONSITE WITH COUNCIL AND LONDON BUSES REPRESENTATIVES

OUTLINE DESIGN BASED ON INFORMATION PROVIDED BY STEER DAVIES GLEAVE 2014.

LAYOUT BASED ON TOPOGRAPHICAL SURVEY BY SURVEY SOLUTIONS COMPLETE 10 JANUARY 2012

DO NOT SCALE FROM THIS DRAWING

KEY

- OS BASE/TOPOGRAPHICAL SURVEY
- PROPOSED KERB LINE
- PROPOSED LIGHTING COLUMN
- PROPOSED CCTV MAST
- PRIVATE LAND
- FOOTWAY LICENSE AREA
- INDICATIVE PROPOSED TREE LOCATION SUBJECT TO CCTV, LIGHTING & STATS
- EXISTING TREE TO REMAIN
- LEGIBLE LONDON
- PROPOSED CYCLE LANE
- PROPOSED FOOTWAY
- FLASH IMPRINT MEDIAN STRIP
- IMPRINT CYCLE LANE ACROSS CARRIAGEWAY
- JCDECAUX SIGNS

REV	DATE	DESCRIPTION	ENG	CHK
A	04.12.15	jcdcaux locations added, refer to key	BM	BM

This map is based upon Ordnance Survey material with the permission of Ordnance Survey on behalf of the Controller of Her Majesty's Stationary Office
© Crown copyright.
Unauthorised reproduction infringes Crown copyright and may lead to prosecution or civil proceedings.
London Borough of Hillingdon 100019283 2015

HILLINGDON
COUNCIL
HIGHWAYS MAJOR PROJECTS
RESIDENTS SERVICES
CIVIC CENTRE 4W/06, HIGH STREET, UXBIDGE, UBB 11W
Tel No. 01895 250111 Fax No. 01895 250176

Project
**TOWN CENTRE IMPROVEMENT PROJECTS
2014/15**

Description
**HAYES TOWN CENTRE IMPROVEMENTS
PHASE 2 : STATION ROAD/ CROWN CLOSE
Botwell Lane/Pump Lane Roundabouts
GA DRAWINGS**

Scale	Originated	Designed	Drawn	Date
1:200@A1	HW	MK	MK	19.04.16

Project No.	Drawing No.	Rev.
E/A1	2663-Ph2-GA-02	

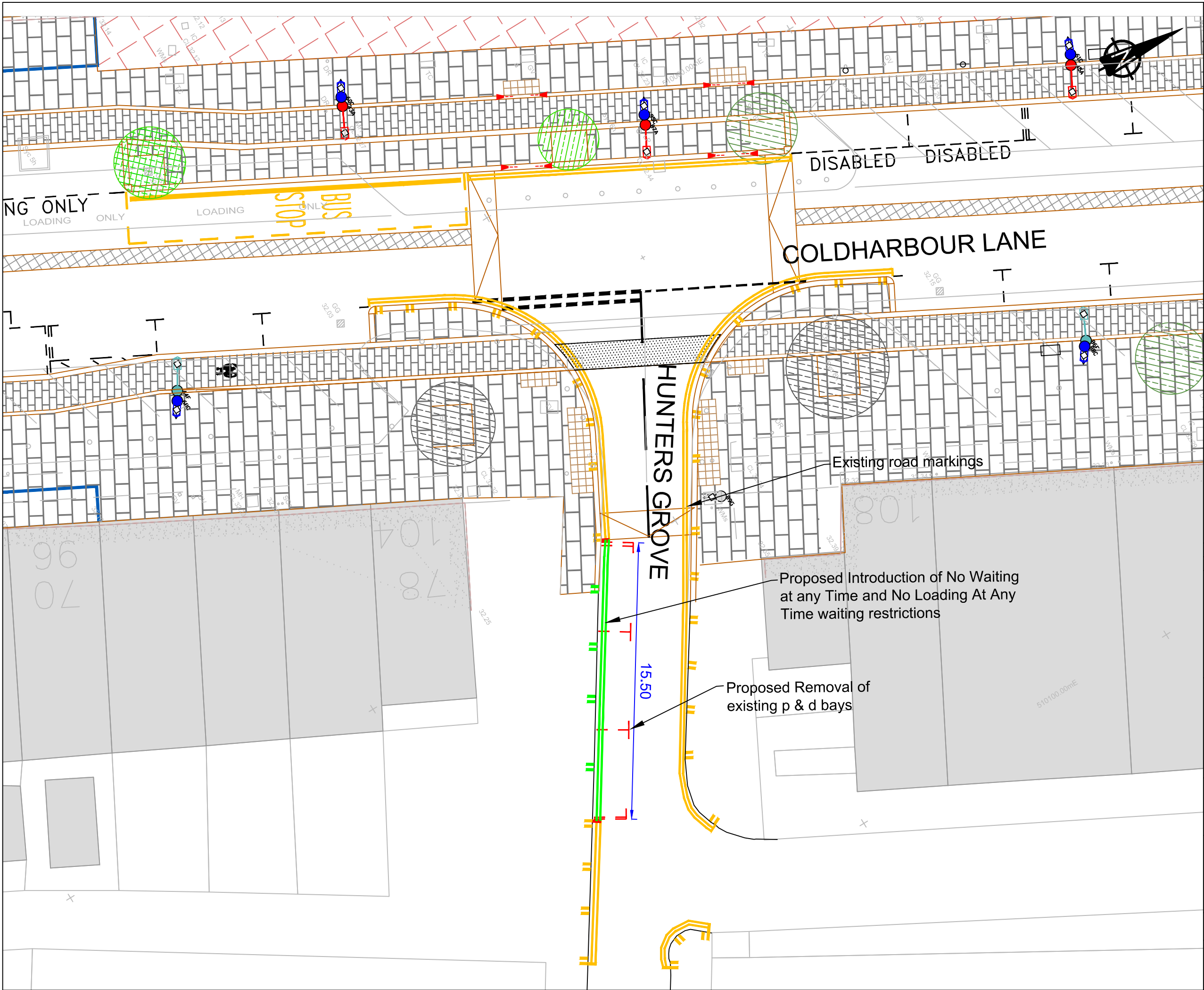

Rev	Description	HT	12.1
Rev	Description	Chkd	Appd Date

This map is based upon Ordnance Survey material with the permission of Ordnance Survey on behalf of the Controller of Her Majesty's Stationery Office © Crown copyright. Unauthorised reproduction infringes Crown copyright and may lead to prosecution or civil proceedings.
London Borough of Hillingdon 100019283 2009



IMPROVEMENT PROJECTS
ENVIRONMENT AND CONSUMER PROTECTION GROUP
CIVIC CENTRE 4W/06, HIGH STREET, UXBIDGE, UB8 1UW
Tel No. 01895 250111 Fax No 01895 250676

Project
2663 Hayes Town Centre Improvement Project

Description
Hunters Grove: P & D bays Removal
Replacement with Waiting Restrictions

Scale	Designed	Drawn	Date
1:200	MK	MK	30.12.15

Project No.	Drawing No.	Rev.
E/A3	2663_Hunters_1	