

LONDON BOROUGH OF HILLINGDON
THE HILLINGDON (WAITING AND LOADING RESTRICTION)
(CONSOLIDATION) ORDER 1994(AMENDMENT) ORDER 2015
THE HILLINGDON (EASTCOTE) (ZONES E AND E2)
(RESIDENTS ON STREET PARKING PLACES) ORDER 2003 (AMENDMENT) ORDER 2015
THE HILLINGDON (ON STREET PARKING PLACES)(SILVER BIRCH CLOSE, ICKENHAM)
(RESIDENTS) ZONE IC3 ORDER 2015
THE HILLINGDON (ON STREET PARKING PLACES)(UXBRIDGE NORTH)
(ZONES U1, U3, U7, U8) ON STREET PARKING PLACES ORDER 2006
(AMENDMENT) ORDER 2015

Hillingdon Council gives notice that it intends to make these Orders which will:

- 1. Impose 'at any time' waiting restrictions** on the lengths of road set out in the Schedule to this notice.
- 2. Install an addition Zone E permit holder parking place on Deane Croft Road, Eastcote** southeast side, from a point 9.3 metres southwest of the common boundary of Nos. 10 and 12 Deane Croft Road, southwestwards for a distance of 4.5 metres.
- 3. Include Nos. 59-79 Park Road, Uxbridge in Zone U3 of the Uxbridge North Parking Management Scheme.**
- 4. Establish permit parking places** (operational between '8am to 6.30pm Monday to Saturday') in which a vehicle may be left during the permitted hours if it displays a valid IC3 permit in Silver Birch Close, Ickenham.
- 5. Impose 'at any time' waiting restrictions** on a section of Silver Birch Close, Ickenham.
- 6. Introduce 'Monday to Saturday 8am to 6.30pm' waiting restrictions** throughout the rest of Silver Birch Close, Ickenham.

Copies of the proposed Orders together with plans and the Council's statement of reasons for the proposals can be seen at Eastcote, Ickenham, Uxbridge and West Drayton Libraries during opening hours and by appointment at the Civic Centre, Uxbridge during normal office hours for 21 days following the date on which this notice is published. Further information can be obtained by telephoning Residents Services Directorate on 01895 277006. If you wish to comment on, or object to the proposals please write by 10th June 2015, stating grounds for objection and your home address, to Transport and Projects, Residents Services, Civic Centre, Uxbridge, Middlesex UB8 1UW quoting reference 4W/06/KU/GH/CF/20/5/15/.

Dated this the 20th day of May 2015.

JEAN PALMER,

Deputy Chief Executive & Corporate Director of Residents Services.

SCHEDULE - WAITING PROHIBITED 'AT ANY TIME'

DRAYTON GARDENS, WEST DRAYTON

- i) Easternmost north-south arm, between a point in line with the northern kerbline of the northernmost east-west arm of Drayton Gardens and a point 5 metres south of the common boundary of Nos. 6 & 8 Drayton Gardens
- ii) Northernmost east-west arm of Drayton Gardens, between a point in line with the western kerbline of easternmost north-south arm of Drayton Gardens and a point in line with the front wall of No. 8 Drayton Gardens
- iii) Northernmost east-west arm of Drayton Gardens, all sides of the turning head, between a point on the northern side in line with the western flank wall of Nos. 28/28A Drayton Gardens continuing onto the southern side of Drayton Gardens to a point in line with the western flank wall of Nos. 46/46A Drayton Gardens

STATEMENT OF REASONS

An extension to the Ickenham Parking Management Scheme Zone "IC3" in Silver Birch Close, Ickenham will prevent all day non-residential parking whilst still providing parking provision for residents and their visitors.

The proposed inclusion of Nos. 59-79 (odds) Park Road, Uxbridge into Zone "U3" of the Uxbridge North Parking Management Scheme will provide nearby on-street parking for these residents.

The proposed 'at any time' waiting restrictions in Drayton Gardens are intended to remove obstructive parking to improve road safety and promote the free flow of traffic.

The proposed installation of an additional Zone E permit holder parking place in Deane Croft Road will increase the parking provision for residents.

Proposed double yellow lines on the northwest side of Silver Birch Close between the junction with Warren Road to outside No. 8.

Proposed residents' permit holder parking bays on the southeast side of Silver Birch Close with single yellow lines across driveways and in the turning head of the road to protect access.

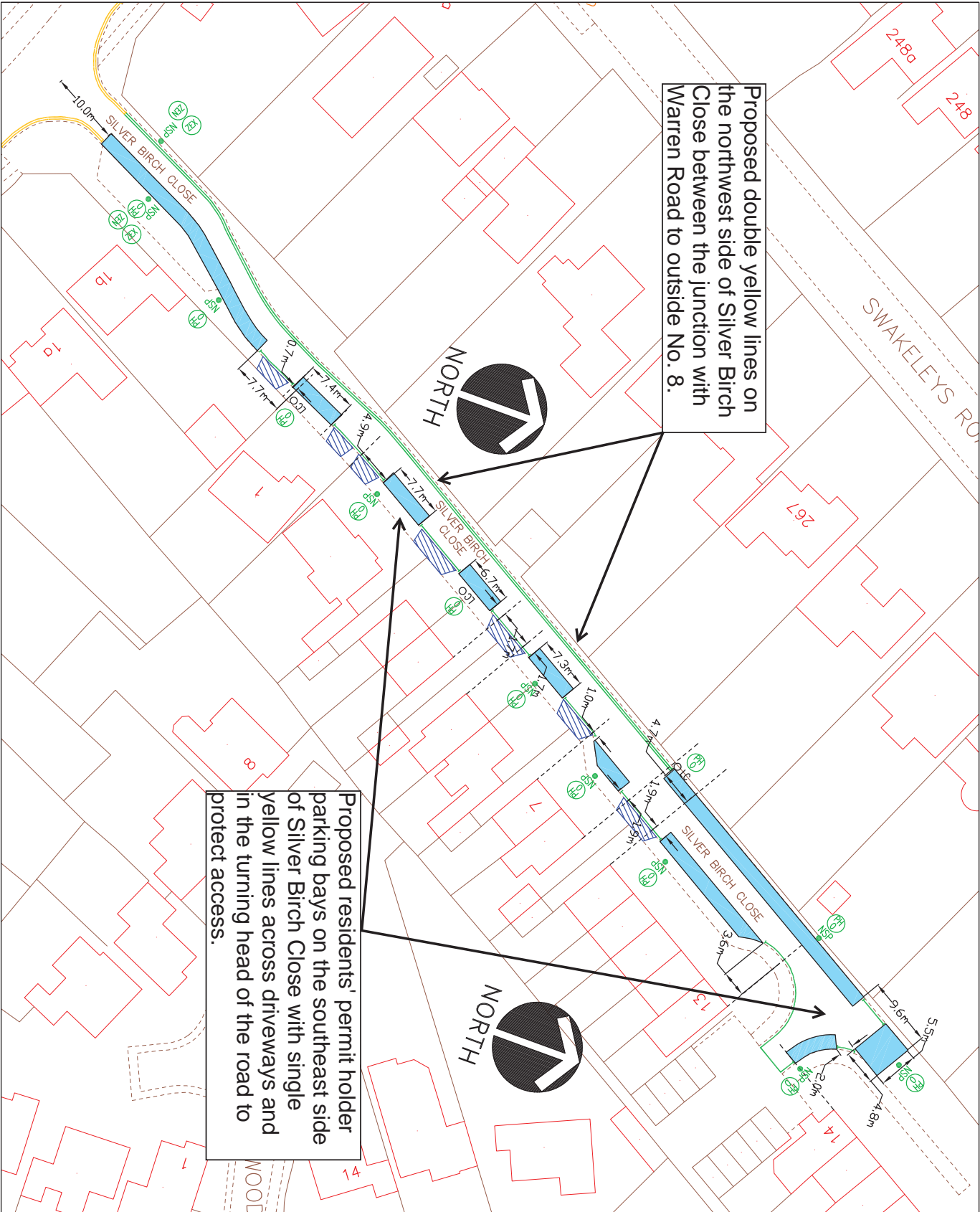

- KEY**
- EXISTING YELLOW LINE
 - BURN OFF ROAD MARKING
 - PROPOSED DOUBLE YELLOW LINE
 - PROPOSED SINGLE YELLOW LINE
 - PERMIT HOLDER ONLY BAY
 - CROSSOVER
 - NEW SIGNPOST
 - OLC LAMP COLUMN
 - PERMIT HOLDER ONLY SIGN
 - ZONE ENTRY SIGN
 - ZONE EXIT SIGN

This map is based upon Ordnance Survey data supplied to Hillingdon Regeneration Services Directorate on behalf of the Controller of the Hillingdon Stationery Office. © Crown copyright. All rights reserved. No part of this publication may be reproduced, stored in a retrieval system or transmitted in any form or by any means, electronic, mechanical, photocopying, recording or otherwise, without the prior written permission of Hillingdon Regeneration Services Directorate. London Borough of Hillingdon 100019283 ©2015

HILLINGDON
 TRANSPORT & PROJECTS
 REGENT SERVICES DIRECTORATE
 ONE CANAL WAY, WOODSIDE, HILLINGDON, BUCKINGHAMSHIRE, MK5 8JW
 TEL: 01494 472000 FAX: 01494 472009

Silver Birch Close
Ickenham

Possible
Scheme Layout

Scale	1:500(A3)	Drawn	17/02/15
Sheet	KU	Revised	KU

Location plan

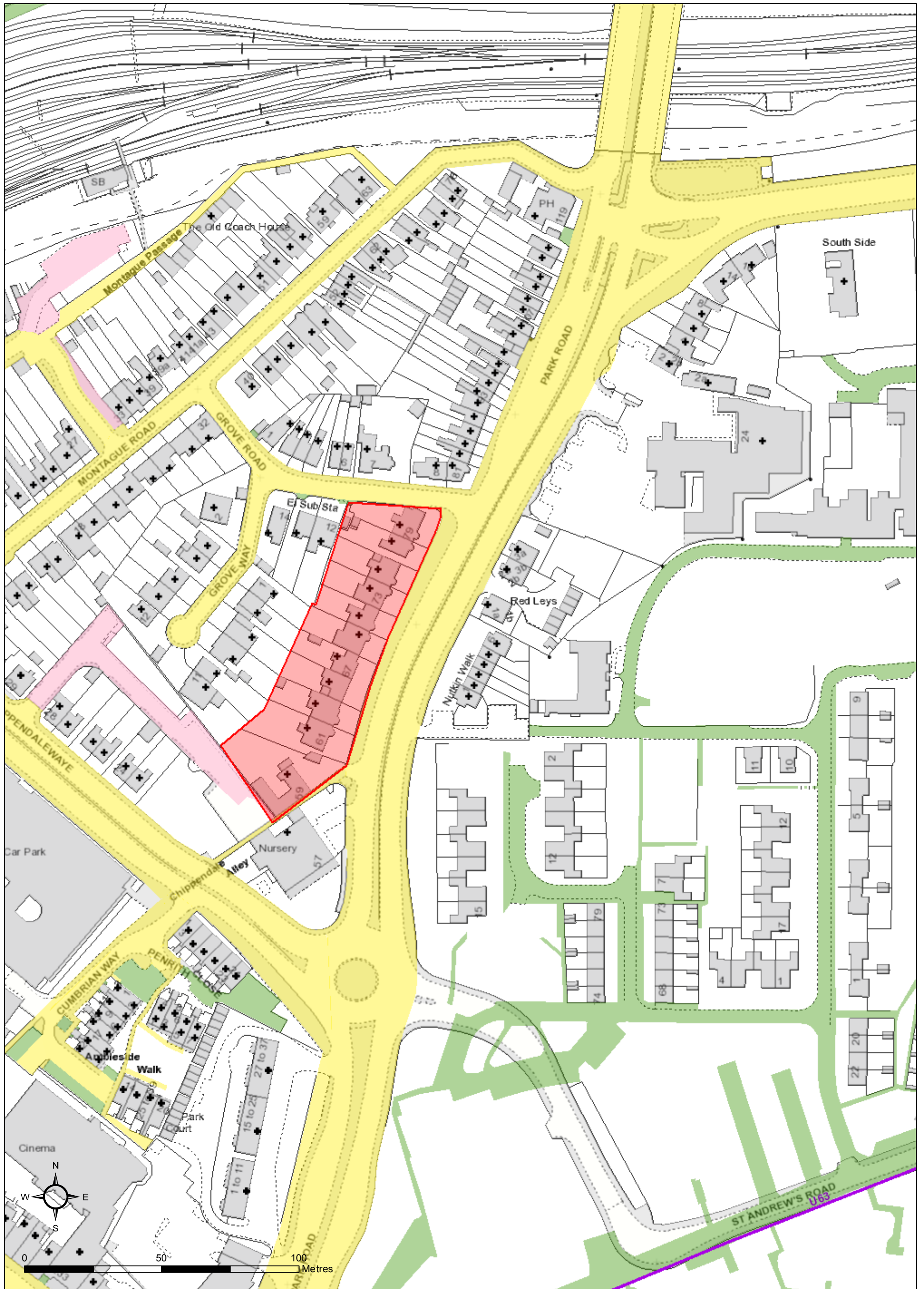

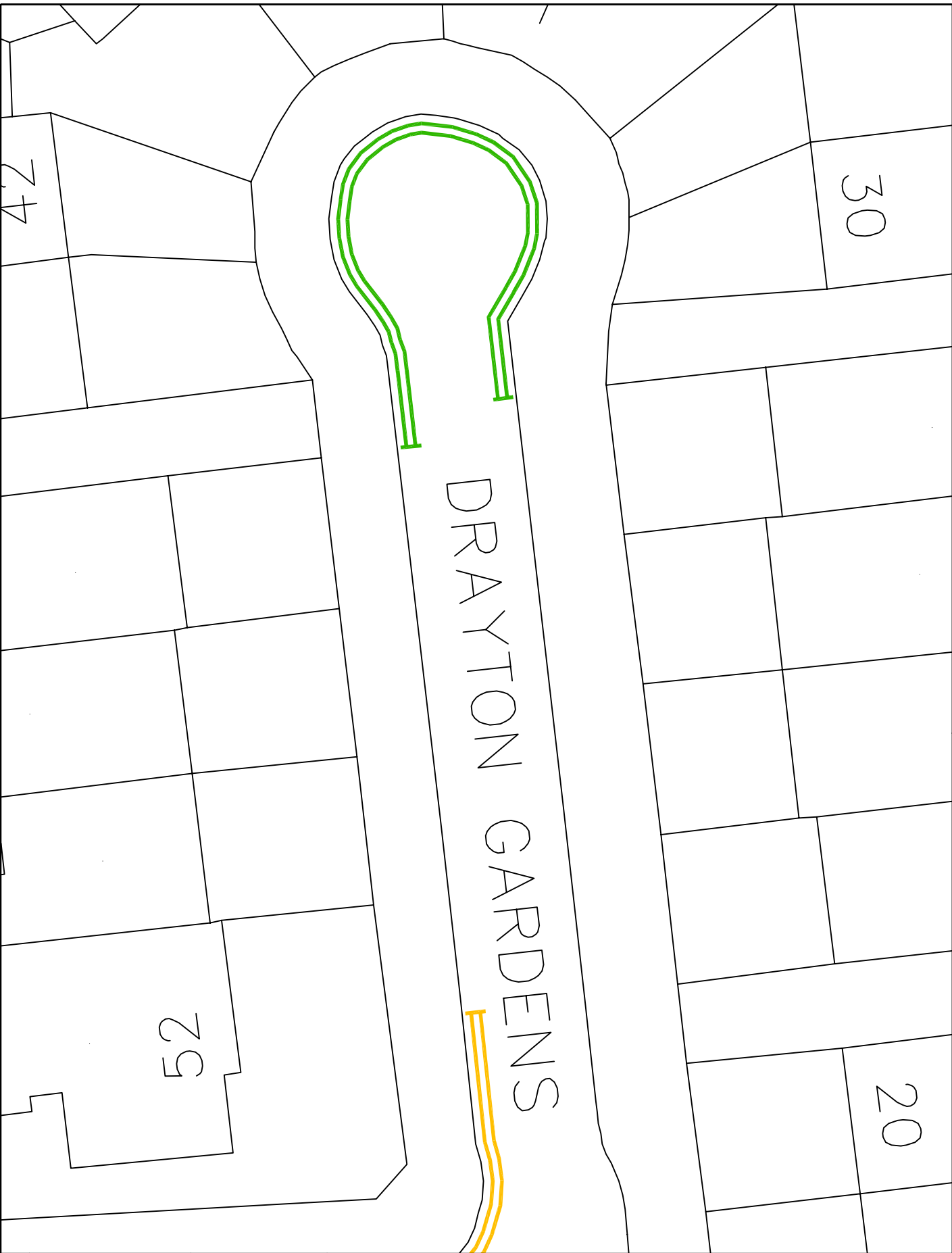

KEY	
	EXISTING YELLOW LINE
	BURN OFF ROAD MARKING
	SYL PROPOSED SINGLE YELLOW LINE
	DYL PROPOSED DOUBLE YELLOW LINE

This map is based upon Ordnance Survey material with the permission of Ordnance Survey on behalf of the Controller of Her Majesty's Stationery Office. All Crown Copyright. This map is the property of Hillingdon Council and its use is limited to the project. Copyright and may lead to prosecution or other proceedings.
London Borough of Hillingdon 100019283 ©2014



TRANSPORT & PROJECTS
RESIDENTS SERVICES DIRECTORATE
Civic Centre 44/45A, Main Street, Uxbridge, UB8 3UH
Tel No. 01895 271000/01895 28070

Project
**Drayton Gardens
West Drayton**

Description
**Proposed
Double Yellow lines**

Scale
NTS From: 1/1000 (A3) To: 1/250 (A4)

DAH 25/3/15

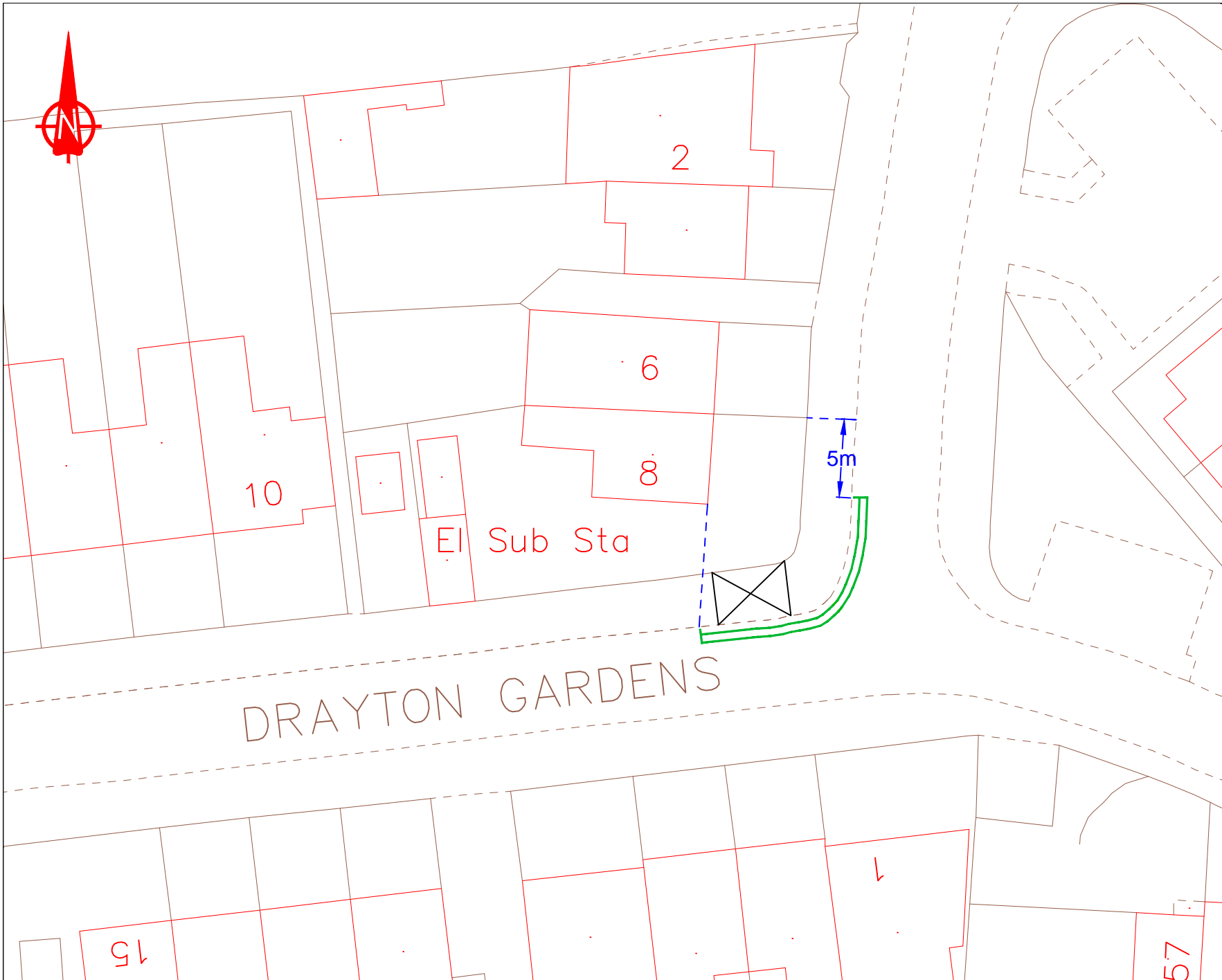

KEY

 Proposed 'At any time' waiting restrictions

This map is based upon Ordnance Survey material with the permission of Ordnance Survey on behalf of the Controller of Her Majesty's Stationery Office © Crown copyright. Unauthorised reproduction infringes Crown copyright and may lead to prosecution or civil proceedings.
London Borough of Hillingdon 100019283 2015



HILLINGDON
LONDON

Project
Drayton Gardens,
West Drayton

Description
PROPOSED DOUBLE YELLOW LINES

Scale	Drawn (Initials/Date)	Checked (Initials/Date)
NTS	CF 04/15	

Project No.	Drawing No.	Rev.

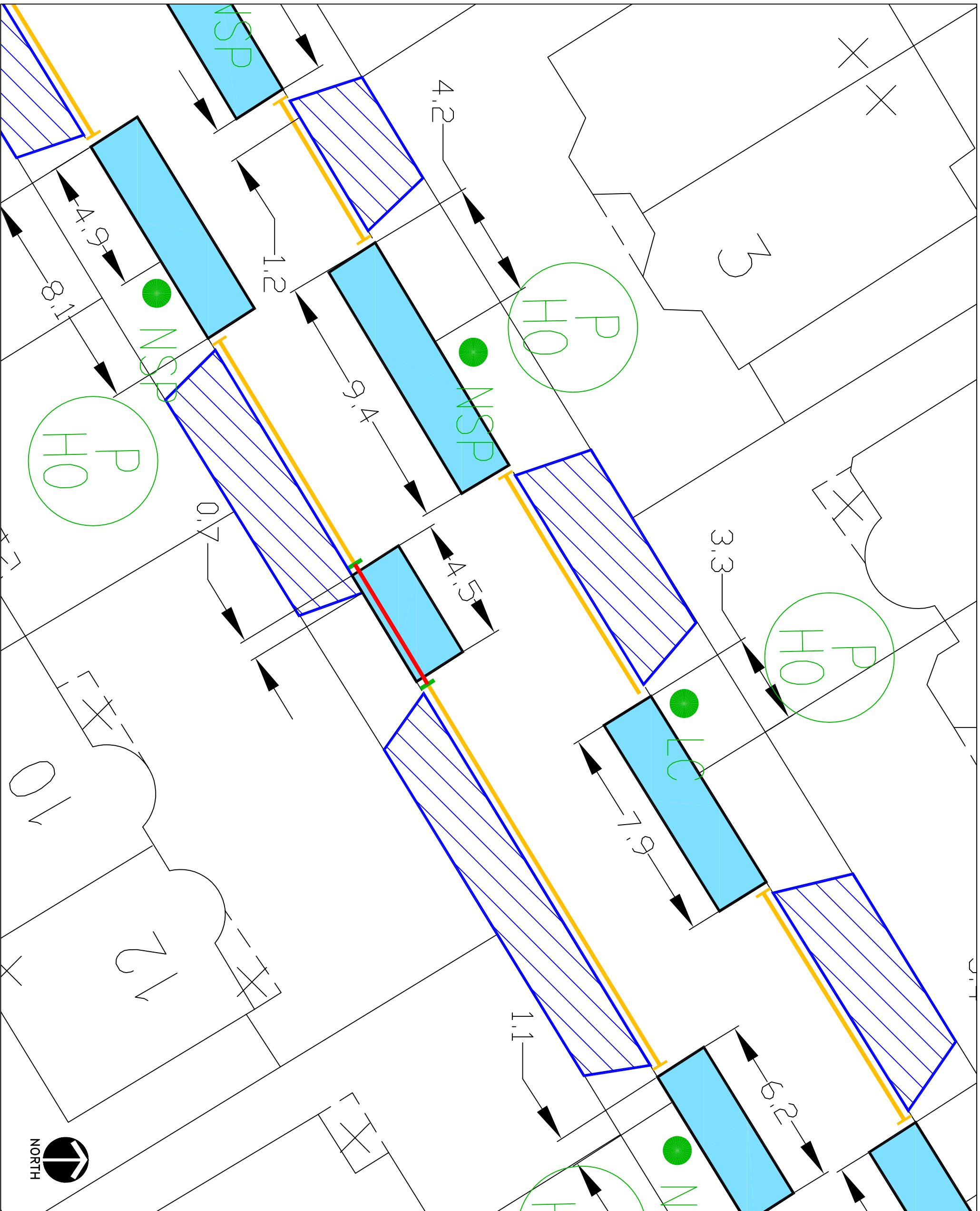

KEY

	EXISTING YELLOW LINE
	SIT
	NEW SINGLE YELLOW LINE & TERMINAL
	DET
	NEW DOUBLE YELLOW LINE & TERMINAL
	CROSSOVER

This map is based upon Ordnance Survey material with the permission of Ordnance Survey on behalf of the Controller of Her Majesty's Stationary Office © Crown copyright. Unauthorised reproduction infringes Crown copyright and may lead to prosecution or civil proceedings.
 London Borough of Hillingdon 100019283 ©2011

HILLINGDON
 TRANSPORT & PROJECTS
 PLANNING, ENVIRONMENT, EDUCATION AND
 AND COMMUNITY SERVICES DIRECTORATE
 CIVIC CENTRE 4W/05, HIGH STREET, UXBRODE, UBA 11W
 TEL NO. 01895 277008/01895 250676

Project
 10 Deane Croft Road
 Eastcote

Description
 Adjustment to Parking Places
 to Accomodate Additional
 Parking Place

Scale	Designed	Drawn	Date
Project No.	Drawing No.	Rev.	APR'15