

LONDON BOROUGH OF HILLINGDON
THE HILLINGDON (FREE PARKING PLACES) (DISABLED PERSONS) (AMENDMENT NO.)
ORDER 2014
THE HILLINGDON (COWLEY ZONE C1)(ON STREET PARKING PLACES) ORDER
2007(AMENDMENT NO.) 2014
THE HILLINGDON (HILLINGDON HILL)(RESIDENTS ZONE HN1)(ON-STREET PARKING
PLACES) ORDER 2012 (AMENDMENT NO.) ORDER 2014
REMOVAL OF DISABLED PARKING BAYS

Hillingdon Council gives notice that it intends to make these Orders, which will:

- a) Remove the disabled parking bay outside No. 5 St Peter's Road, Cowley and convert to a Zone C1 Permit Holder Parking Place
- b) Remove the disabled parking bay outside No. 26 The Rise, Hillingdon and convert to a Zone HN1 Permit Holder Parking Place.

Plans and the Council's statement of reasons for the proposals can be seen at Uxbridge Library and by appointment at the Civic Centre, Uxbridge during normal office hours for 21 days following the date on which this notice is published. Further information can be obtained by telephoning Residents Services Directorate on 01895 556266. If you wish to comment on, or object to the proposals please write by 6th August 2014, stating grounds for objection and your home address, to Transport and Projects, Residents Services, Civic Centre, Uxbridge, Middlesex UB8 1UW quoting reference 4W/06/CF/16/7/14. Dated this 16th day of July 2014
JEAN PALMER

Deputy Chief Executive & Corporate Director of Residents Services.

STATEMENT OF REASONS

Conversion of redundant disabled parking bays to residents' permit holder parking places will provide more on-street parking spaces for residents.

5 St Peter's Road, Cowley

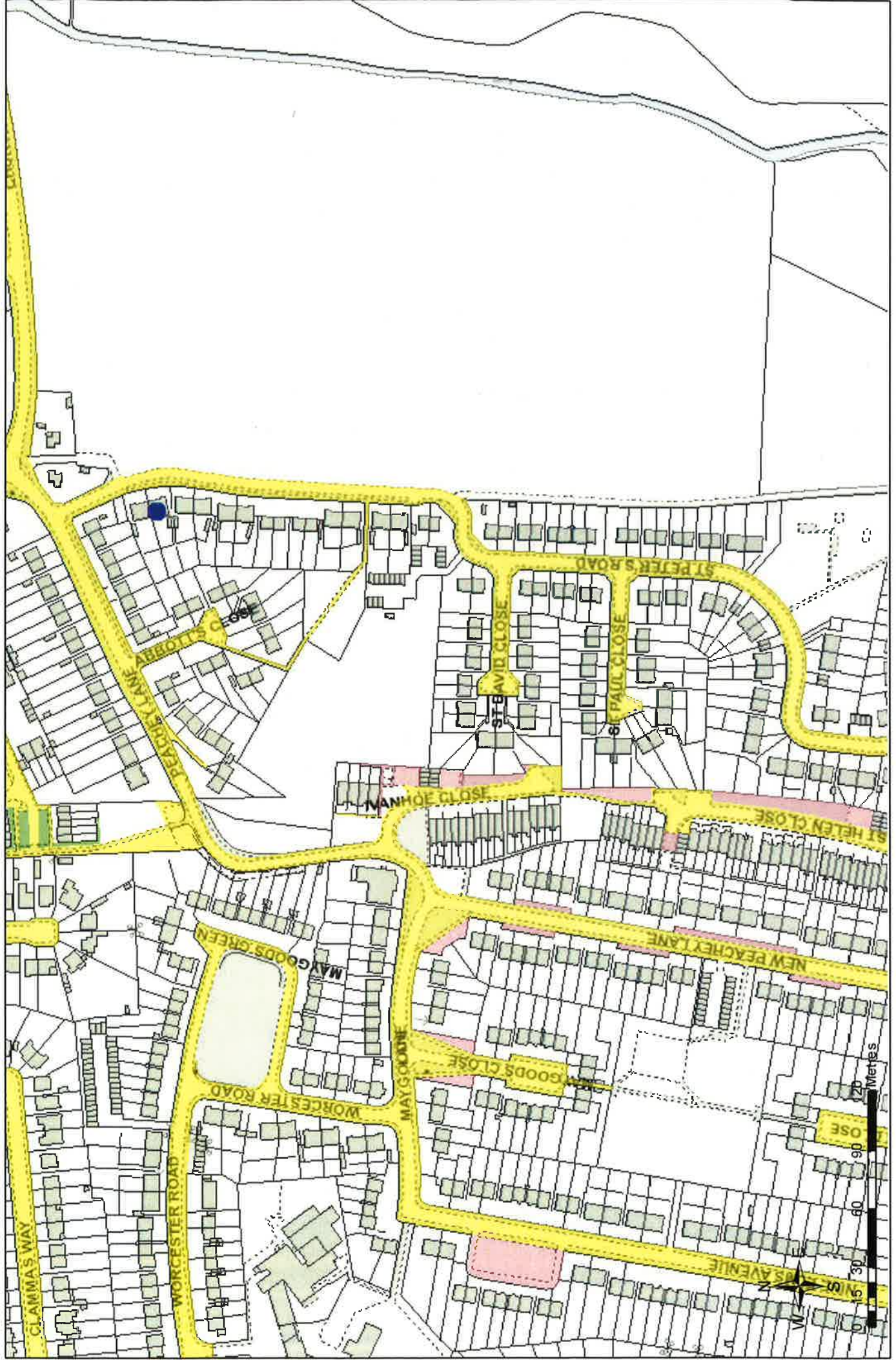

26 The Rise, Hillingdon

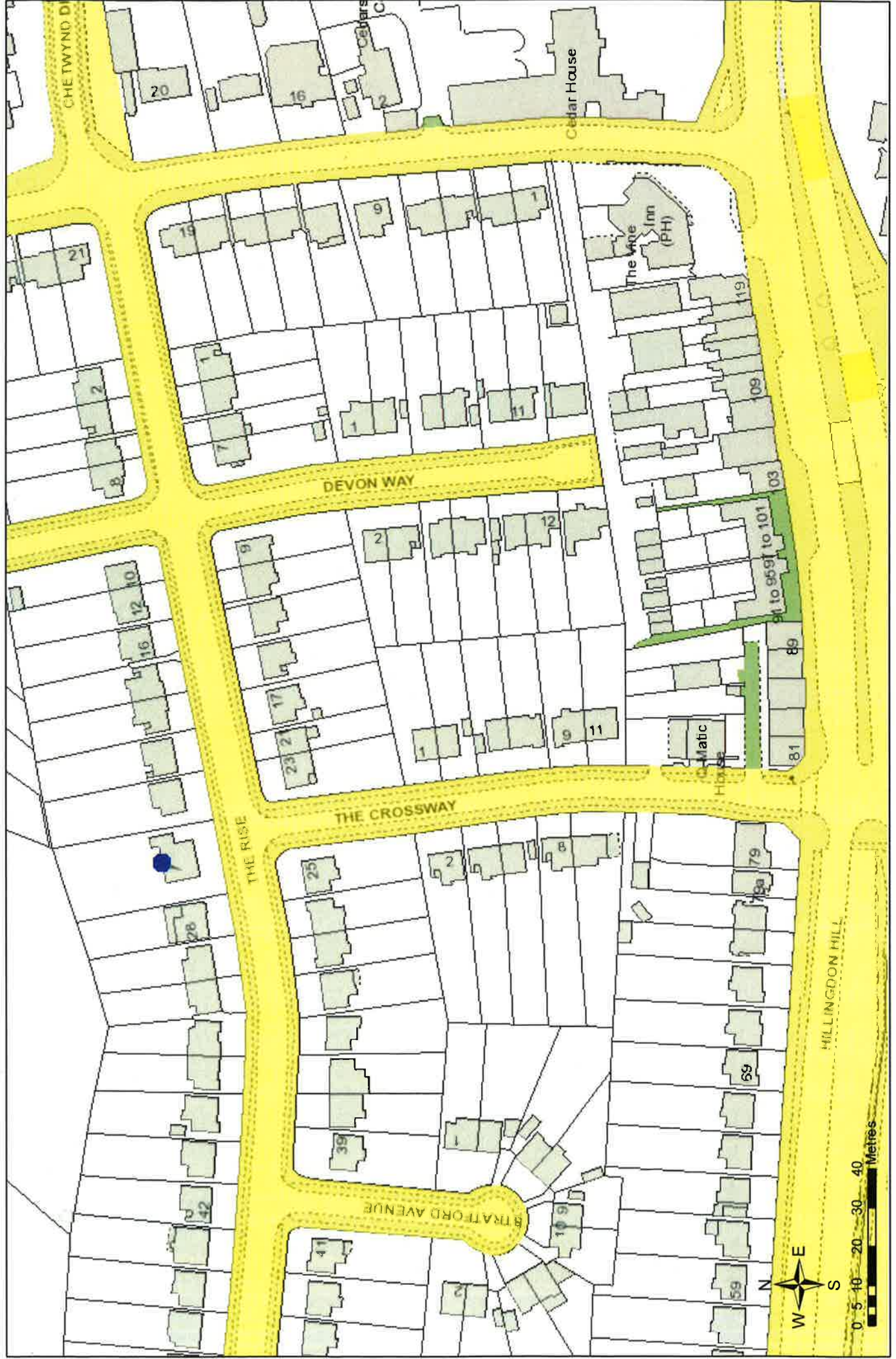

LONDON BOROUGH OF HILLINGDON THE HILLINGDON (WAITING AND LOADING RESTRICTION) (CONSOLIDATION) ORDER 1994 (AMENDMENT) ORDER 2014
PROPOSED WAITING RESTRICTIONS IN VARIOUS ROADS

Hillingdon Council gives notice that it intends to make these Orders which will:

1. Impose 'at any time' waiting restrictions on the lengths of road set out in the Schedule to this notice.

A copy of the proposed Order together with plans and the Council's statement of reasons for the proposals can be seen at West Drayton and Yeading libraries during opening hours and by appointment at the Civic Centre, Uxbridge during normal office hours for 21 days following the date on which this notice is published. Further information can be obtained by telephoning Residents Services Directorate on 01895 558294. If you wish to comment on, or object to the proposals please write by 6th August 2014, stating grounds for objection and your home address, to Transport and Projects, Residents Services, Civic Centre, Uxbridge, Middlesex UB8 1UW quoting reference 4W/06/GH/16/07/14/. Dated this 16th day of July 2014.

JEAN PALMER,

Deputy Chief Executive & Corporate Director of Residents Services.

SCHEDULE - WAITING PROHIBITED 'AT ANY TIME'

SUMMERHOUSE LANE, HARMONDSWORTH

South, southeast and east side, from a point opposite a point in line with the eastern flank wall no No.50 Summerhouse Lane northwards to a point 12 metres northeast of the northeastern kerbline of the eastern most east to west arm of Summerhouse Lane.

North and northwest side, from a point in line with the eastern flank wall of No.50 Summerhouse Lane northwards to a point 10 metres north of the northern kerbline of the southernmost east to west arm of Summerhouse Lane.

Eastern most northwest to southeast arm. Both sides from a point in line with the eastern kerbline of the Summerhouse Lane southeastwards for a distance of 10 metres

DELAMERE ROAD, HAYES

Southeast side, from a point 10 metres southwest of the southwest kerbline of Tollgate Drive, to a point 10 metres northeast of the northeastern kerbline of Tollgate Drive.

TOLLGATE DRIVE, HAYES



Both sides, from the southeastern kerbline of Delamere Road, southeastwards for a distance of 10 metres.

STATEMENT OF REASONS

These proposed restrictions will stop obstructive parking and improve safety near a school. All proposals have been agreed by the Cabinet Member for Planning, Transportation and Recycling to proceed to formal consultation.

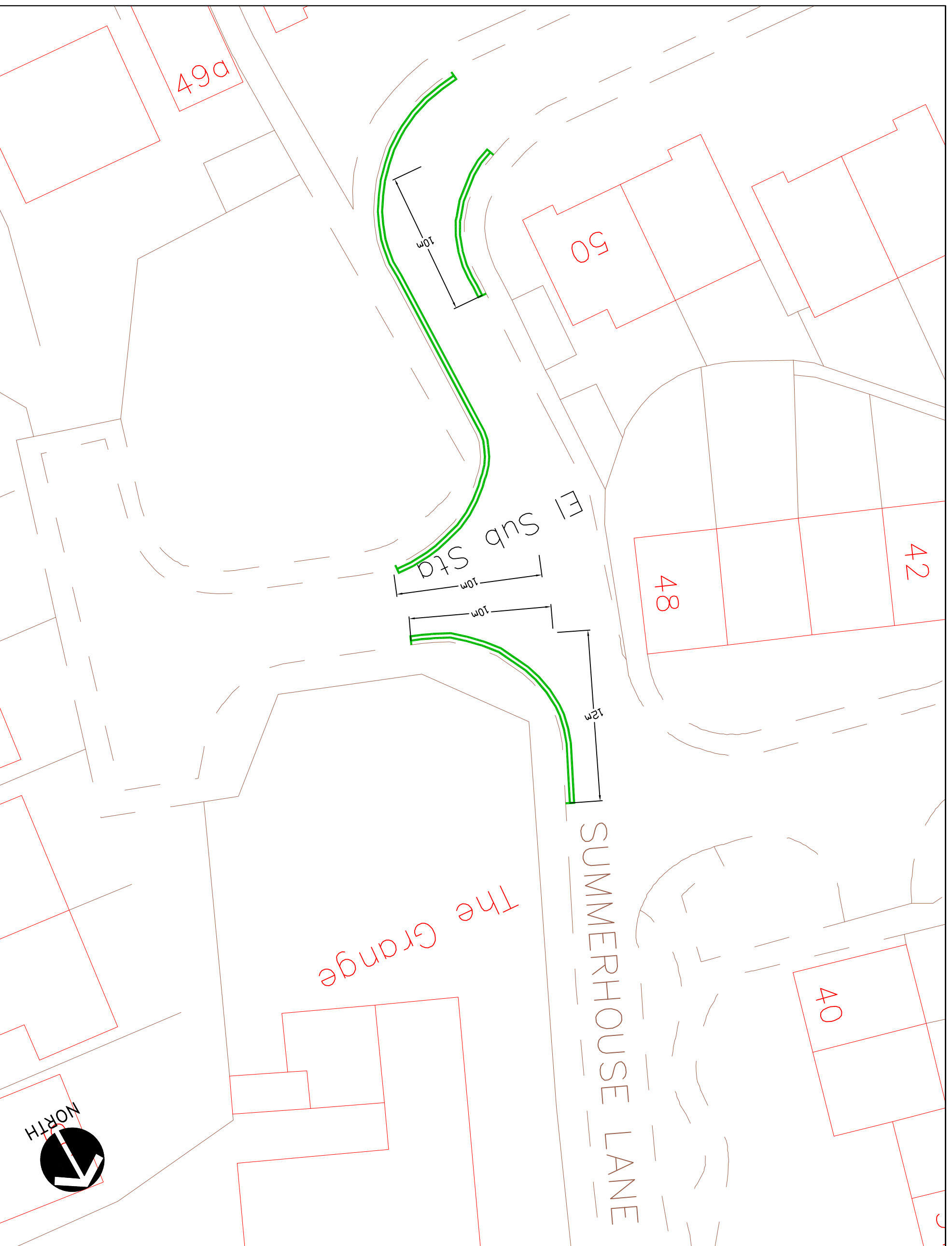
Item 1



KEY	
	EXISTING YELLOW LINE
	NEW DOUBLE YELLOW LINE & TERMINAL
	NEW SINGLE YELLOW LINE & TERMINAL

This map is based upon Ordnance Survey maps with the permission of the Controller of the Survey on behalf of the Controller of the Majesty's Stationery Office © Crown copyright. Unauthorised reproduction infringes Crown copyright and may lead to prosecution or civil proceedings.
 London Borough of Hillingdon 100019283 ©2011

HILLINGDON
LONDON



TRANSPORT & PROJECTS
 PLANNING, ENVIRONMENT, EDUCATION
 AND COMMUNITY SERVICES DIRECTORATE
 CIVIC CENTRE 4M/08, HIGH STREET, UXTERDE, UB8 1UW
 Tel No. 01895 277006/01895 250676

Project
 Summerhouse Lane
 Harmondsworth

Description
 Proposed Waiting Restrictions
 to replace invalid road
 markings and improve safety

Scale Drawn (Initials/Date)

Items 2 & 3

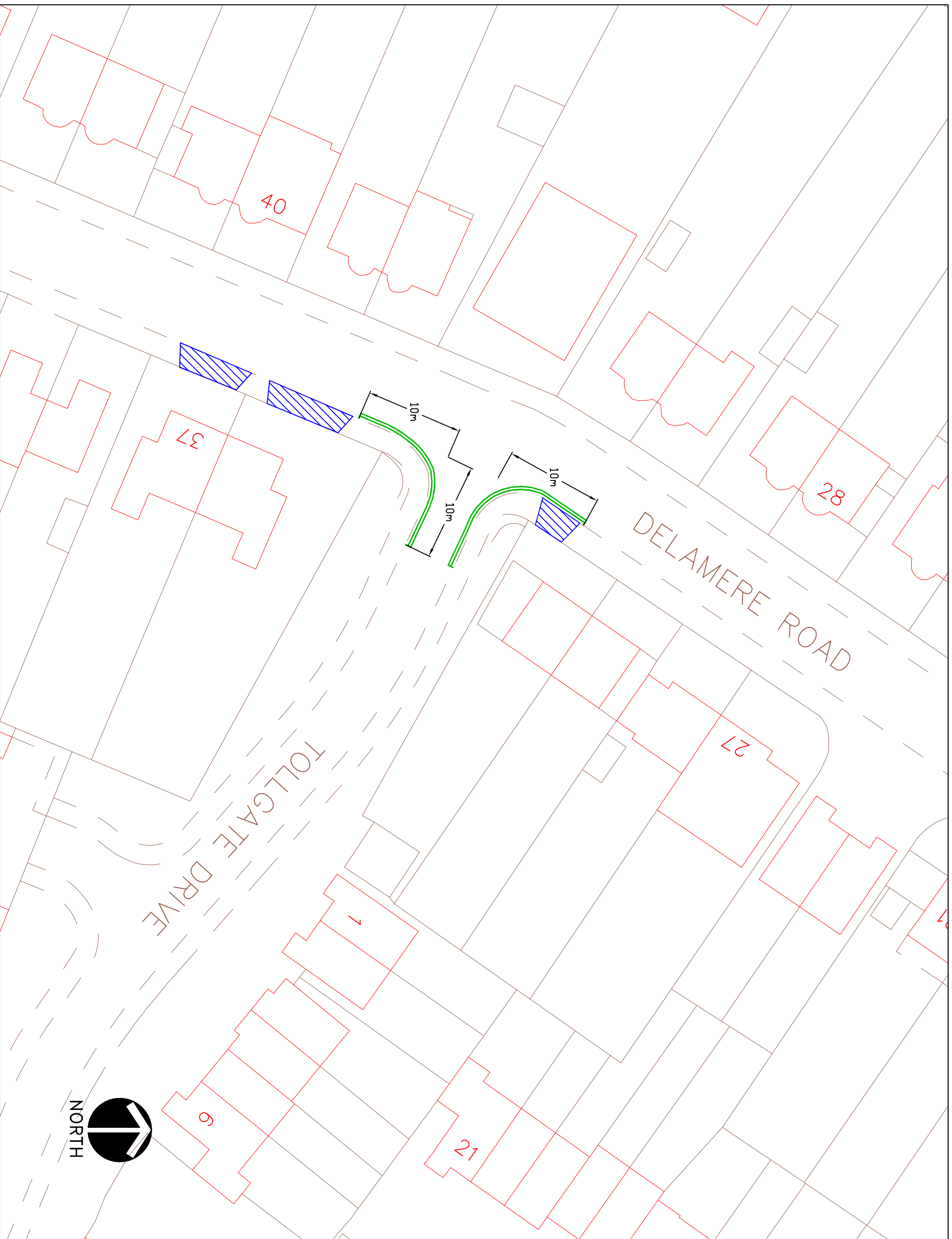

KEY	
	EXISTING YELLOW LINE
	DYLT NEW DOUBLE YELLOW LINE & TERMINAL
	SYLT NEW SINGLE YELLOW LINE & TERMINAL
	FOOTWAY PARKING
	VEHICLE CROSSOVER
	FOOTWAY PARKING SIGN

This map is based upon Ordnance Survey material with the permission of Ordnance Survey on behalf of the Controller of the Copyright, Design and Patents Act 1988. Ordnance Survey copyright, and its use hereunder, is hereby acknowledged. Copyright and its use hereunder, is hereby acknowledged. London Borough of Hillingdon 100019283 ©2011

HILLINGDON
 LONDON
 TRANSPORT & PROJECTS
 PLANNING, ENVIRONMENT, EDUCATION
 AND COMMUNITY SERVICES DIRECTORATE
 CIVIC CENTRE 4W/06, HIGH STREET, UXBRIDGE, UB8 1UW
 Tel No. 01895 277006/01895 250676

Project
 Junction of
 Delamere Road and
 Tollgate Drive

Description
 Parking restrictions to stop
 obstructive parking.

Scale _____ **Drawn** (Initials/Date)