

LONDON BOROUGH OF HILLINGDON
THE HILLINGDON (FOOTWAY PARKING PLACES) ORDER 2013
ST GILES AVENUE, ICKENHAM

AMENDMENTS TO THE PROPOSED FOOTWAY PARKING SCHEME

Hillingdon Council gives notice that it intends to make these Orders, which will amend the proposals advertised on 28th March 2012 to:

- a) **Remove the proposed footway parking places** outside Nos. 41 to 47 odd St Giles Avenue.
- b) **Extension of the proposed footway parking place** adjacent to No. 77 Glebe Avenue by 5 metres - From a point 10 metres northeast of the northeastern kerbline of Glebe Avenue, northeastwards for a distance of 33.2 metres.

A copy of the proposed Order together with full details, a plan and the Council's statement of reasons for the proposals can be seen at Ickenham Library until 13th March 2013 and by appointment at the Civic Centre, Uxbridge during normal office hours until 6 weeks after either, the order is made or the Council decides not to proceed. Further information can be obtained by telephoning Residents Services on 01895 277006. If you wish to comment on, or object to the proposals please write by 13th March 2013, stating grounds for objection and your home address to Transport and Projects, Residents Services, Civic Centre, Uxbridge, Middlesex UB8 1UW quoting reference 4W/06/14390/KU.

Dated this 20 day of February 2013

JEAN PALMER,

Deputy Chief Executive & Corporate Director of Residents Services.





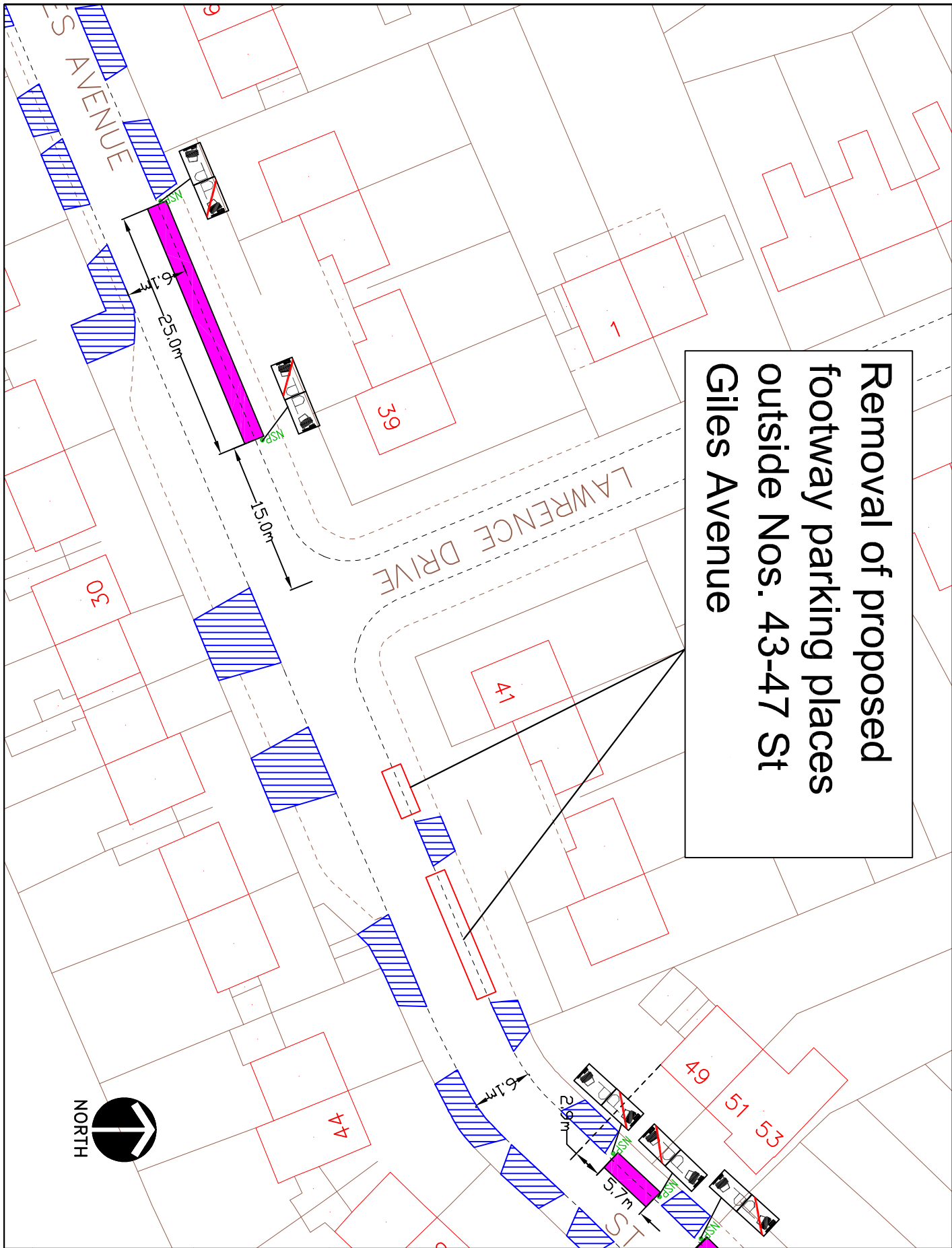

STATEMENT REASONS

These amendments have been approved by the Cabinet Member for Planning, Transportation and Recycling following consideration of the comments received to a previous consultation with residents. The amendments to the proposed footway parking scheme will allow residents to maximise the benefits of the scheme.

**Removal of proposed
footway parking places
outside Nos. 43-47 St
Giles Avenue**



KEY

-  FOOTWAY PARKING PLACE
0.9 METRES ON FOOTWAY
UNLESS NOTED
-  NEW SIGN & POST
-  PARTIAL FOOTWAY
PARKING PERMITTED
PAST THIS POINT
-  FOOTWAY PARKING
NOT PERMITTED
PAST THIS POINT
-  CROSSOVER
-  EXTENT OF PRIVATE
ROADS

This map is based upon Ordnance Survey material with the permission of Ordnance Survey on behalf of the Controller of Her Majesty's Stationery Office. All Crown Copyright. This map is the property of Hillingdon Council and copyright and may lead to prosecution or civil proceedings if reproduced or used in any way without the written permission of Hillingdon Council. ©2012



HILLINGDON
LONDON

TRANSPORT & PROJECTS
PLANNING, ENVIRONMENT, EDUCATION
AND COMMUNITY SERVICES DIRECTORATE
ONE CENTRE WAY, 5TH FLOOR, UXTON
MIDLANDS, CV8 2TR
Tel: 01825 272005/01825 255016

Project
St Giles Avenue
Ickenham

Description
Removal of proposed
footway parking places

Scale 1:500 (a4) **Form:** (final/issue)
Ref: KU 06/12

Appendix E

Proposed extension of footway parking place by 5 metres.

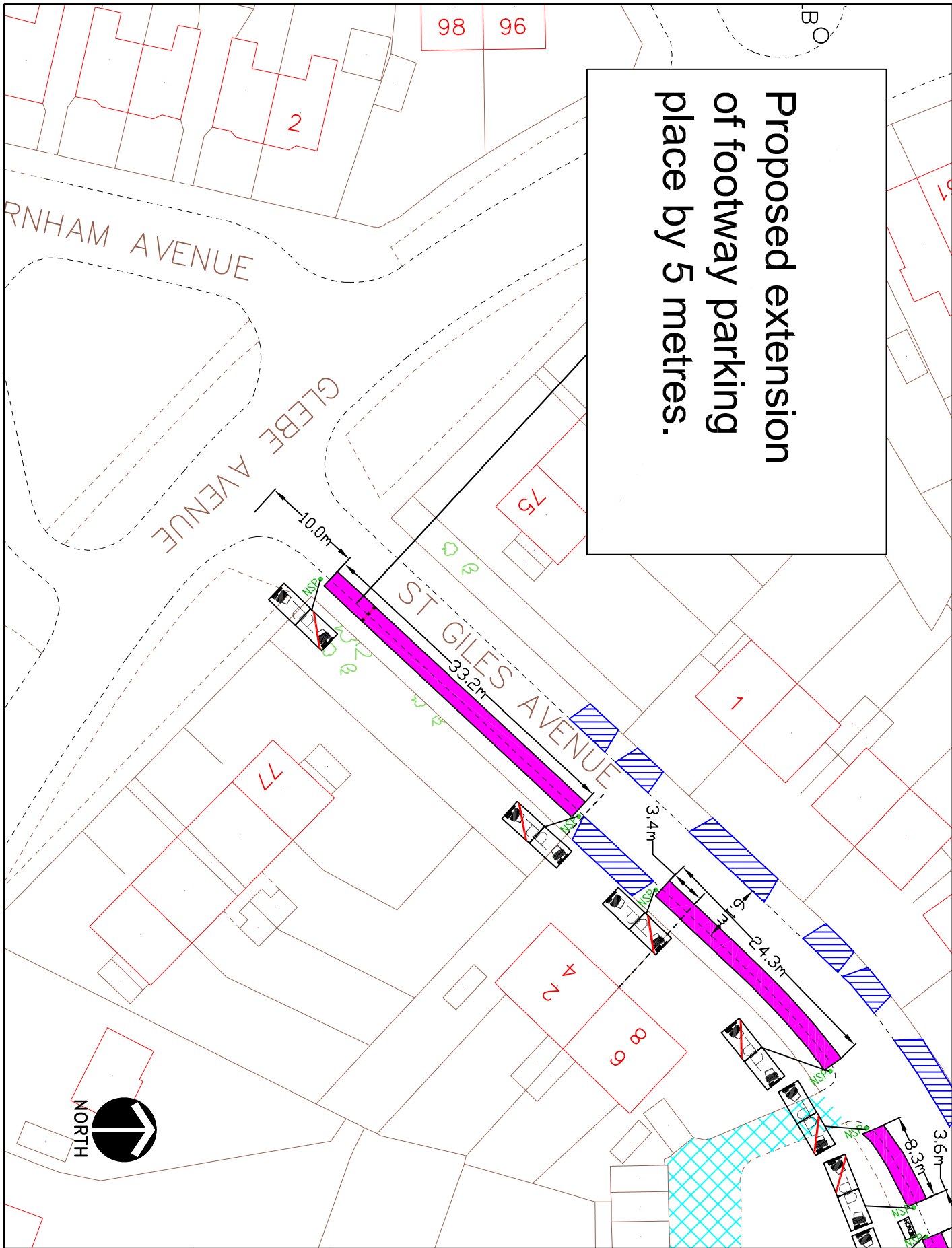

KEY

- FOOTWAY PARKING PLACE
- 0.9 METRES ON FOOTWAY UNLESS NOTED
- NSP
- NEW SIGN & POST
- PARTIAL FOOTWAY PARKING PERMITTED PAST THIS POINT
- FOOTWAY PARKING NOT PERMITTED PAST THIS POINT
- CROSSOVER
- EXTENT OF PRIVATE ROADS

This plan is based upon Ordnance Survey material with the permission of Ordnance Survey on behalf of the Controller of the Map. It is a Crown Copyright. All rights reserved. No part of this publication may be reproduced, stored in a retrieval system, or transmitted in any form or by any means, electronic, mechanical, photocopying, recording, or otherwise, without the prior written permission of Ordnance Survey. Ordnance Survey is a registered trademark of Ordnance Survey Limited. London Borough of Hillingdon 100019283 ©2012



HILLINGDON
LONDON
TRANSPORT & PROJECTS
PLANNING, ENVIRONMENT, EDUCATION
AND COMMUNITY SERVICES DIRECTORATE
ONE CENTRE WAY, 01895 272005/01895 258576

Project
St Giles Avenue
Ickenham

Description
Proposed extension of
footway parking place

Scale
1:500 (a4) **Form:** (final/04/12)
KU 06/12