

LONDON BOROUGH OF HILLINGDON
 THE HILLINGDON (RESIDENTS ZONE HY3)(ON STREET PARKING PLACES)
 ORDER 2013. THE HILLINGDON (WAITING AND LOADING RESTRICTION)
 (CONSOLIDATION) (AMENDMENT NO.) ORDER 2013.
 PROPOSED PARKING MANAGEMENT SCHEME IN THE LAYBY FRONTING NOS. 263-269
 COLDHARBOUR LANE, HAYES.

Hillingdon Council gives notice that it intends to make these Orders, which will:

1. **Establish Permit parking places** operational between 9.00am and 5.00pm Monday to Friday, in the layby fronting Nos. 263-269 Coldharbour Lane, Hayes in which a vehicle may be left during permitted hours if it displays a valid permit.
2. **Establish disabled parking places** in the layby fronting Nos. 263-269 Coldharbour Lane, Hayes in which only vehicles displaying a Blue Badge may be left at all times.
3. **Impose “at any time” waiting restrictions** in lengths of road listed in the Schedule below.
4. **Impose waiting restrictions**, operational between 9.00am and 5.00pm Monday to Friday in the remainder of the layby fronting Nos. 263 to 269 Coldharbour Lane, not mentioned in the Schedule below.
5. **Establish shared use pay & display or permit holder parking places** operational between 9.00am and 5.00pm Monday to Friday in the layby fronting Nos. 263-269 Coldharbour Lane, Hayes, the maximum period for which a vehicle may be left during the permitted hours is two hours, if it displays a valid ticket from a ticket parking machine with the charges shown below.

Parking Period	Standard Charge	HillingdonFirst Cardholder Tariff
30 minutes	Free(on displaying a ticket)	Free(on displaying a ticket)
60 minutes	70p	20p
90 minutes	£1.40	40p
Up to 2 hours	£2.10	60p

RESIDENTS PERMITS - £0 - 1st vehicle, all subsequent - £40 per annum

VISITORS VOUCHERS First book of 10 per household per annum- free.

£5 - per book of 10 thereafter.

Copies of the proposed Orders together with full details, a plan and the Council’s statement of reasons for the proposals can be seen at Yeading Library and by appointment at, Civic Centre, Uxbridge during normal office hours until 27th February 2013. Further information can be obtained by telephoning Residents Services on 01895 558294.

If you wish to comment on, or object to the proposals please write by 27th February 2013, stating grounds for objection and your home address to Transport & Projects, Residents Services, Civic Centre, Uxbridge, Middlesex UB8 1UW quoting reference 4W/06/7.44/GH

Dated this 6th day of February 2013

JEAN PALMER,

Deputy Chief Executive & Corporate Director Residents Services.

SCHEDULE
 WAITING PROHIBITED ‘AT ANY TIME’

COLDHARBOUR LANE, HAYES

- a) The layby fronting Nos. 263 to 269 Coldharbour Lane, Hayes
 - i) Northeast to southwest arm, northwest side, from a point 0.5 metres southwest of the northeastern boundary of No. 269 Coldharbour Lane, northeastwards for a distance of 4.7 metres.
 - ii) Northwest to southeast arm, both sides, from a point in line with the northwestern kerbline of Coldharbour Lane, northwestwards for a distance of 15 metres.
- b) The northwest side, between a point 10 metres northeast of the northeastern kerbline of the layby fronting Nos. 263 to 269 Coldharbour Lane and a point 10 metres southwest of the southwestern kerbline of the layby fronting Nos. 263 to 269 Coldharbour Lane.

STATEMENT OF REASONS

To respond to views submitted by residents and businesses from the Council's consultation, the scheme will deter all day parking, improve road access and promote road safety.

Appendix B

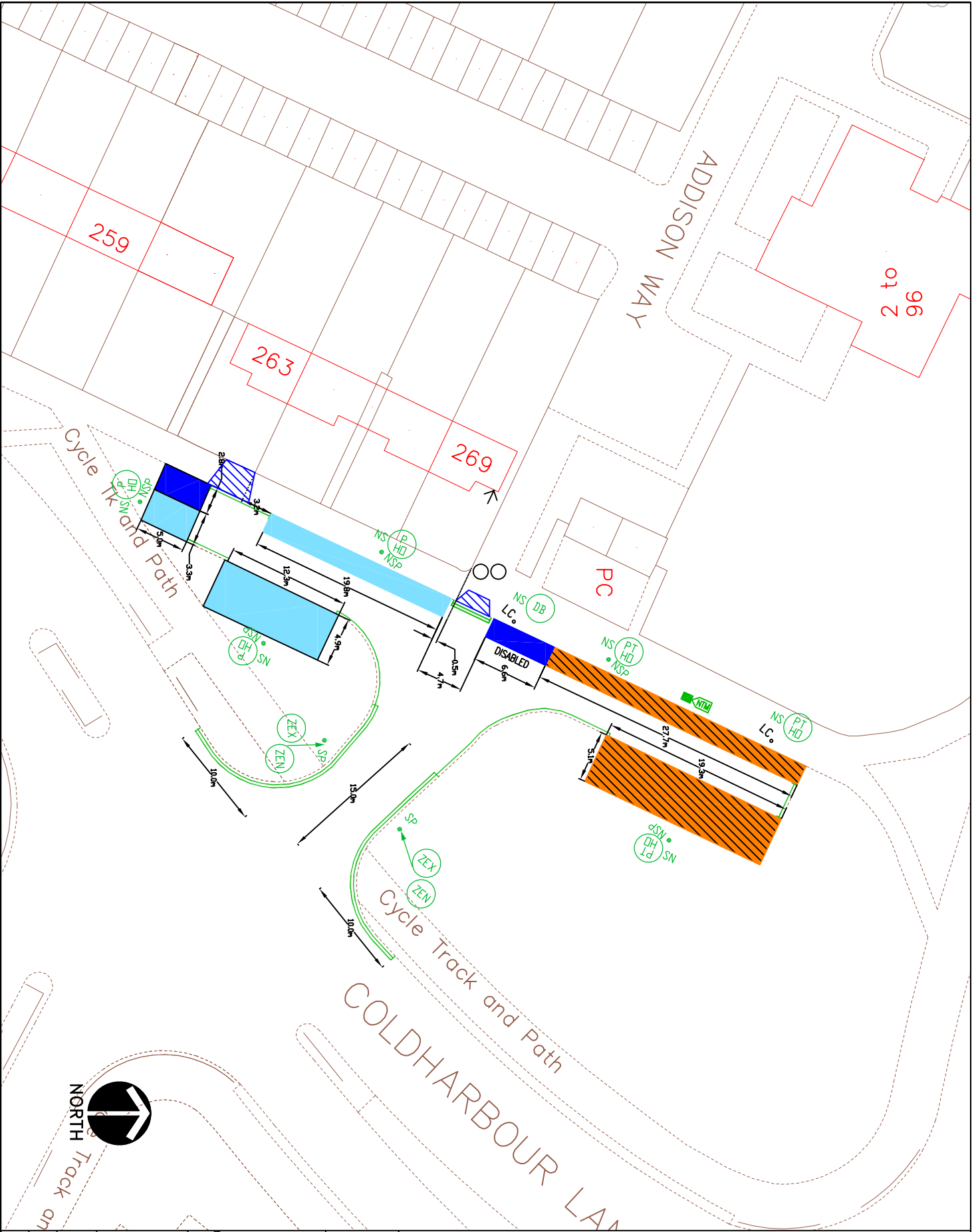

KEY

- EXISTING YELLOW LINE
 - NEW DOUBLE YELLOW LINE & TERMINAL
 - NEW SINGLE YELLOW LINE & TERMINAL
 - DISABLED PARKING BAY SIGN
 - PERMIT OR TICKET HOLDER SIGN
 - ZONE ENTRY SIGN
 - ZONE EXIT SIGN
 - DISABLED PARKING BAY SIGN
 - PAY AND DISPLAY AND PERMIT HOLDERS BAY/PLACE
 - DISABLED BAY
- PARKING BAYS ARE 2m WIDE UNLESS NOTED

This map is based upon Ordnance Survey data and is not a substitute for a professional survey on behalf of the Controller of the Highway's Stationary Office. Crown copyright and may be used by permission or call proceedings London Borough of Hillingdon 100018283 ©2010



HILLINGDON
LONDON

IMPROVEMENT PROJECTS
ENVIRONMENT AND CONSUMER PROTECTION GROUP
CIVIC CENTRE 49/50, HIGH STREET, UXBIDGE, URBAS 11W
Tel No. 01895 277008/01895 250679

COLDHARBOUR LANE, HAYES

PROPOSED RESIDENTS PERMIT SCHEME

Scale	1:500 (GH NOV 2012)	Drawn	(Initials/Date)	Checked	(Initials/Date)
Project No.		Drawing No.		Rev.	A

LONDON BOROUGH OF HILLINGDON
THE HILLINGDON (ON STREET PARKING PLACES(NORTHWOOD) ZONE N1
ORDER 2003 (AMENDMENT NO.) ORDER 2013

PROPOSED BUSINESS PERMIT BAYS IN EASTBURY ROAD, NORTHWOOD

Hillingdon Council gives notice that it intends to make these Orders, which will;
a) Convert 22 metres of Pay & Display parking bay on Eastbury Road, Northwood to Business Permit Holder Only bays operational Monday to Saturday 8am to 6:30pm, from a point 13.7 metres south of a point in line with the northern flank wall of No. 2 Rofant Road, south westwards for a distance of 22 metres;

Copies of the proposed Orders together with full details, a plan and the Council's statement of reasons for the proposals can be seen at Northwood Library and by appointment at Civic Centre, Uxbridge during normal office hours until 27th February 2013. Further information can be obtained by telephoning Residents Services on 01895 277006. If you wish to comment on, or object to the proposals please write by 27th February 2013, stating grounds for objection and your home address to Transport & Projects, Residents Services, Civic Centre, Uxbridge, Middlesex UB8 1UW quoting reference 4W/06/7.15/KU

Dated this 6th day of February 2013

JEAN PALMER,

Deputy Chief Executive & Corporate Director Residents Services.

STATEMENT OF REASONS

The proposals will address the concerns raised by local traders by providing more business permit parking bays close to the town centre.

Appendix A

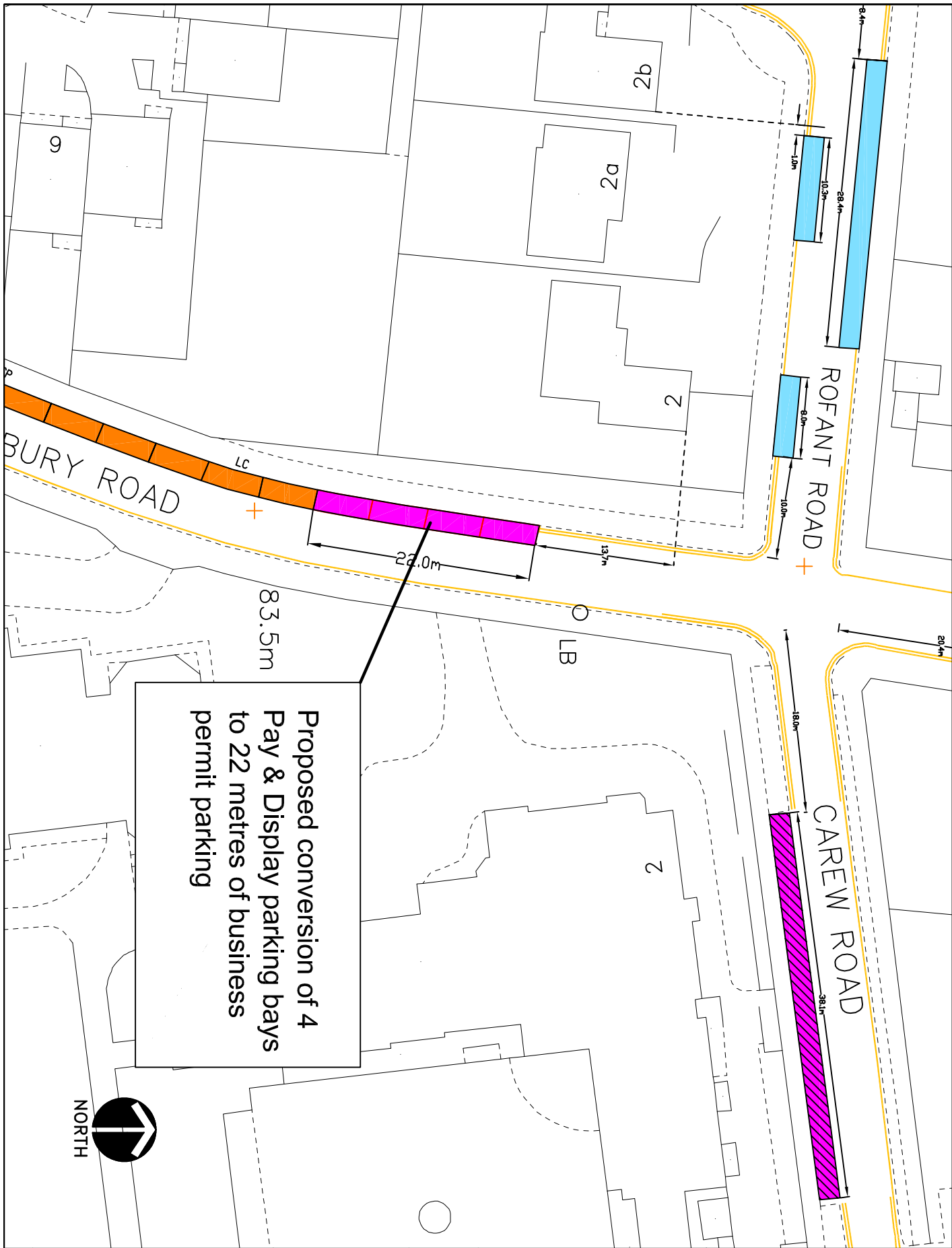

Proposed conversion of 4 Pay & Display parking bays to 22 metres of business permit parking

KEY

- BUSINESS OR RESIDENT PERMIT HOLDER ONLY BAY/PLACE
- BUSINESS PERMIT HOLDER ONLY BAY/PLACE
- PAY AND DISPLAY BAY
- PERMIT HOLDER ONLY BAY/PLACE
- EXISTING YELLOW LINE

PARKING BAYS ARE 2 METRES WIDE UNLESS NOTED

This map is based upon Ordnance Survey material with the permission of Ordnance Survey. All rights reserved. © Crown copyright. Unauthorised reproduction infringes Crown copyright and may lead to prosecution or other legal action. London Borough of Hillingdon 100019263 ©2012



TRANSPORT & PROJECTS PLANNING, DESIGN SERVICES, TOWN AND COMMUNITY SERVICES DIRECTORATE
 Civic Centre 4th/5th, High Street, Uxbridge, UB8 3JW
 Tel No. 01895 277005/01895 250876

Project
Eastbury Road, Northwood

Description
Proposed business permit parking bays

Scale
1:500 (a4) Form (Final/Rev)
KU 11/12

LONDON BOROUGH OF HILLINGDON
THE HILLINGDON) (RUISLIP)(RESIDENTS ZONE MW) (ON STREET PARKING PLACES)
ORDER 2013. THE HILLINGDON (WAITING AND LOADING RESTRICTION)
(CONSOLIDATION) (AMENDMENT NO.) ORDER 2013
MONARCH'S WAY, RUISLIP PARKING MANAGEMENT SCHEME

Hillingdon Council gives notice that it intends to make these Orders, which will amend the proposals advertised on 11th July 2012 to:

1. **Establish permit parking places** (operational between **8.00am and 10.00pm Monday to Sunday**) in which a vehicle may be left during the permitted hours if it displays a valid MW permit in Monarch's Way.
2. **Impose waiting restrictions** in Monarch's Way operational between **8.00am and 10.00pm Monday to Sunday**.
3. **Remove proposed permit holder only parking place**
 - i. outside Nos. 13 and 15 Monarch's Way .
 - ii. outside Nos. 24 and 26 Monarch's Way.
4. **Reduce the length of a proposed permit holder only place** adjacent to No. 4 Monarch's Way. New extent of parking place: Northern most northwest to southeast arm, northeast side, from a point 2.2 metres northwest of the southeastern flank wall of No.1 Monarch's Way, northwestwards for a distance of 9.5 metres.

RESIDENTS PERMITS - £0 - 1st vehicle, all subsequent - £40 per annum

VISITORS VOUCHERS First book of 10 per household per annum- free.
£5 - per book of 10 thereafter.

Copies of the proposed Orders together with full details, a plan and the Council's statement of reasons for the proposals can be seen at Ruislip Library and by appointment at, Civic Centre, Uxbridge during normal office hours until 27th February 2013. Further information can be obtained by telephoning Residents Services on 01895 277006.

If you wish to comment on, or object to the proposals please write by 27th February 2013, stating grounds for objection and your home address to Transport & Projects, Residents Services, Civic Centre, Uxbridge, Middlesex UB8 1UW quoting reference 4W/06/7.11/KU

Dated this 6th of February 2013

JEAN PALMER,

Deputy Chief Executive & Corporate Director Residents Services.

STATEMENT OF REASONS

To respond to views submitted by residents and businesses from the Council's consultation, the scheme will deter all day parking, improve road access and promote road safety.

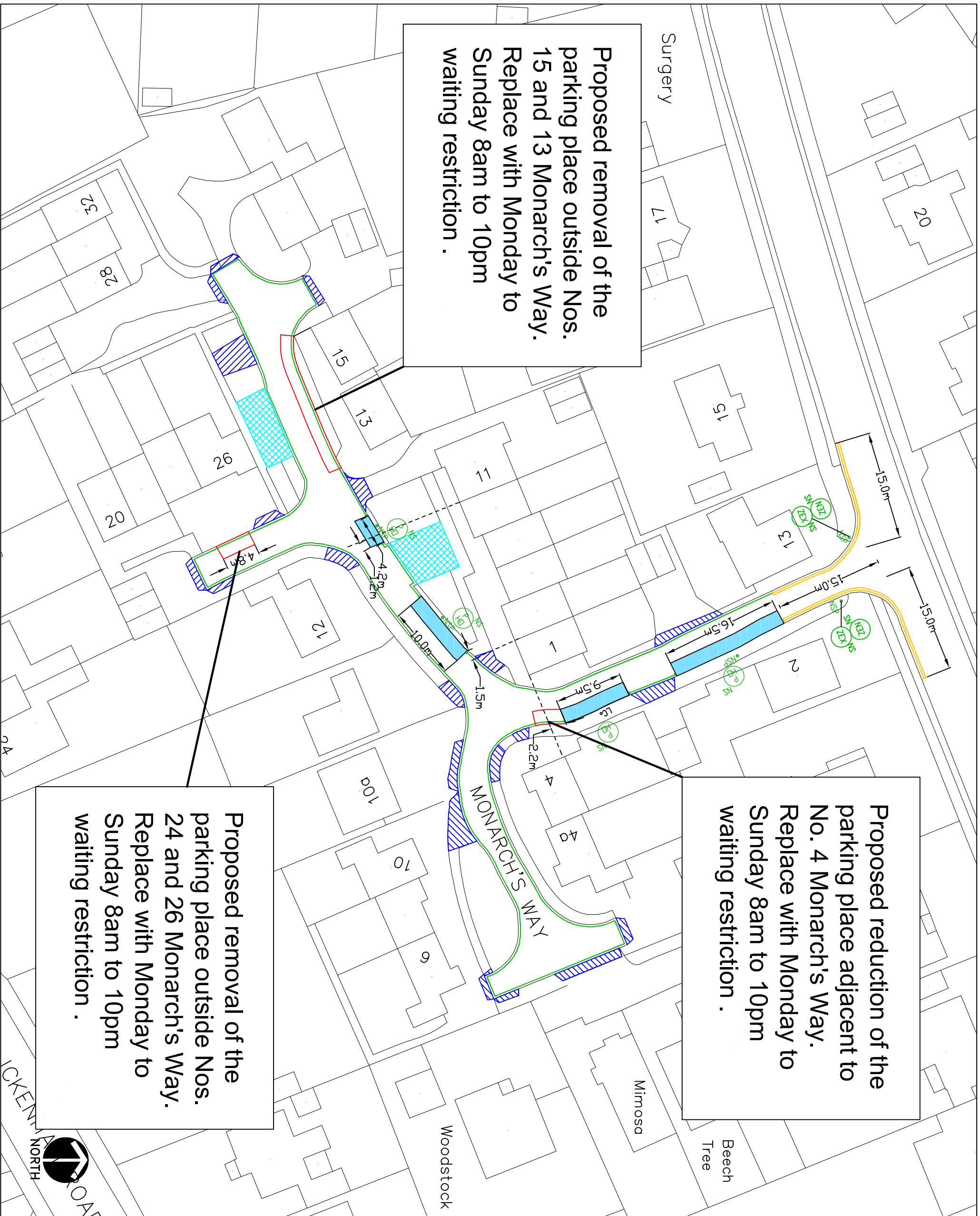

Proposed removal of the parking place outside Nos. 15 and 13 Monarch's Way. Replace with Monday to Sunday 8am to 10pm waiting restriction .

Proposed reduction of the parking place adjacent to No. 4 Monarch's Way. Replace with Monday to Sunday 8am to 10pm waiting restriction .

Proposed removal of the parking place outside Nos. 24 and 26 Monarch's Way. Replace with Monday to Sunday 8am to 10pm waiting restriction .

- KEY**
- EXISTING YELLOW LINE
 - NEW SINGLE YELLOW LINE & TERMINAL
 - PERMIT HOLDER ONLY BAY
 - OPERATIONAL MONDAY TO SUNDAY 8AM TO 10PM
 - PARKING BAYS ARE 2m WIDE UNLESS NOTED
 - EXTENT OF PRIVATE PARKING AREAS
 - LAMP COLUMN
 - NEW SIGN & POST
 - CROSSOVER
 - PERMIT HOLDER ONLY SIGN
 - ZONE ENTRY SIGN
 - OPERATIONAL MONDAY TO SUNDAY 8AM TO 10PM
 - ZONE EXIT SIGN
 - REMOVAL OF PROPOSED PARKING PLACE

This map is based upon Ordnance Survey material with the permission of Ordnance Survey on behalf of the Controller of Her Majesty's Stationary Office © Crown copyright. Unauthorised reproduction infringes Crown copyright and may lead to prosecution or civil proceedings.
London Borough of Hillingdon 100019283 ©2011

HILLINGDON
LONDON

TRANSPORT & PROJECTS
PLANNING, ENVIRONMENT, EDUCATION AND
AND COMMUNITY SERVICES DIRECTORATE
Civic Centre 4th/5th, High Street, Uxbridge, UB8 3UW
Tel No. 01895 277009/01895 250676

Project
Monarch's Way

Description
Amendments to the proposed Parking Management Scheme

Scale 1:500(A3)	Designed KU	Drawn KU	Date 09/10/12
Project No.	Drawing No.	Rev.	

