

LONDON BOROUGH OF HILLINGDON
THE HILLINGDON (WAITING AND LOADING RESTRICTION) (CONSOLIDATION) ORDER
1994 (AMENDMENT NO.) ORDER 2012
DENZILOE AVENUE, HILLINGDON

Hillingdon Council gives notice that it intends to make these Orders which will impose waiting restrictions on the lengths of road as set out in the Schedule to this notice.

Copies of the proposed Orders together with a plan and the Council's statement of reasons for the proposals can be seen at Oak Farm Library during library opening hours until 21 November 2012 and at the Civic Centre, Uxbridge by appointment during normal office hours until 6 weeks after either, the order is made or the Council decides not to proceed Further information can be obtained by telephoning Planning, Environment, Education and Community Services Directorate on 01895 277006.

If you wish to comment on, or object to the proposals please write by 21 November 2012, stating grounds for objection and your home address, to Transport and Projects, Planning, Environment, Education and Community Services, Civic Centre, Uxbridge, Middlesex UB8 1UW quoting reference KU/04670

Dated this 31 day of October 2012

JEAN PALMER

Deputy Chief Executive & Corporate Director of Planning, Environment, Education and Community Services.

SCHEDULE

WAITING AND LOADING PROHIBITED "AT ANY TIME"

DENZILOE AVENUE, HILLINGDON – Southeast side – Between a point in line with the northeastern kerbline of Uxbridge Road and point 2 metres southwest of the northeastern boundary of No. 24 New Broadway.

STATEMENT OF REASONS

The proposed waiting and loading restrictions will improve access and promote road safety.

Appendix C

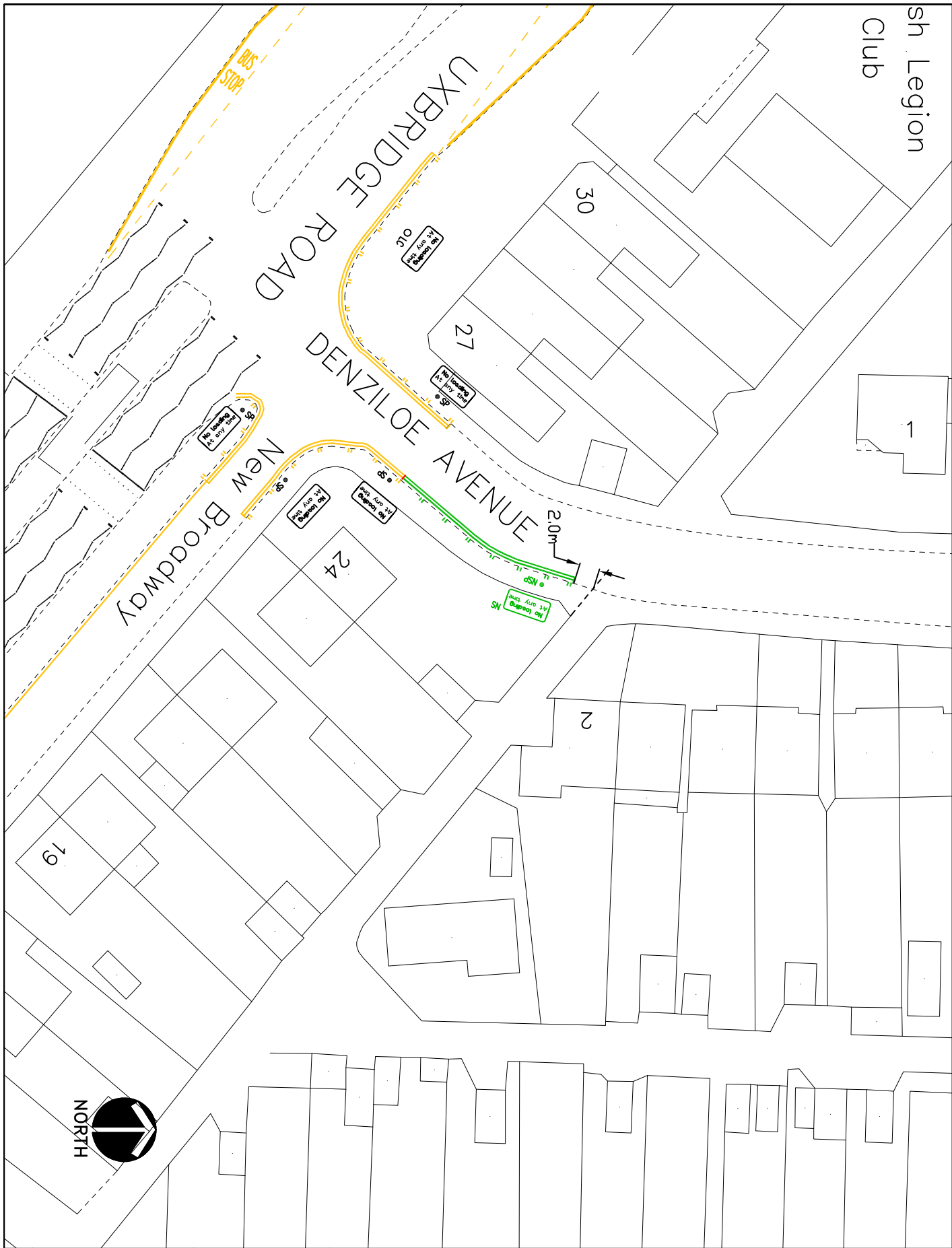

KEY	
	EXISTING YELLOW LINE
	PROPOSED DOUBLE YELLOW LINE & TERMINAL
	EXISTING 'AT ANY TIME' LOADING RESTRICTIONS
	PROPOSED 'AT ANY TIME' LOADING RESTRICTIONS
	SP SIGNPOST
	NSP NEW SIGNPOST
	NS NEW SIGN
	OLC LAMP COLUMN

This map is based upon Ordnance Survey material with the permission of Ordnance Survey on behalf of the Controller of Her Majesty's Stationery Office. All Crown Copyright. This map is the property of Hillingdon Council and may be used for presentation or other proceedings. London Borough of Hillingdon 100019283 ©2012



HILLINGDON
LONDON

TRANSPORT & PROJECTS
PLANNING, ENVIRONMENT, EDUCATION
AND COMMUNITY SERVICES DIRECTORATE
ONE CENTRE WAY, URBAN PARK, HILLINGDON, LONDON, UK
Tel: No. 01895 272005/01895 258578

Denziloe Avenue

Proposed 'at any time' loading and waiting restrictions

Scale: 1:500 (a4)
Form: (final/04/12)
Project: KU 26/06/12

LONDON BOROUGH OF HILLINGDON
THE HILLINGDON (WAITING AND LOADING RESTRICTION) (CONSOLIDATION) ORDER
1994 (AMENDMENT NO.) ORDER 2012
PROPOSED WAITING RESTRICTIONS

HILL LANE (OUTSIDE NOS. 22-48 EVEN AND NOS. 25-39 ODD) & HILL RISE, RUISLIP
Hillingdon Council gives notice that it intends to make these Orders which will impose '11am to Midday Monday to Friday' waiting restrictions on Hill Rise and part of Hill Lane (outside Nos. 22-48 even and Nos. 25-39 odd) with 'at any time' waiting restrictions around the junctions.

Copies of the proposed Orders together with a plan and the Council's statement of reasons for the proposals can be seen at Ruislip Library during library opening hours until 21 November 2012 and at the Civic Centre, Uxbridge by appointment during normal office hours until 6 weeks after either, the order is made or the Council decides not to proceed.

Further information can be obtained by telephoning Planning, Environment, Education and Community Services Directorate on 01895 277006. If you wish to comment on, or object to the proposals please write by 21 November 2012, stating grounds for objection and your home address, to Transport and Projects, Planning, Environment, Education and Community Services, Civic Centre, Uxbridge, Middlesex UB8 1UW quoting reference 4W/06/07900/07910.

Dated this 31 day of October 2012

JEAN PALMER

Deputy Chief Executive & Corporate Director of Planning, Environment, Education and Community Services.

STATEMENT OF REASONS

The proposals reflect responses received to informal consultation with residents for limited time waiting restrictions, which will help restore the balance of parking in favour of residents and their visitors and promote road safety.



KEY

- NEW SINGLE YELLOW LINE & TERMINAL OPERATIONAL MON - FRI 11AM - MIDDAY
- NEW DOUBLE YELLOW LINE & TERMINAL
- NEW SIGNPOST
- NEW SIGN
- NEW SIGNPOST
- NEW SIGN



This map is based upon Ordnance Survey material with the permission of Ordnance Survey on behalf of the Controller of Her Majesty's Stationary Office. Crown copyright. Unauthorised reproduction infringes Crown copyright and may lead to prosecution or civil proceedings.
 London Borough of Hillingdon 100019283 ©2012

HILLINGDON
 TRANSPORT & PROJECTS
 PLANNING, ENVIRONMENT, EDUCATION AND COMMUNITY SERVICES DIRECTORATE
 CIVIC CENTRE 4W/05, HIGH STREET, UXBRODE, UBA 11W
 TEL NO. 01895 277000/01895 250676

Hill Lane / Hill Rise
 Proposed
 waiting restrictions

Scale 1:150(A3)	Designed KU	Drawn KU	Date 04/10/12
--------------------	----------------	-------------	------------------

LONDON BOROUGH OF HILLINGDON
 THE HILLINGDON (HIGH STREET, RUISLIP) (STOP AND SHOP SCHEME) (ON STREET
 PARKING PLACES) ORDER 2005 (AMENDMENT NO.) 2012
 THE HILLINGDON (WAITING AND LOADING RESTRICTION) (CONSOLIDATION) ORDER
 1994(AMENDMENT NO.) ORDER 2012

PROPOSED AMENDMENTS TO THE RUISLIP STOP & SHOP PARKING SCHEME
 Hillingdon Council gives notice that it intends to make these Orders which will:-

1. **Extend the time permitted for goods vehicles to load and unload from 20 minutes to 40 minutes** - within the existing loading bays as indicated on Schedule 1 to this notice
2. **Establish disabled parking bays** - in which only vehicles displaying a Blue Badge may be left at all times on sections of roads as indicated on Schedule 2 to this notice
3. **Establish Pay and display parking bays operational between 8.00am and 6.30pm Monday to Saturday** outside Nos. 3-9 Ickenham Road, Ruislip. The maximum period for which a vehicle may be left during the permitted hours is two hours, if it displays a valid ticket from a ticket parking machine with the charges shown below.

Parking Period	Standard Charge	HillingdonFirst Cardholder Tariff
30 minutes	Free(on displaying a ticket)	Free(on displaying a ticket)
60 minutes	70p	20p
90 minutes	£1.40	40p
Up to 2 hours	£2.10	60p

Copies of the proposed Orders together with a plan and the Council's statement of reasons for the proposals can be seen at Manor Farm Library during library opening hours until 21st November 2012 and at the Civic Centre, Uxbridge by appointment during normal office hours until 6 weeks after either, the order is made or the Council decides not to proceed Further information can be obtained by telephoning Planning, Environment, Education and Community Services Directorate on 01895 277014.

If you wish to comment on, or object to the proposals please write by 21st November 2012, stating grounds for objection and your home address, to Transport and Projects, Planning, Environment, Education and Community Services, Civic Centre, Uxbridge, Middlesex UB8 1UW quoting reference KU/7.17.

Dated this 31st day of October 2012

JEAN PALMER

Deputy Chief Executive and Corporate Director of Planning, Environment, Education and Community Services.

SCHEDULE 1

HIGH STREET RUISLIP, the lay-by opposite Nos. 16 to 18 High Street.

ICKENHAM ROAD, the southeast side, from a point 4 metres northeast of the common boundary of No.1 Ickenham Road and No.86 High Street southwestwards for a distance of 13.8 metres.

HIGH STREET RUISLIP, the southwest side, from a point in line with the common boundary of Nos. 116 and 118 High Street southeastwards for a distance of 14 metres. 1.8 metres wide.

HIGH STREET RUISLIP, the northeast side, from a point in line with the common boundary of Nos. 71 and 73 High Street southeastwards for a distance of 13 metres.

HIGH STREET RUISLIP, the southwest side, from a point in line with the common boundary of No. 142 and 144 High Street, Ruislip southeastwards for a distance of 11.2 metres.

HIGH STREET, RUISLIP, the south west side, between a point in line with the common boundary of Nos. 70 and 72 High Street, Ruislip and a point 12 metres south eastwards.

THE OAKS, the northwest side, from a point 5.5 metres northeast of the southwestern boundary of No.2 The Oaks northeastwards for a distance of 17.5 metres.

SCHEDULE 2

KING EDWARDS ROAD, the southeast side, from a point 11.8 metres southwest of the southwestern kerbline of High Street, southwestwards for a distance of 6.6 metres

KING EDWARDS ROAD, the southeast side, from a point 18.4 metres southwest of the southwestern kerbline of High Street, southwestwards for a distance of 6.6 metres

KING EDWARDS ROAD, the northwest side, from a point 10 metres southwest of the southwestern kerbline of High Street, southwestwards for a distance of 6.6 metres

KING EDWARDS ROAD, the northwest side, from a point 16.6 metres southwest of the southwestern kerbline of High Street, southwestwards for a distance of 6.6 metres

ICKENHAM ROAD, the northwest side, from a point in line with the common boundary of Nos. 2 and 4 Ickenham Road, southwestwards for a distance of 6.6 metres.

ICKENHAM ROAD, the northwest side, from a point 6.6 metres southwest of the common boundary of Nos. 2 and 4 Ickenham Road, southwestwards for a distance of 6.6 metres.

STATEMENT OF REASONS

The proposed pay & display parking on Ickenham Road will provide parking for customers to nearby businesses. The additional disabled parking bays will provide an increase in parking for blue badge holders. The increase in the times to load and unload within the loading bays will improve servicing to the shops whilst still maintaining a good turn over of spaces.

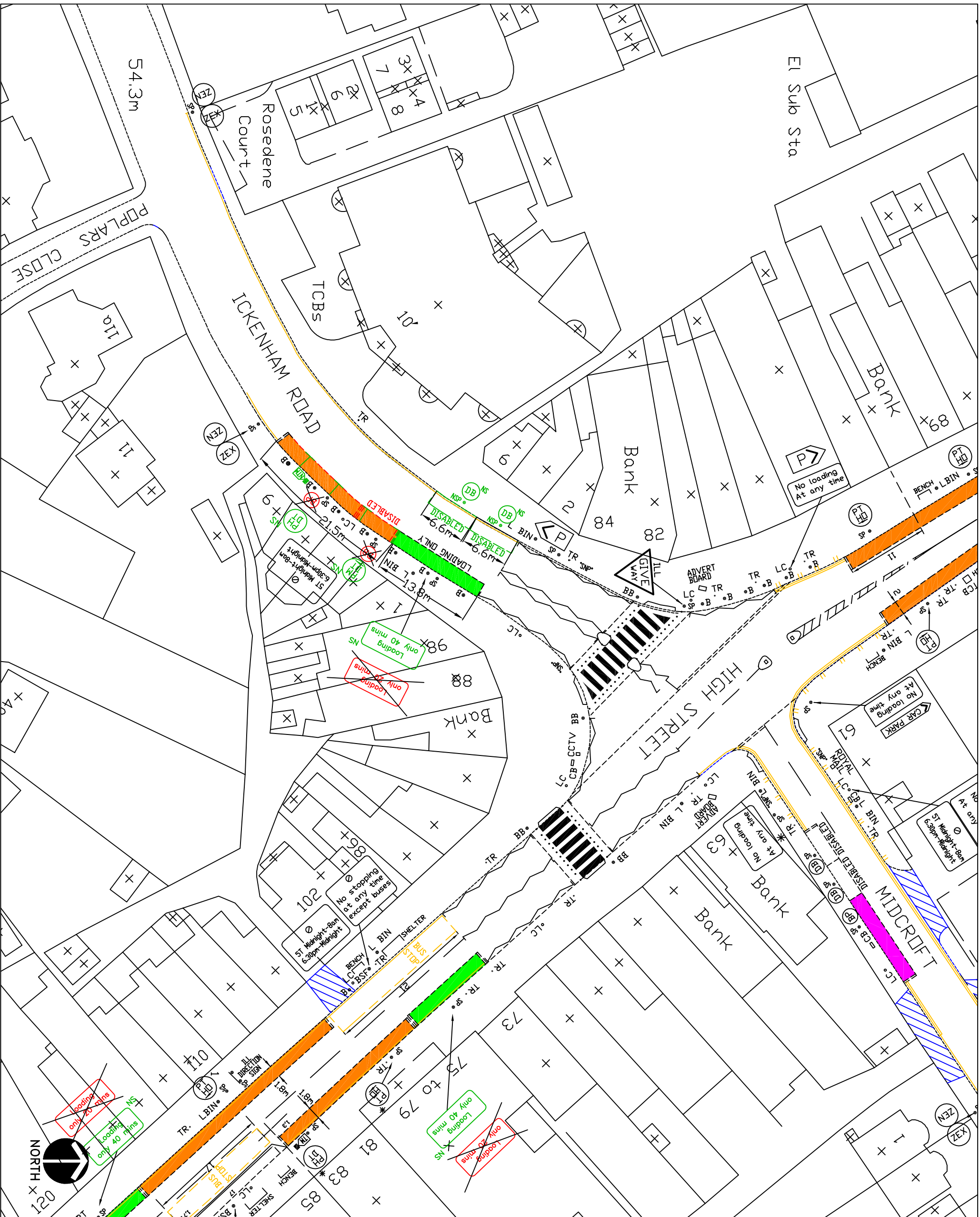

KEY

	EXISTING YELLOW LINE
	NEW SINGLE YELLOW LINE & TERMINAL
	NEW DOUBLE YELLOW LINE & TERMINAL
	PAY AND DISPLAY AND PERMIT HOLDERS
	PAY & DISPLAY BAY
	BUSINESS, PERMIT HOLDER ONLY BAY
	LOADING BAY
	SIGNPOST
	LAMP COLUMN
	CROSSOVER
	PERMIT HOLDER ONLY SIGN
	PERMIT OR TICKET HOLDER
	PAY AT METER - DISPLAY TICKET SIGN
	PAY HERE - DISPLAY TICKET SIGN
	BUSINESS PERMIT HOLDER SIGN
	DISABLED PARKING BAY SIGN
	LOADING ONLY BAY SIGN
	MOTORCYCLES ONLY BAY SIGN
	ZONE ENTRY SIGN
	ZONE EXIT SIGN
	NEW TICKET MACHINE
	NEW SIGNPOST
	REMOVE SIGN
	REMOVE LINE

This map is based upon Ordnance Survey material with the permission of Ordnance Survey on behalf of the Controller of Her Majesty's Stationery Office. Crown copyright. Unauthorised reproduction infringes Crown copyright and may lead to prosecution or civil proceedings.

London Borough of Hillingdon 100019283 ©2011



HILLINGDON
 COUNCIL

TRANSPORT & PROJECTS
 PLANNING, ENVIRONMENT, EDUCATION AND
 AND COMMUNITY SERVICES DIRECTORATE
 CMC CENTRE 4W/OS, HIGH STREET, UXBRODE, UBA 11W
 Tel No. 01895 277008/01895 250876

Project
**Ickenham Road,
 Ruislip**

Description
Proposed new layout

Scale 1:500(A3)	Designed KU	Drawn KU	Date 30/01/11
Project No.	Drawing No.	Rev.	

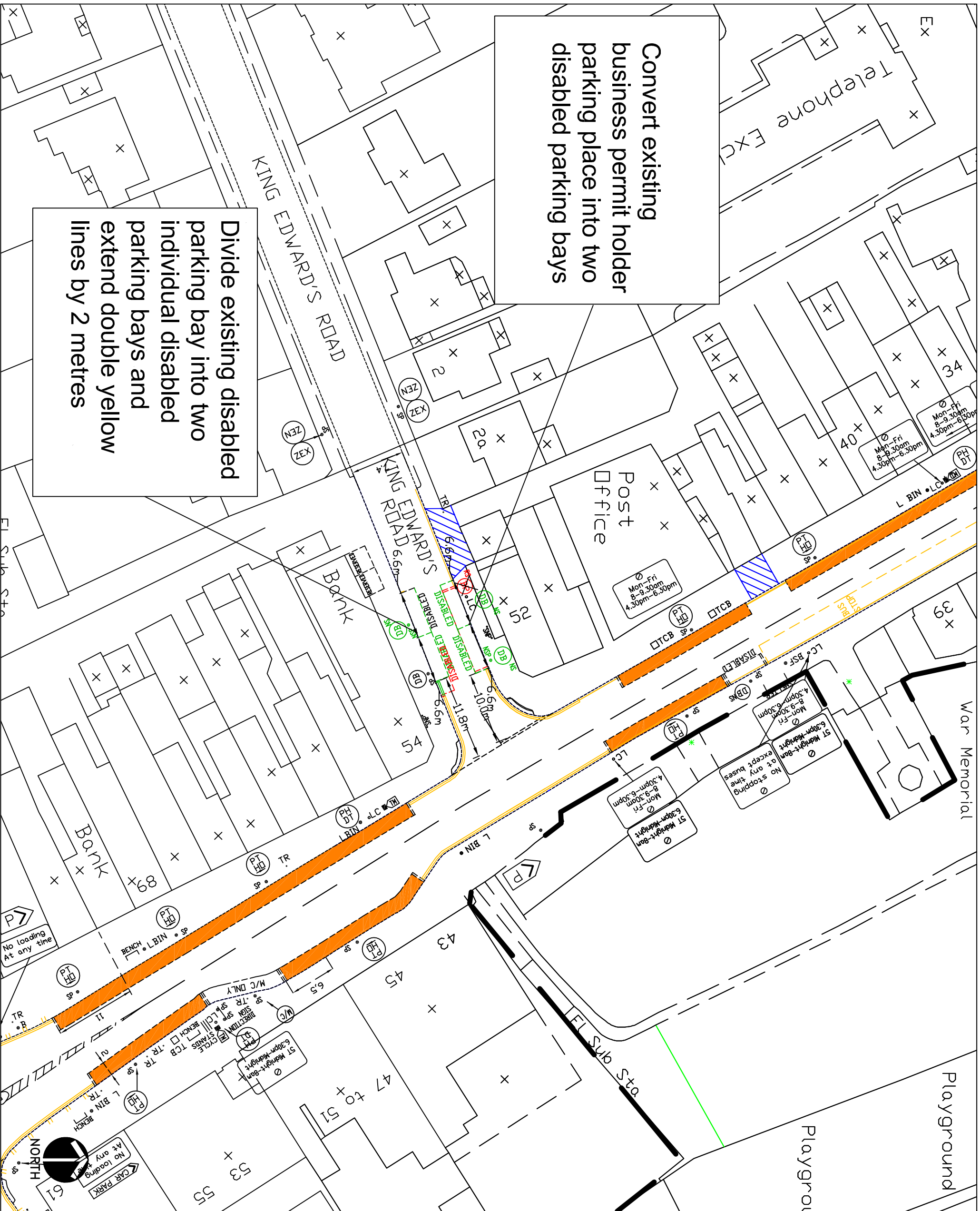

Convert existing business permit holder parking place into two disabled parking bays

Divide existing disabled parking bay into two individual disabled parking bays and extend double yellow lines by 2 metres

KEY

- EXISTING YELLOW LINE
- NEW SINGLE YELLOW LINE & TERMINAL
- NEW DOUBLE YELLOW LINE & TERMINAL
- PAY AND DISPLAY AND PERMIT HOLDERS
- PAY & DISPLAY BAY
- BUSINESS, PERMIT HOLDER ONLY BAY
- LOADING BAY
- SIGNPOST
- LAMP COLUMN
- CROSSOVER
- PERMIT HOLDER ONLY SIGN
- PERMIT OR TICKET HOLDER
- PAY AT METER - DISPLAY TICKET SIGN
- PAY HERE - DISPLAY TICKET SIGN
- BUSINESS PERMIT HOLDER SIGN
- DISABLED PARKING BAY SIGN
- LOADING ONLY BAY SIGN
- MOTORCYCLES ONLY BAY SIGN
- ZONE ENTRY SIGN
- ZONE EXIT SIGN
- NEW TICKET MACHINE
- NEW SIGNPOST
- REMOVE SIGN
- REMOVE LINE

This map is based upon Ordnance Survey material with the permission of Ordnance Survey on behalf of the Controller of Her Majesty's Stationary Office. Crown copyright. Unauthorised reproduction infringes Crown copyright and may lead to prosecution or civil proceedings.
London Borough of Hillingdon 100019283 ©2011

HILLINGDON
LONDON
TRANSPORT & PROJECTS
PLANNING, ENVIRONMENT, EDUCATION AND
AND COMMUNITY SERVICES DIRECTORATE
Civic Centre 4W/05, High Street, Uxbridge, UB8 1UW
Tel No. 01895 277008/01895 250876

Project
**King Edwards Road,
Ruislip**

Description
Proposed new layout

Scale 1:500(A3)	Designed KU	Drawn KU	Date 30/01/11
Project No.	Drawing No.	Rev.	

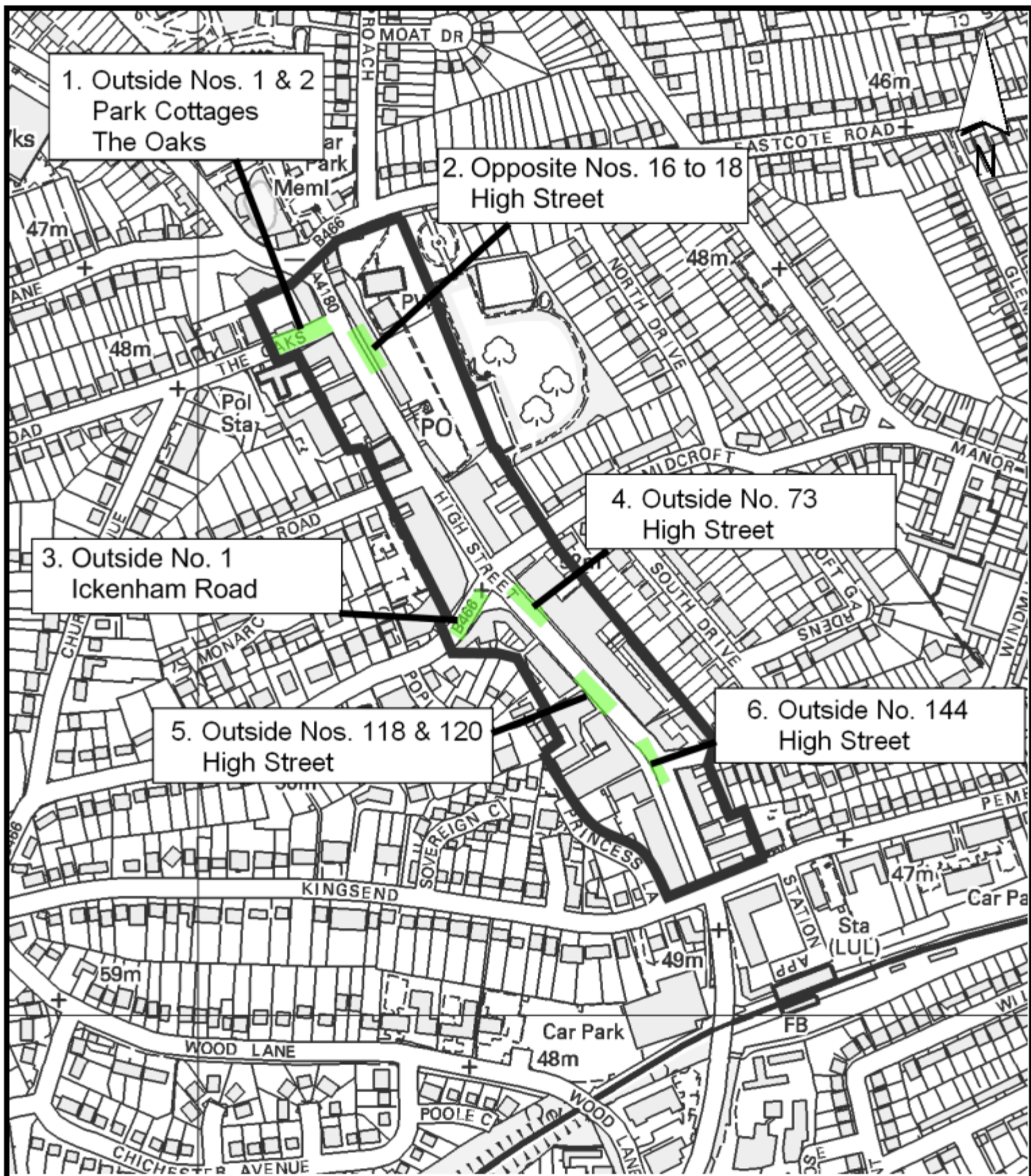

Ruislip 'Stop & Shop' Parking Scheme - Loading bays

Appendix B

Date March 2012

Scale: 1:4500



Extent of Ruislip High Street 'Stop & Shop' Parking Scheme

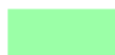

Approximate location of loading bay

THE HILLINGDON (FREE PARKING PLACES) (DISABLED PERSONS)
TRAFFIC ORDER 2012. RESERVOIR ROAD, RUISLIP

Hillingdon Council gives notice that it intends to make these Orders which will

a) Install a disabled parking place in Reservoir Road, Ruislip, on the southeast side, from a point opposite a point 9 metres northeast of the northeastern flank wall on No. 57 Reservoir Road, northeastwards for a distance of 10 metres.

Copies of the proposed Orders together with plans and the Council's statement of reasons for the proposals can be seen at Manor Farm Library, during library opening hours until 21 November 2012 and at the Civic Centre, Uxbridge by appointment, until 6 weeks after, either the Order is made or the Council decides not to make the Orders.

Further information can be obtained by telephoning Planning, Environment, Education and Community Services Directorate on 01895 277014.

If you wish to comment on, or object to the proposals please write by 21 November 2012, stating grounds for objection and your home address, to Transport and Projects, Planning, Environment, Education and Community Services, Civic Centre, Uxbridge, Middlesex UB8 1UW quoting reference 4W/06/7.05

Dated this 31 day of October 2012

JEAN PALMER

Deputy Chief Executive and Corporate Director of Planning, Environment, Education and Community Services.

STATEMENT OF REASONS

The proposed disabled parking bay is intended to improve accessibility for blue badge holders by providing an area for parking close to Ruislip Lido.

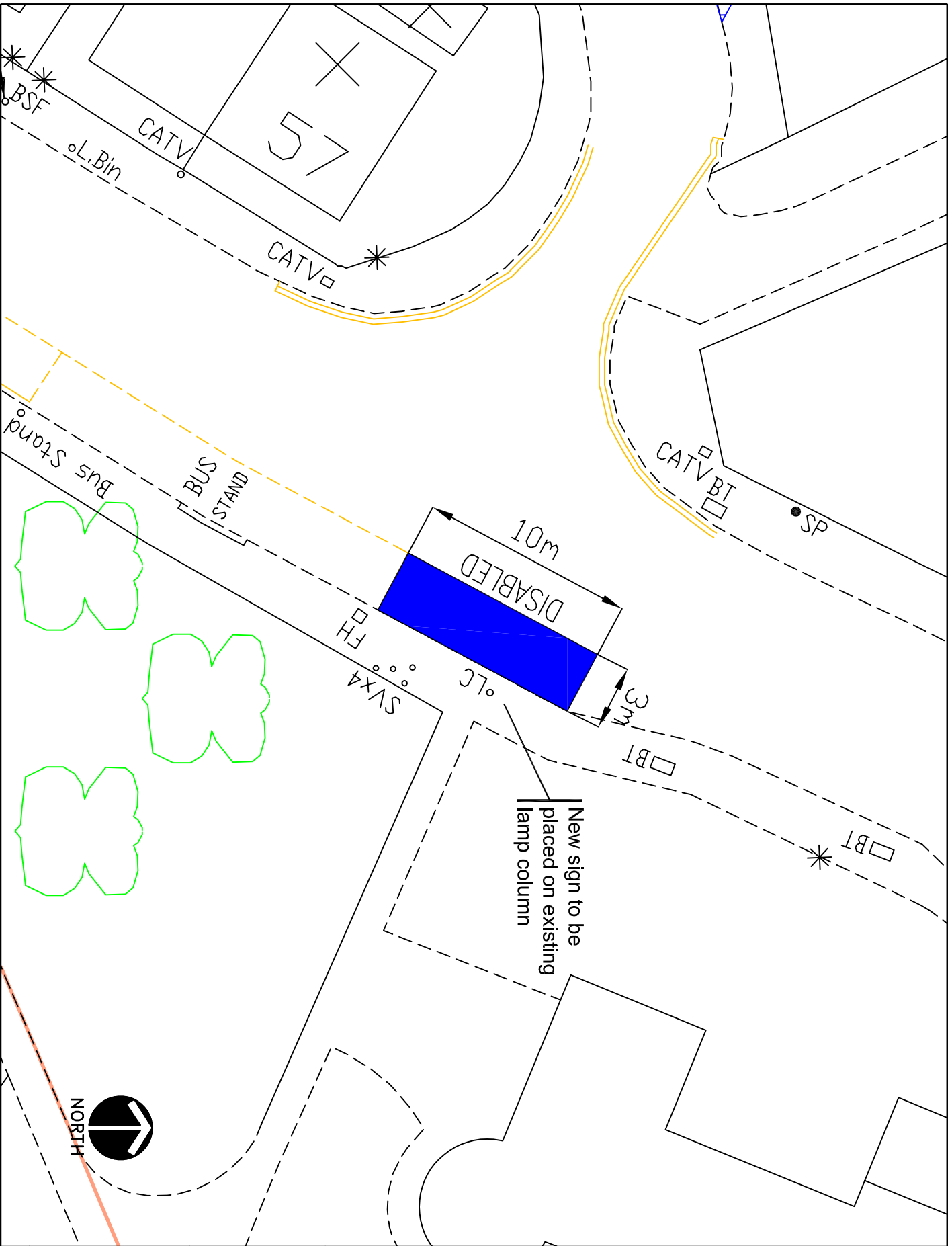

KEY

	EXISTING YELLOW LINE
	NEW DOUBLE YELLOW LINE & TERMINAL
	NEW SINGLE YELLOW LINE & TERMINAL
	CROSSOVER
	DISABLED BAY

This map is based upon Ordnance Survey material with the permission of Ordnance Survey on behalf of the Controller of Her Majesty's Stationery Office. All Crown Copyright. This map is published with the permission of the copyright and may lead to prosecution or other proceedings.

London Borough of Hillingdon 100019283 ©2011



HILLINGDON
LONDON

TRANSPORT & PROJECTS
PLANNING, ENVIRONMENT, EDUCATION
AND COMMUNITY SERVICES DIRECTORATE
ONE CENTRE WAY, 27/205/1985 255716

Project
Reservoir Road
Ruislip Lido

Description
Proposed blue badge
disabled bay

Scale
Drawn: GH/100CH12