

LONDON BOROUGH OF HILLINGDON
THE HILLINGDON (WAITING AND LOADING RESTRICTION)
(CONSOLIDATION) (AMENDMENT NO.) ORDER 2012
BURY STREET, RUISLIP

Hillingdon Council gives notice that it intends to make this Order which will impose waiting restrictions on the lengths of road as set out in the Schedule to this notice. Copies of the proposed Order together with a plan and the Council's statement of reasons for the proposal can be seen at Manor Farm Library until 11 January 2012 and at the Civic Centre, Uxbridge by appointment during normal office hours until 6 weeks after either, the order is made or the Council decides not to proceed. Further information can be obtained by telephoning Planning, Environment, Education and Community Services on 01895 277014. If you wish to comment on, or object to the proposals please write by 11 January 2012, stating grounds for objection and your home address to Transport and Projects, Planning, Environment, Education and Community Services Civic Centre, Uxbridge, Middlesex UB8 1UW quoting reference 4W/06/CH/1/02260.

Dated this 14 day of December 2011

JEAN PALMER

Corporate Director of Planning, Environment, Education and Community Services.

SCHEDULE
WAITING PROHIBITED AT ANY TIME

BURY STREET, RUISLIP

The south-west side, from a point in line with the common boundary of No 3 and No 5 Bury Street northwestwards for a distance of 10.2 metres.

STATEMENT OF REASONS

The proposed waiting restrictions are intended to remove obstructive parking to assist the free flow of traffic and promote road safety. All proposals have been signed off by the Cabinet Member for Planning, Transportation and Recycling to proceed to formal consultation.

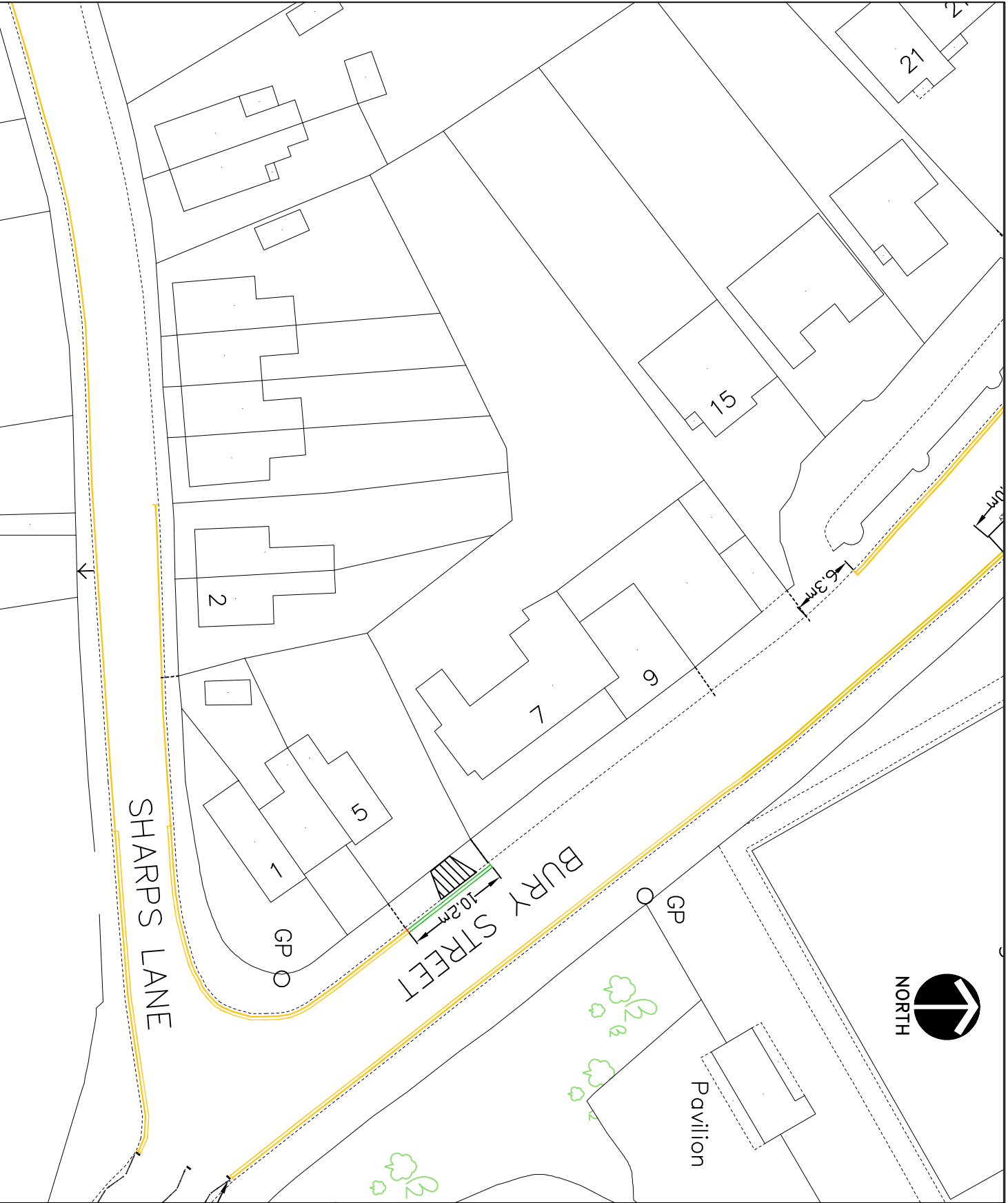

KEY
 EXISTING YELLOW LINE
 DYL NEW DOUBLE YELLOW LINE
 & TERMINAL

This map is based upon Ordnance Survey material with the permission of Ordnance Survey. All rights reserved. Ordnance Survey copyright. Unauthorised reproduction infringes Crown copyright and may lead to prosecution or civil proceedings.
 London Borough of Hillingdon 10015933 ©2010



IMPROVEMENT PROJECTS
 PLANNING SERVICES DIRECTORATE
 COMMUNITY
 CIVIC CENTRE 4th/5th, HIGH STREET, URBIDGE, URB 10W
 Tel No. 01895 277009/01895 250676

Project
 Bury Street,
 Ruislip

Description	
Scale	Drawn (initials/date)
N.T.S.	
Project No.	Checked (initials/date)
A4	
Drawing No.	Rev.

LONDON BOROUGH OF HILLINGDON
THE HILLINGDON (WAITING AND LOADING RESTRICTION)
(CONSOLIDATION) (AMENDMENT NO.) ORDER 2012
CLIVESDALE DRIVE, HAYES

Hillingdon Council gives notice that it intends to make this Order which will impose waiting restrictions on the lengths of road as set out in the Schedule to this notice. Copies of the proposed Order together with a plan and the Council's statement of reasons for the proposal can be seen at Botwell Green Library until 11 January 2012 and at the Civic Centre, Uxbridge by appointment during normal office hours until 6 weeks after either, the order is made or the Council decides not to proceed. Further information can be obtained by telephoning Planning, Environment, Education and Community Services on 01895 277014. If you wish to comment on, or object to the proposals please write by 11 January 2012, stating grounds for objection and your home address to Transport and Projects, Planning, Environment, Education and Community Services Civic Centre, Uxbridge, Middlesex UB8 1UW quoting reference 4W/06/CH/1/02260.

Dated this 14 day of December 2011

JEAN PALMER

Corporate Director of Planning, Environment, Education and Community Services.

SCHEDULE
WAITING PROHIBITED AT ANY TIME

CLIVESDALE DRIVE, HAYES



- a) Northeast to southwest arm,
 - i) the south-east side, from a point 10 metres southwest of the southwestern kerb line of Avondale Drive to a point 10 metres southwest of the southwestern kerb line of the eastern northwest to southeast arm of Clivesdale Drive.
 - ii) The northwest side, from a point 10 metres northeast of the northeastern kerb line of the western northwest to southeast arm of Clivesdale Drive to a point 10 metres southwest of the southwestern kerb line of the western northwest to southeast arm of Clivesdale Drive.
- b) The eastern northwest to southeast arm
Both sides, from the southeastern kerb line of the northeast to southwest arm of Clivesdale Drive southeastwards for a distance of 10 metres.
- c) The western northwest to southeast arm
 - i) The northwest side, from the northwestern kerb line of the main northeast to southwest arm of Clivesdale Drive northwestwards to a point in line with the northwestern flank wall of No 10 & 12 Clivesdale Drive.
 - ii) The southwest side, from the northwestern kerb line of the main northeast to southwest arm of Clivesdale Drive northwestwards for a distance of 8.2 metres.

STATEMENT OF REASONS

The proposed waiting restrictions are intended to remove obstructive parking to assist the free flow of traffic and promote road safety. All proposals have been signed off by the Cabinet Member for Planning, Transportation and Recycling to proceed to formal consultation.



Notes:

-  DMT
PROPOSED DOUBLE YELLOW
LINE & TERMINAL
-  DMT
EXISTING DOUBLE YELLOW
LINE & TERMINAL

This map is based upon Ordnance Survey
 data and is not a substitute for the Survey
 of the Land. It is the responsibility of the
 user to ensure that the data is current and
 correct. The Ordnance Survey name and
 logo are registered trademarks of the
 Ordnance Survey. All other trademarks
 are the property of their respective owners.
 Copyright © Hillingdon London Borough
 Council 2010

HILLINGDON
LONDON



**Road Safety
programme**

Description Clivesdale Drive, Hayes	
Scale N.T.S. CH	Drawn (initials/date) 02/10
Project No. RSP1026D1	Checked (initials/date) Rev.

LONDON BOROUGH OF HILLINGDON
THE HILLINGDON (WAITING AND LOADING RESTRICTION)
(CONSOLIDATION) (AMENDMENT NO.) ORDER 2012
PAGET ROAD, UXBRIDGE ROAD, HAYES

Hillingdon Council gives notice that it intends to make this Order which will impose waiting restrictions on the lengths of road as set out in the Schedule to this notice. Copies of the proposed Order together with a plan and the Council's statement of reasons for the proposal can be seen at Oak Farm Library until 11 January 2012 and at the Civic Centre, Uxbridge by appointment during normal office hours until 6 weeks after either, the order is made or the Council decides not to proceed. Further information can be obtained by telephoning Planning, Environment, Education and Community Services on 01895 277014. If you wish to comment on, or object to the proposals please write by 11 January 2012, stating grounds for objection and your home address to Transport and Projects, Planning, Environment, Education and Community Services Civic Centre, Uxbridge, Middlesex UB8 1UW quoting reference 4W/06/CH/1/11830.

Dated this the 14 day of December 2012

JEAN PALMER

Corporate Director of Planning, Environment, Education and Community Services.

SCHEDULE
WAITING PROHIBITED AT ANY TIME

PAGET ROAD, HAYES

Both sides, from the northeastern kerb line of the service road fronting No 1390 Uxbridge Road to No 1 Addiscombe Court north eastwards for a distance of 10 metres.

UXBRIDGE ROAD, HAYES

Service road fronting No 1390 Uxbridge Road to No 1 Addiscombe Court
From a point 10 metres southeast of the southeastern kerb line of Paget Road to a point 10 metres northwest of the northwestern kerb line of Paget Road.

STATEMENT OF REASONS

The proposed waiting restrictions are intended to remove obstructive parking to assist the free flow of traffic and promote road safety. All proposals have been signed off by the Cabinet Member for Planning, Transportation and Recycling to proceed to formal consultation.

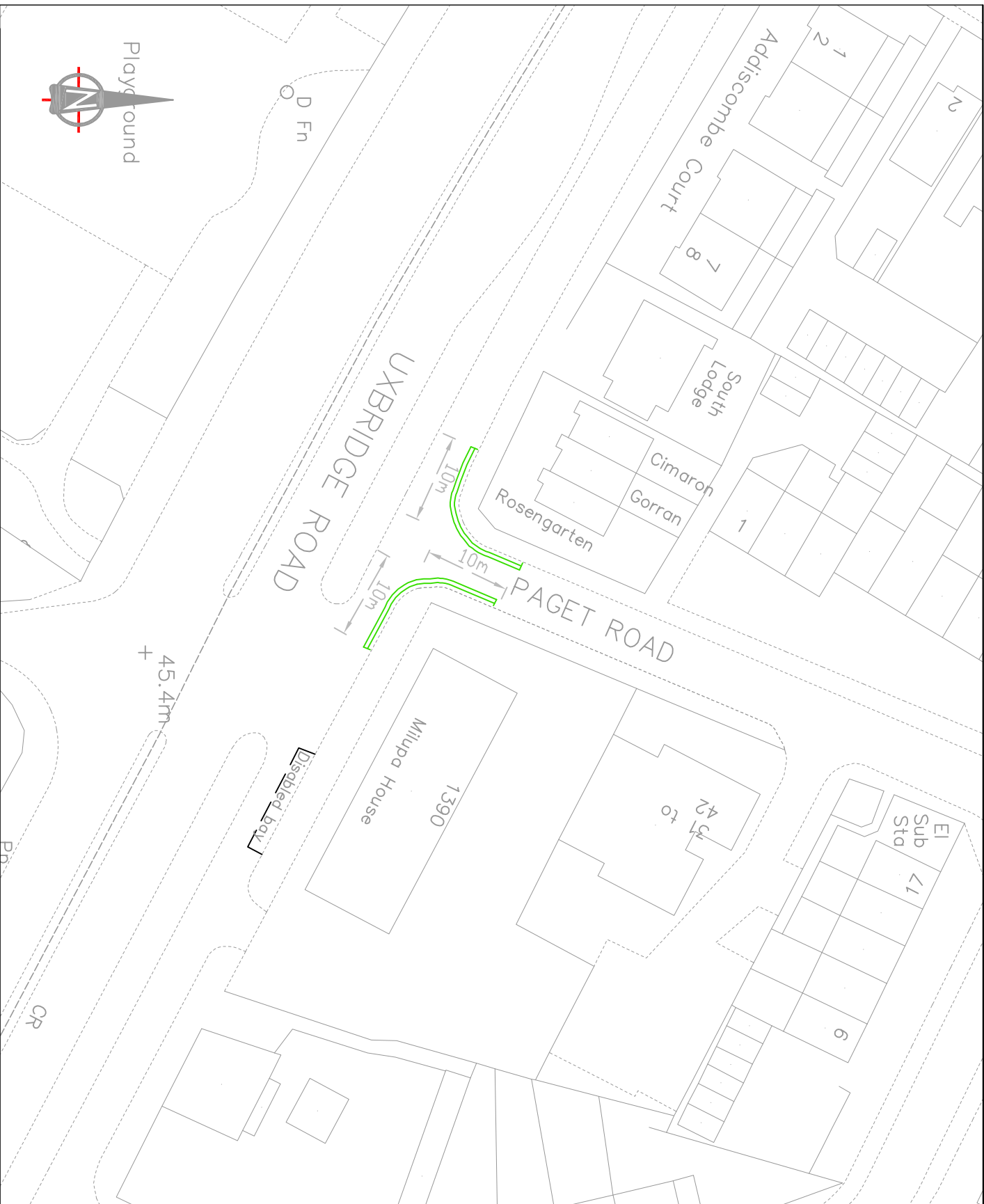

Notes:

 PROPOSED DOUBLE YELLOW LINE & TERMINAL

© Crown copyright and database rights 2014 Ordnance Survey 100019283



Project
Road Safety Programme

Description
Paget Road / Uxbridge Road, Hayes

Scale	Drawn	Checked
N.T.S	CH	(Initials/Date)
	10/11	
Project No.	Drawing No.	Rev.
A4		

LONDON BOROUGH OF HILLINGDON
THE HILLINGDON (WAITING AND LOADING RESTRICTION)
(CONSOLIDATION) (AMENDMENT NO.) ORDER 2012
BOURNE AVENUE, NINE ACRES CLOSE, HAYES

Hillingdon Council gives notice that it intends to make this Order which will impose waiting restrictions on the length of road as set out in the Schedule to this notice.

A copy of the proposed Order together with a plan and the Council's statement of reasons for the proposals can be seen at Botwell Green Library during library opening hours until 11 January 2012 and at the Civic Centre, Uxbridge by appointment during normal office hours until 6 weeks after either, the order is made or the Council decides not to proceed Further information can be obtained by telephoning Planning, Environment, Education and Community Services Directorate on 01895 277014.

If you wish to comment on, or object to the proposals please write by 11 January 2012, stating grounds for objection and your home address, to Transport and Projects, Planning, Environment, Education and Community Services, Civic Centre, Uxbridge, Middlesex UB8 1UW quoting reference 4W/06/BC/11237.

Dated this 14 day of December 2011

JEAN PALMER

Corporate Director of Planning, Environment, Education and Community Services.

SCHEDULE
WAITING PROHIBITED AT ANY TIME

NINE ACRES CLOSE, HAYES

the south east side, from a point in line with the northeastern flank wall of Sherman House, 20 Nine Acres Close to a point in line with the northeastern flank wall of Woolwich House, 2 Nine Acres Close.

STATEMENT OF REASONS

The proposed waiting restrictions are intended to enable introduction of a double decker bus service linking a new business park and residential area with Hayes and Uxbridge.

The measure will prevent obstructive parking taking place within a bend and enable drivers to proceed with caution through the residential area. The measure will significantly improve public transport accessibility in the area.

Nine Acres Close

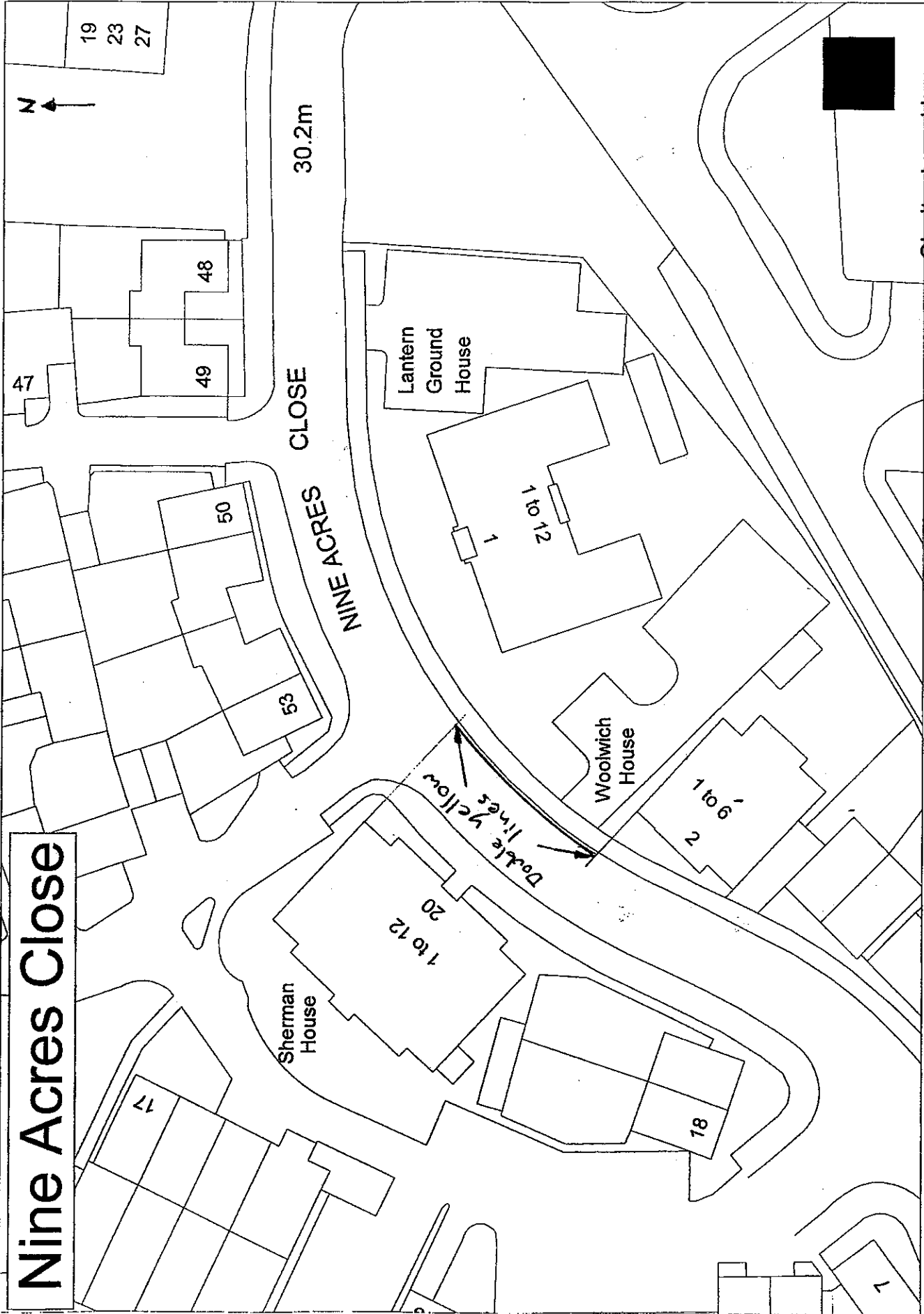

LONDON BOROUGH OF HILLINGDON
THE HILLINGDON (WAITING AND LOADING RESTRICTION)
(CONSOLIDATION) (AMENDMENT NO.) ORDER 2012
MAYFIELD CLOSE, HILLINGDON

Hillingdon Council gives notice that it intends to make this Order which will impose waiting restrictions on the lengths of road as set out in the Schedule to this notice. Copies of the proposed Order together with a plan and the Council's statement of reasons for the proposal can be seen at Oak Farm Library until 11 January 2012 and at the Civic Centre, Uxbridge by appointment during normal office hours until 6 weeks after either, the order is made or the Council decides not to proceed. Further information can be obtained by telephoning Planning, Environment, Education and Community Services on 01895 277014. If you wish to comment on, or object to the proposals please write by 11 January 2012, stating grounds for objection and your home address to Transport and Projects, Planning, Environment, Education and Community Services Civic Centre, Uxbridge, Middlesex UB8 1UW quoting reference 4W/06/CH/1/10040

Dated this 14 day of December 2011

JEAN PALMER

Corporate Director of Planning, Environment, Education and Community Services.

SCHEDULE
WAITING PROHIBITED AT ANY TIME

MAYFIELD CLOSE, HILLINGDON

The northeast side, from a point opposite a point in line with the common boundary of Nos. 62 and 63 Mayfield Close south-eastwards for a distance of 5 metres.

STATEMENT OF REASONS

The proposed waiting restrictions are intended to remove obstructive parking to assist the free flow of traffic and promote road safety. All proposals have been signed off by the Cabinet Member for Planning, Transportation and Recycling to proceed to formal consultation.

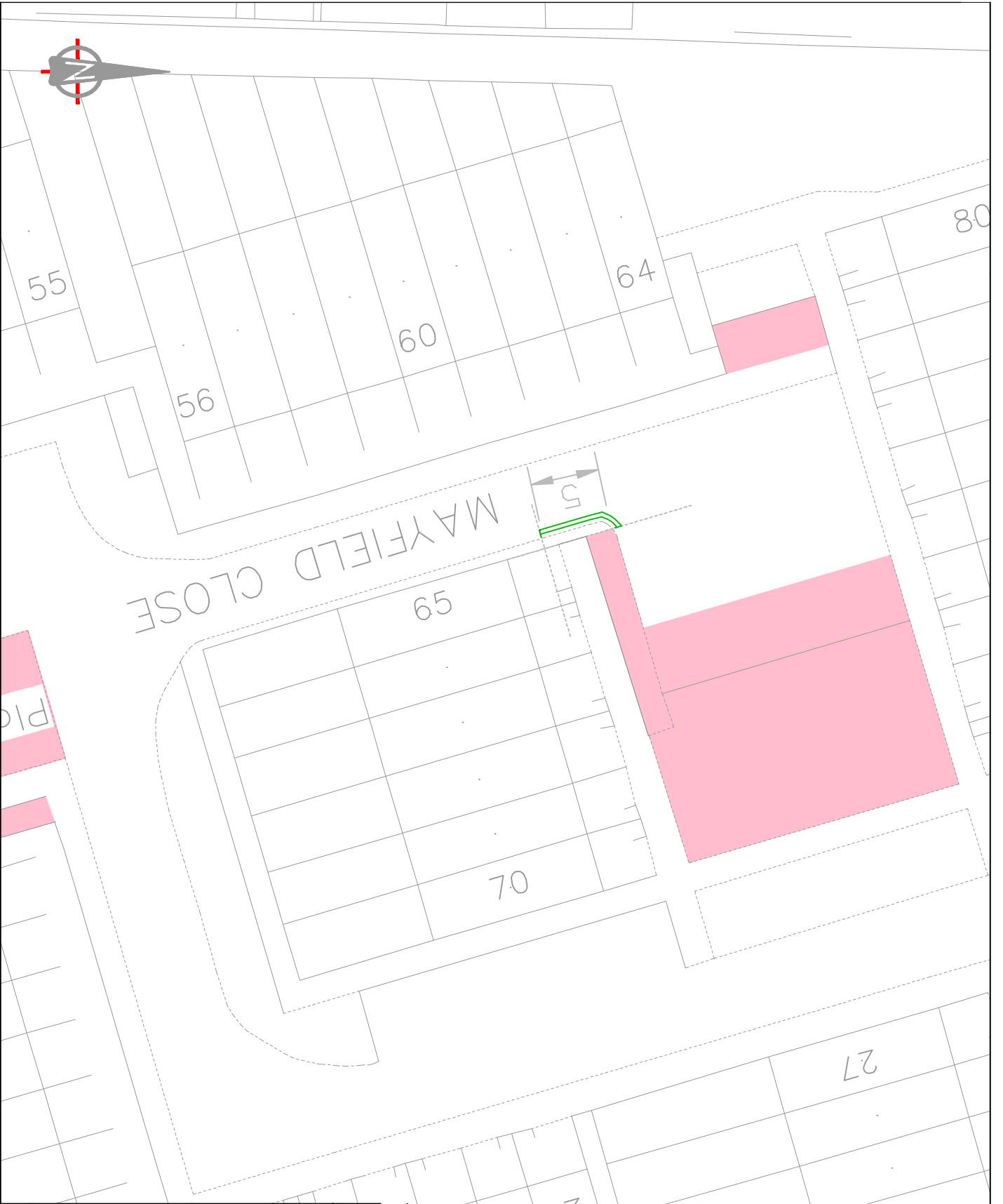

Notes:

DMT
PROPOSED DOUBLE YELLOW
LINE & TERMINAL

© Crown copyright and database
rights 2011 Ordnance Survey
100018285



HILLINGDON
LONDON

**Road Safety
Programme**

Mayfield Close, Hillingdon

Scale	Drawn (Initials/Date)	Checked (Initials/Date)
NTS	CH 08/11	
Project No.	Drawing No.	Rev.
A4		

LONDON BOROUGH OF HILLINGDON
THE HILLINGDON (WAITING AND LOADING RESTRICTION)
(CONSOLIDATION) (AMENDMENT NO.) ORDER 2012
PARKFIELD AVENUE, HILLINGDON

Hillingdon Council gives notice that it intends to make this Order which will

- a) impose waiting restrictions on the lengths of road as set out in Schedule 1 to this notice..
- b) remove the waiting restrictions operational between 8.00am and 6.30pm Monday to Saturday on the east side of Parkfield Avenue, between a point in line with the southwestern boundary of No. 2 Parkfield Avenue and a point in line with the northern wall of No. 6 Parkfield Avenue

A copy of the proposed Order together with a plan and the Council's statement of reasons for the proposals can be seen at Oak Farm Library until 11 January 2012 and at the Civic Centre, Uxbridge by appointment during normal office hours until 6 weeks after either, the order is made or the Council decides not to proceed. Further information can be obtained by telephoning Planning, Environment, Education and Community Services on 01895 277014. If you wish to comment on, or object to the proposals please write by 11 January 2012, stating grounds for objection and your home address to Transport and Projects, Planning, Environment, Education and Community Services Civic Centre, Uxbridge, Middlesex UB8 1UW quoting reference 4W/06/CH/1/11960.

Dated this the 14 day of December 2012

JEAN PALMER

Corporate Director of Planning, Environment, Education and Community Services.

SCHEDULE

WAITING PROHIBITED AT ANY TIME

PARKFIELD AVENUE, HILLINGDON

Both sides, between its junction with the service road fronting New Broadway, Uxbridge Road and a point in line with the southwestern boundary of No. 2 Parkfield Avenue

UXBRIDGE ROAD, HILLINGDON

The service road on the north-east side, fronting New Broadway

The northeast side, between a point 0.3 metres northwest of the south eastern flank wall of No. 12 New Broadway and point 12.8 metres northwest of the common boundary of Nos. 10 & 11 New Broadway

STATEMENT OF REASONS

The proposed 'At any time' waiting restrictions are intended to remove obstructive parking to improve road safety and promote the free flow of traffic.

The proposed removal of a section of existing 'Mon-Sat, 8:00am-6:30pm' waiting restrictions is intended to provide as much on-street parking as possible for residents.

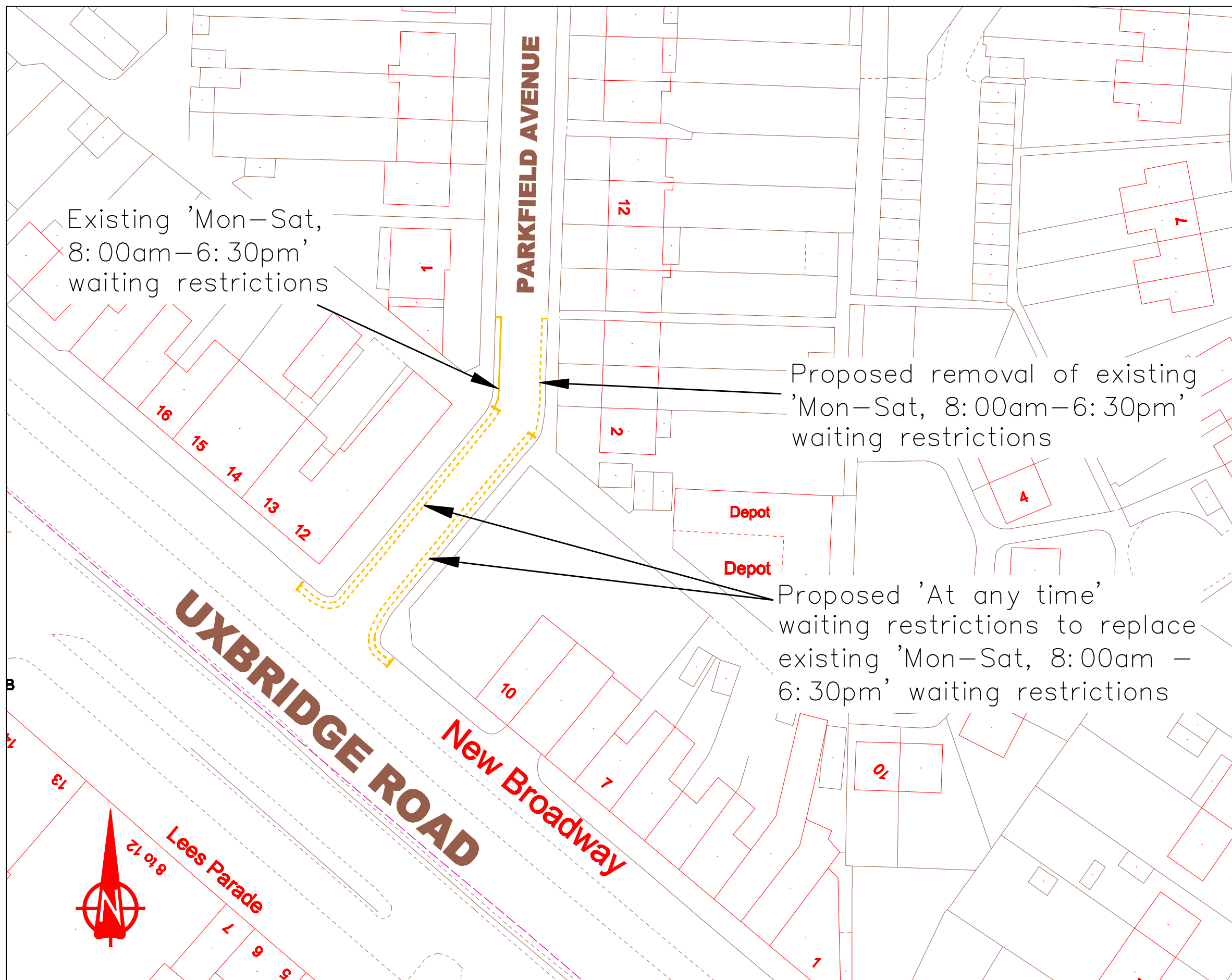

Existing 'Mon-Sat, 8:00am-6:30pm' waiting restrictions

Proposed removal of existing 'Mon-Sat, 8:00am-6:30pm' waiting restrictions

Proposed 'At any time' waiting restrictions to replace existing 'Mon-Sat, 8:00am - 6:30pm' waiting restrictions

Notes:

This map is based upon Ordnance Survey material with the permission of Ordnance Survey on behalf of the Controller of Her Majesty's Stationery Office © Crown copyright. Unauthorised reproduction infringes Crown copyright and may lead to prosecution or civil proceedings.
London Borough of Hillingdon 100019283 2011



HILLINGDON
LONDON

Project
Parkfield Avenue, Hillingdon

Proposed 'At any time' waiting restrictions

Description

Scale NTS	Drawn CF	(Initials/Date) 10/11	Checked (Initials/Date)
--------------	-------------	--------------------------	-------------------------

Project No.	Drawing No.	Rev.
-------------	-------------	------

APPENDIX A

LONDON BOROUGH OF HILLINGDON
THE HILLINGDON (WAITING AND LOADING RESTRICTION)
(CONSOLIDATION) (AMENDMENT NO.) ORDER 2012
HUNTERS GROVE, MINET DRIVE, MINET GARDENS, HAYES

Hillingdon Council gives notice that it intends to make this Order which will impose waiting restrictions on the lengths of road as set out in the Schedule to this notice. A copy of the proposed Order together with a plan and the Council's statement of reasons for the proposal can be seen at Botwell Green Library until 11 January 2012 and at the Civic Centre, Uxbridge by appointment during normal office hours until 6 weeks after either, the order is made or the Council decides not to proceed. Further information can be obtained by telephoning Planning, Environment, Education and Community Services on 01895 277014. If you wish to comment on, or object to the proposals please write by 11 January 2012, stating grounds for objection and your home address to Transport and Projects, Planning, Environment, Education and Community Services Civic Centre, Uxbridge, Middlesex UB8 1UW quoting reference 4W/06/MR/10500

Dated this the 14 day of December 2011

JEAN PALMER

Corporate Director of Planning, Environment, Education and Community Services.

SCHEDULE
WAITING PROHIBITED AT ANY TIME

HUNTERS GROVE, HAYES

- a) The north-west to southeast arm, The south-west side
 - i) between a point in line with the common boundary of Nos. 106 and 108 Hunters Grove and a point in line with the common boundary of Nos. 104 and 104b Hunters Grove;
 - ii) between a point in line with the common boundary of Nos. 92 and 94 Hunters Grove and a point in line with the common boundary of Nos. 88 and 90 Hunters Grove;
 - iii) between a point in line with the common boundary of Nos. 70 and 72 Hunters Grove and a point in line with the common boundary of Nos. 66 and 68 Hunters Grove;
 - iv) between a point in line with the common boundary of Nos. 54 and 56 Hunters Grove and a point in line with the common boundary of Nos. 50 and 52 Hunters Grove.
- b) The south-west to north-east arm,
 - i) both sides, from the south-western of Minet Drive south-west for a distance of 10.1 metres;
 - ii) The south-east side, between a point in line with the common boundary of Nos. 14 and 16 Hunters Grove and a point in line with the common boundary of Nos. 10 and 12 Hunters Grove.

MINET DRIVE, HAYES

- a) both sides, between a point 10.9 metres north-west of the north-western kerblines of Minet Gardens and a point 8.1 metres south-east of the south-eastern kerblines of Minet Gardens.
- b) the south-west side.
 - i) between a point in line with the common boundary of Nos. 26 and 28 Minet Drive and a point in line with the common boundary of Nos. 30 and 32 Minet Drive;

- ii) between a point in line with the common boundary of Nos. 52 and 54 Minet Drive and a point in line with the common boundary of Nos. 56 and 58 Minet Drive;
- lii) between a point in line with the common boundary of Nos. 70 and 72 Minet Drive and a point in line with the common boundary of Nos. 74 and 76 Minet Drive.
- c) the northeast side, between a point in line with the common boundary of Nos. 103 and 105 Minet Drive and a point in line with the common boundary of Nos. 107 and 109 Minet Drive.

MINET GARDENS, HAYES

Both sides, from the north eastern kerbline of Minet Drive for a distance of 11.5 metres north eastwards.

STATEMENT OF REASONS

The proposed waiting restrictions are intended to ensure pedestrian and vehicular safety and convenience.



NOTES

■ OFF-STREET PARKING WITHIN CURTILAGE OF DWELLING

— DOUBLE YELLOW LINES DENOTING NO WAITING OR STOPPING AT ANY TIME TO CREATE 'PASSING BAYS'

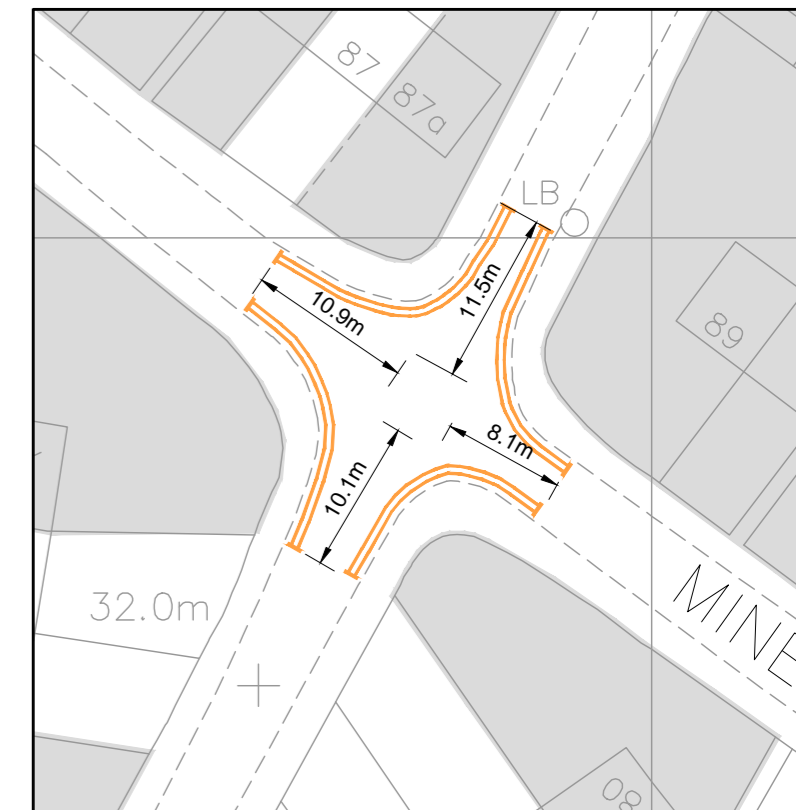

ENLARGED VIEW OF MINET DRIVE / MINET GARDENS JUNCTION.
Scale 1:500

Rev.	Date	Details	By	Chkd
A	23.09.11	Junction dimensions added	SLW	SRC

Client:-
Howarth
HOMES

Site:-
**LAND TO REAR
119 MINET DRIVE
HAYES MIDDLESEX**

Drawing Title:-
**PROPOSED
PARKING
RESTRICTIONS**

Date: MAY 2011 Scales: 1:1250
Drawn: SRV Checked: SRC

Drawing No. **HOW/E3839/124 A**

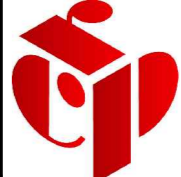

Rogers Cory Partnership
Civil, Structural and Architectural Consultants

the old school old school road
hook hampshire rg27 9nj
t 01256 769269 e mail@rcpcconsultants.co.uk
f 01256 763048 w rcpcconsultants.co.uk

