

LONDON BOROUGH OF HILLINGDON

THE HILLINGDON (SOUTH RUISLIP)(RESIDENTS ZONE SR) (ON STREET PARKING PLACES) ORDER 2011 (AMENDMENT NO.) 2011.. THE HILLINGDON (WAITING AND LOADING RESTRICTION) (CONSOLIDATION) (AMENDMENT NO.) ORDER 2011 EXTENSION TO SOUTH RUISLIP PARKING MANAGEMENT SCHEME

Hillingdon Council gives notice that it intends to make these Orders, which will amend the proposals advertised on 11 May 2011 to:

- a) create an additional permit holder only parking place in Queen Walk, Ruislip opposite Nos. 8-12 Queens Walk, operational between 9am and 5pm Monday to Friday;
- b) remove a permit holder only parking place in Long Drive fronting Nos. 190 and 192 Long Drive and replace this with waiting restrictions operational between 9am and 5pm Monday to Friday

RESIDENTS PERMITS - £0 - 1st vehicle, all subsequent - £40 per annum

VISITORS VOUCHERS First book of 10 per household per annum- free.

£5 - per book of 10 thereafter.

Copies of the proposed Orders together with full details, a plan and the Council's statement of reasons for the proposals can be seen at South Ruislip Adult Learners Centre, Victoria Road(opposite Sainsburys) until 21 December 2011 and by appointment at, Civic Centre, Uxbridge during normal office hours until 6 weeks after either, the order is made or the Council decides not to proceed. Further information can be obtained by telephoning Planning, Environment, Education and Community Services on 01895 277006.

If you wish to comment on, or object to the proposals please write by 21 December 2011, stating grounds for objection and your home address to Transport and Projects, Planning, Environment, Education and Community Services, Civic Centre, Uxbridge, Middlesex UB8 1UW quoting reference 4W/06/7.28/KU

Dated this 30 day of November 2011

JEAN PALMER,

Corporate Director of Planning, Environment, Education and Community Services.

STATEMENT OF REASONS

The proposals reflects responses received to statutory consultation on a proposed extension to the South Ruislip Parking Management Scheme, which will help restore the balance of parking in favour of residents, visitors and local residents.

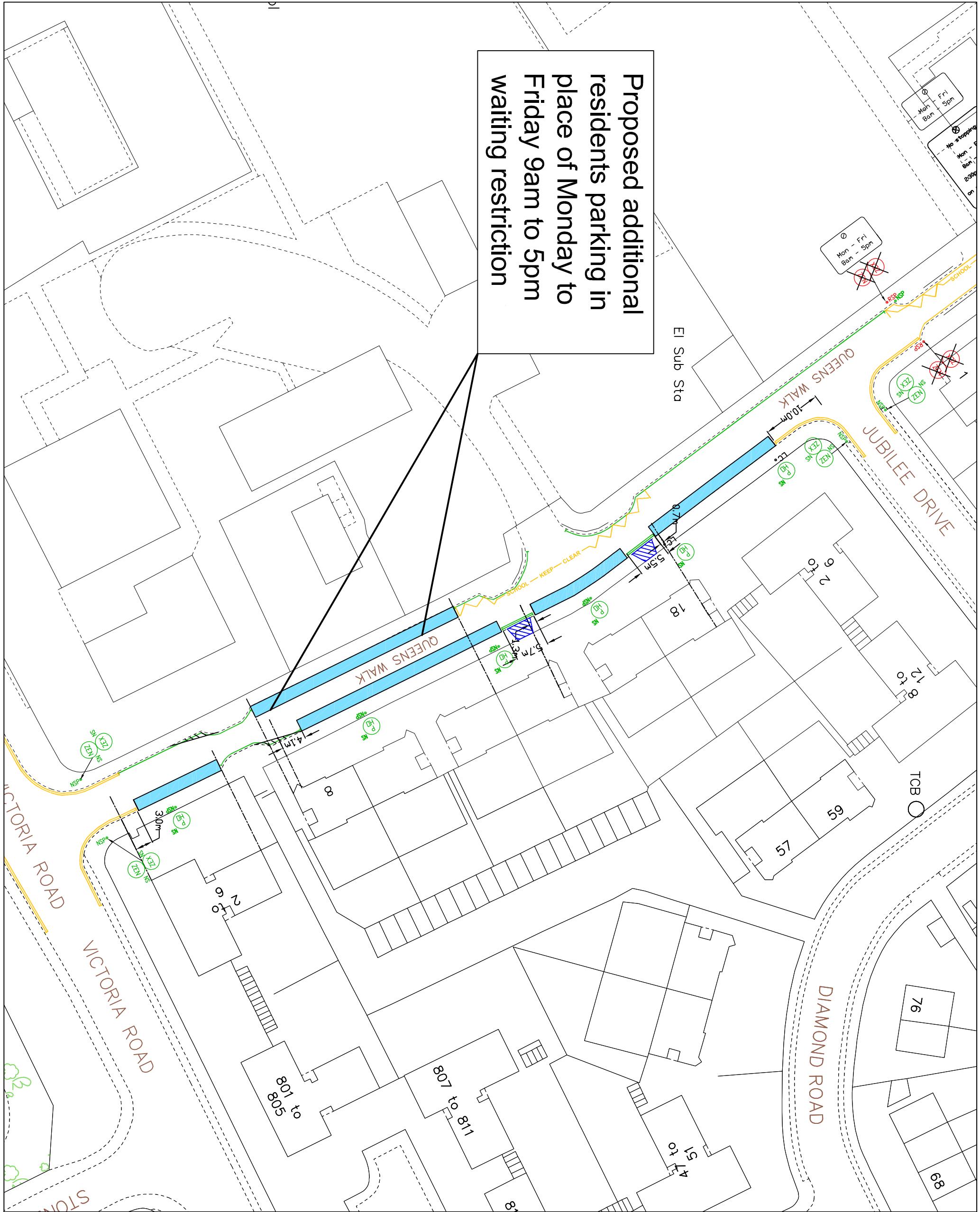

Proposed additional residents parking in place of Monday to Friday 9am to 5pm waiting restriction

- KEY**
- EXISTING YELLOW LINE
 - NEW SINGLE YELLOW LINE & TERMINAL
 - NEW DOUBLE YELLOW LINE & TERMINAL
 - PAY AND DISPLAY BAY AND PERMIT HOLDERS
 - PERMIT HOLDER ONLY BAY
 - CROSSOVER
 - PERMIT HOLDER ONLY SIGN
 - PERMIT OR TICKET HOLDER
 - DISABLED PARKING BAY SIGN
 - ZONE ENTRY SIGN
 - ZONE EXIT SIGN
- PARKING BAYS ARE 2m WIDE UNLESS NOTED
- EXTENT OF PRIVATE ROADS
- NS NEW SIGN
 - NSP NEW SIGN POST
 - SP NEW SIGN POST
 - LAMP COLUMN
 - REMOVE SIGN
 - REMOVE SIGN POST



This map is based upon Ordnance Survey data and is reproduced by permission of the Controller of Her Majesty's Stationery Office. Crown copyright. Unauthorised reproduction infringes Crown copyright and may lead to prosecution or civil proceedings.

London Borough of Hillingdon 100019283 ©2011



TRANSPORT PROJECTS
PLANNING, DESIGN, EVALUATION
AND COMMUNITY SERVICES DIRECTORATE
Civic Centre, 41/06, High Street, Uxbridge, Ux8 1UW
Tel No. 01895 277006/01895 250676

Project
Proposed extension to the South
Ruislip Parking Management
Scheme

Description
**Queens Walk
Nos. 2-18 even**

Scale 1:600(A3)	Designed KU	Drawn KU	Date 6/4/11
		Drawing No. KUI7.28	Rev. E

LONDON BOROUGH OF HILLINGDON
THE HILLINGDON) (COWLEY)(RESIDENTS ZONE C1) (ON STREET PARKING PLACES)
ORDER 2007 (AMENDMENT NO.) 2011. THE HILLINGDON (WAITING AND LOADING
RESTRICTION) (CONSOLIDATION) (AMENDMENT NO.) ORDER 2011
AMENDMENTS TO THE PROPOSED EXTENSION TO THE COWLEY PARKING
MANAGEMENT SCHEME

Hillingdon Council gives notice that it intends to make these Orders, which will amend the proposals advertised on 13 April 2011, to;

1. **Extend the proposed permit parking place** (operational between 9.00am and 5.00pm Monday to Friday) on High Street, Cowley to the extent of the lay-by fronting Honeycroft View, Pet-mik, Westcombe and Marles.
2. **Establish additional permit parking places** (operational between 9.00am and 5.00pm Monday to Friday) in The Meads, Cowley.
3. **Impose “at any time” waiting restrictions** in sections of High Street, Cowley as listed in Schedule 1 below.

RESIDENTS PERMITS - £0 - 1st vehicle, all subsequent - £40 per annum

VISITORS VOUCHERS First book of 10 per household per annum- free.

£5 - per book of 10 thereafter.

Copies of the proposed Orders together with full details, a plan and the Council's statement of reasons for the proposals can be seen at Yiewsley Library and by appointment at, Civic Centre, Uxbridge during normal office hours until 6 weeks after either, the order is made or the Council decides not to proceed. Further information can be obtained by telephoning Planning, Environment, Education and Community Services on 01895 277006.

If you wish to comment on, or object to the proposals please write by 21 December 2011, stating grounds for objection and your home address to Transport and Projects, Planning, Environment, Education and Community Services, Civic Centre, Uxbridge, Middlesex UB8 1UW quoting reference 4W/06/7.30/KU

Dated this 30 day of November 2011

JEAN PALMER,

Corporate Director of Planning, Environment, Education and Community Services.

SCHEDULE 1

HIGH STREET, COWLEY, The east side

a) between a point 10 metres north of the northern kerbline of Buchan Close and a point 11 metres north of the southern flank wall of Honeycroft View, High Street.

b) between a point 10.3 metres south of the northern flank wall of Marles, High Street and a point 6.9 metres north of the northern flank wall of The Crown Public House, High Street.

STATEMENT OF REASONS

The proposals reflect responses received to statutory consultation on a proposed extension to the Cowley Parking Management Scheme which will help restore the balance of parking in favour of residents.

Appendix D

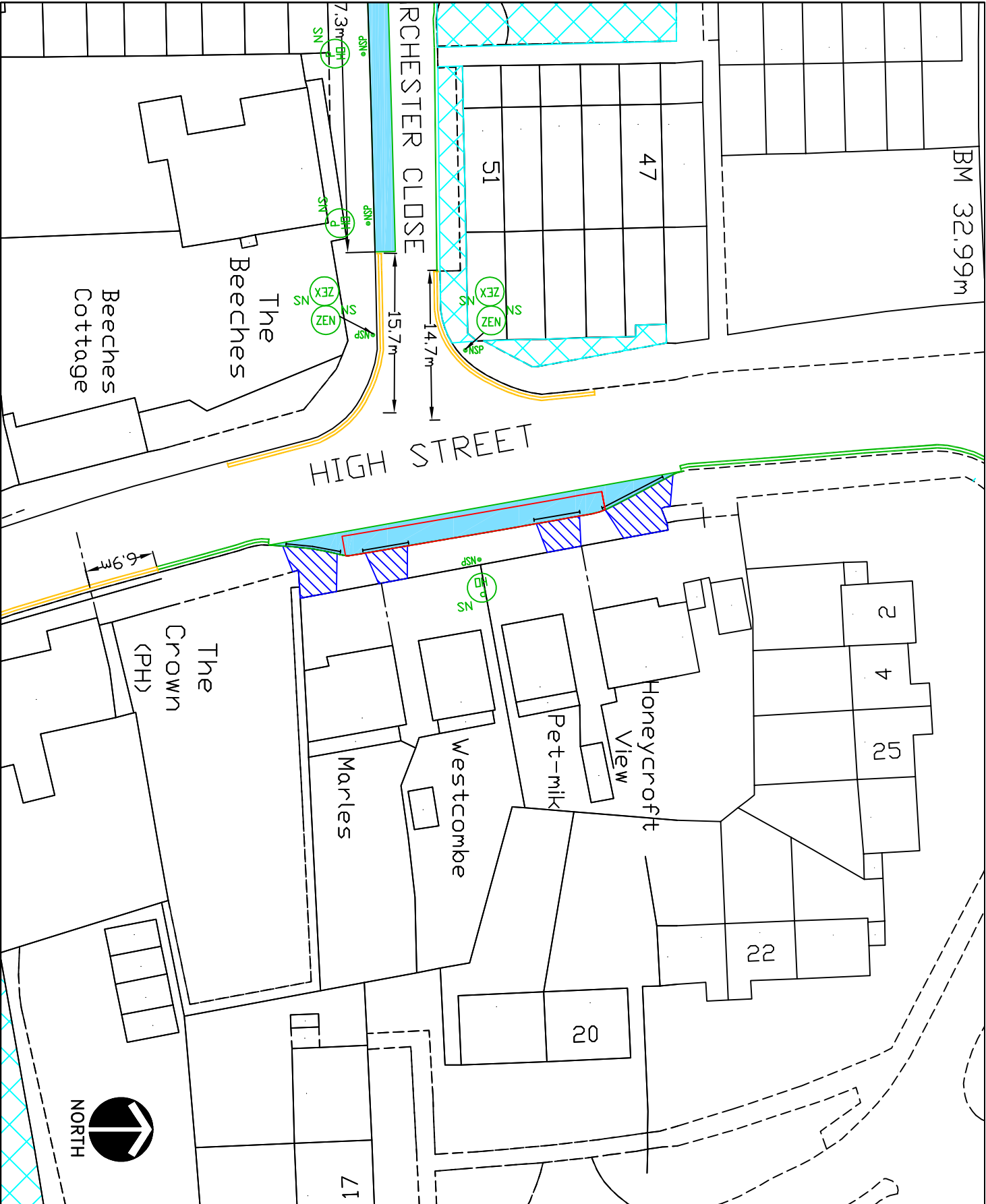

- KEY**
- EXISTING YELLOW LINE
 - NEW DOUBLE YELLOW LINE & TERMINAL
 - NEW SINGLE YELLOW LINE & TERMINAL
 - CROSSOVER
 - PERMIT HOLDER ONLY SIGN
 - LAMP COLUMN
 - NEW SIGNPOST
 - PREVIOUSLY PROPOSED BAY
 - PERMIT HOLDER ONLY BAY/PLACE
 - PARKING BAYS ARE 2m WIDE UNLESS NOTED

This map is based upon Ordnance Survey material with the permission of Ordnance Survey on behalf of the Controller of Her Majesty's Stationery Office. Crown copyright. Unauthorised reproduction infringes Crown copyright and may lead to prosecution or civil proceedings.

London Borough of Hillingdon 100019283 ©2011

HILLINGDON
LONDON

IMPROVEMENT PROJECTS
PLANNING, ENVIRONMENT, EDUCATION
AND COMMUNITY SERVICES DIRECTORATE
Civic Centre 4W/05, HIGH STREET, URBIDGE, URB8 1LW
Tel No. 01895 277009/01895 250576

Proposed amendments to the possible extension of the Cowley Parking Management Scheme

High Street, Cowley Zone C1

Scale: 1:500 (A4) Drawn: (Initials/Date) KU 6/07/11

Appendix C

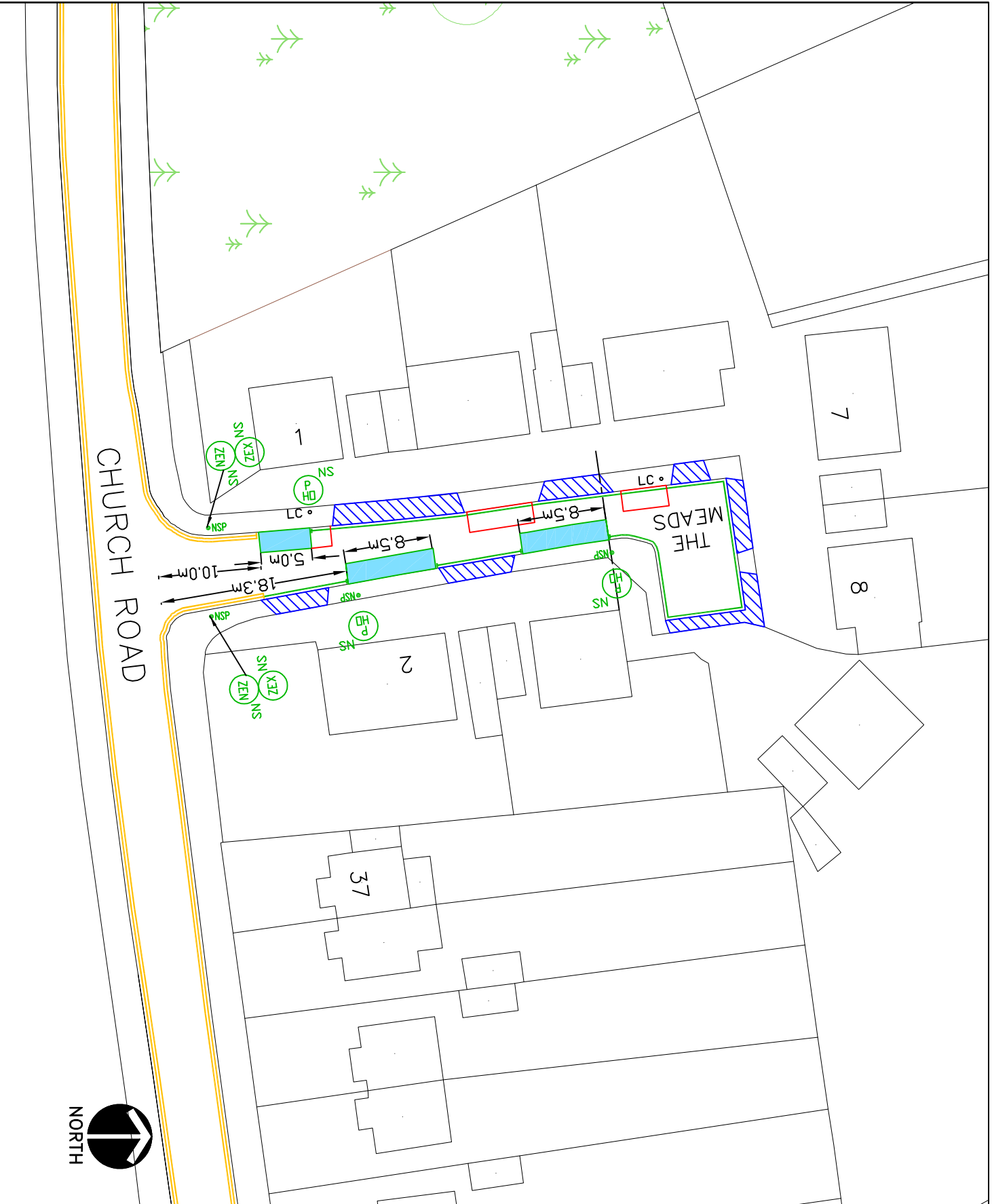

- KEY**
- EXISTING YELLOW LINE
 - NEW DOUBLE YELLOW LINE & TERMINAL
 - NEW SINGLE YELLOW LINE & TERMINAL
 - CROSSOVER
 - PERMIT HOLDER ONLY SIGN
 - PERMIT HOLDER ONLY SIGN
 - LAMP COLUMN
 - NEW SIGNPOST
 - PREVIOUSLY PROPOSED BAY
 - PERMIT HOLDER ONLY BAY/PLACE
- PARKING BAYS ARE 2m WIDE UNLESS NOTED

This map is based upon Ordnance Survey material with the permission of Ordnance Survey on behalf of the Controller of Her Majesty's Stationery Office. Crown copyright. Unauthorised reproduction infringes Crown copyright and may lead to prosecution or civil proceedings.
 London Borough of Hillingdon 100019283 ©2011

HILLINGDON
 LONDON

IMPROVEMENT PROJECTS
 PLANNING, ENVIRONMENT, EDUCATION
 AND COMMUNITY SERVICES DIRECTORATE
 CIVIC CENTRE 4W/05, HIGH STREET, UXBIDGE, URB8 1LW
 Tel No. 01895 277009/01895 250576

Proposed amendments to the possible extension of the Cowley Parking Management Scheme

The Meads - Zone C1

Scale: 1:500 (A4) Drawn: (Initials/Date) KU 6/07/11